

# Initial Report on a Survey of Residential Land and Housing Development Fees in Texas

## Select Municipalities in the Austin Metro and Across Texas

**Adam Perdue**  
Research Economist

**Weiling Yan**  
Research Intern



TEXAS A&M UNIVERSITY  
Texas Real Estate Research Center

TECHNICAL REPORT	TR
2 3 4 8	
JUNE 2022	

# **Initial Report on a Survey of Residential Land and Housing Development Fees in Texas: Select Municipalities in the Austin Metro and Across Texas**

**Adam Perdue, Research Economist**  
**Weiling Yan, Research Intern**

## **Executive Summary**

Housing affordability is of growing concern across Texas and beyond. Many things have the potential to drive up housing costs, including increasing materials costs, increasing labor costs, more stringent building standards, increasingly binding zoning constraints, and more. The increasing number of fees by local municipalities is commonly cited as one driver burdening residential land and housing development. However, the data on fees are dispersed and piecemeal, making this complaint difficult to verify.

Other reports cover the range of one particular fee across jurisdictions or the total fees charged for one particular development in one particular jurisdiction. This report seeks to explore all fees charged by Texas municipalities through the housing development process, and how those fees vary across development characteristics. This report covers select municipalities in the Austin metropolitan area as well as the five largest municipalities in the state.

Fees the selected municipalities charge to new single-family residential developments were surveyed and applied to two development models to discover the total fee charged per housing unit and how they vary across municipalities and development types (Table 1). These fees vary across municipalities, with the maximum total fees for the two development models coming in at almost two and almost three times greater than the average fee. Furthermore, the per-unit housing fees increase as the development becomes smaller. This is expected to some extent due to the fixed-cost nature of some of the reviews municipalities undertake. The per-unit housing costs increase 4 percent to 120 percent across the municipalities when moving from the larger suburban-style development to the smaller infill-style development.

**Table 1. Estimated Per-Housing Unit Fee Charged by Select Municipalities for Two Developments**

	40-acre suburban-style development yielding 200 single-family homes	One-acre infill-style development yielding four single-family homes
Houston min	\$4,841	\$5,014
Houston max	\$4,867	\$5,093
Dallas	\$11,320	\$13,099
Fort Worth min	\$8,800	\$12,424
Fort Worth max	\$11,556	\$15,180
Liberty Hill	\$20,388	\$22,009
Manor	\$9,149	\$11,011
Pflugerville min	\$8,580	\$9,060
Pflugerville max	\$11,723	\$12,278
Round Rock	\$10,891	\$11,256
San Marcos	\$8,212	\$10,188
Austin	\$18,168	\$41,303
San Antonio min	\$9,202	\$10,234
San Antonio max	\$11,830	\$12,862
Kyle	\$11,320	\$13,190
Georgetown	\$11,170	\$16,507
Buda	\$10,214	\$12,453
Leander	\$10,488	\$13,886
average	\$10,845	\$13,725
median	\$10,891	\$12,438
min	\$4,841	\$5,014
max	\$20,388	\$41,303

Source: Texas Real Estate Research Center at Texas A&M University

The 2021 average and median house price in greater Austin was \$565,740 and \$450,000, respectively, while the median income of renter households in the area would allow them to afford a loan of up to \$204,556 under some standard assumptions of affordability. Fees charged by the selected municipalities range from 2.02 percent to 17.42 percent of the loan that the median Austin area renter may have been able to afford in 2019, as illustrated in Table 2.

**Table 2. Proportion of Estimated Fees Relative to Select Housing Values**

		Minimum fee for suburban-style development	Minimum fee for infill-style development	Average fee for suburban-style development	Average fee for infill-style development	Maximum fee for suburban-style development	Maximum fee for infill-style development
		\$4,841	\$5,014	\$10,845	\$12,438	\$20,388	\$41,303
2021 average home price	\$565,740	0.86%	0.89%	1.92%	2.20%	3.60%	7.30%
2021 median home price	\$450,000	1.08%	1.11%	2.41%	2.76%	4.53%	9.18%
Loan affordable to 2019 median renter household	\$204,556	2.37%	2.45%	5.30%	6.08%	9.97%	20.19%

Source: Texas Real Estate Research Center at Texas A&M University

This report provides the results of a survey of the explicit fees charged by local municipalities through the housing development process. It does not attempt to answer the question of what individual or total fee is appropriate. Furthermore, the explicit fees may not be the complete accounting of the total governmental costs in every city. Some city departments involved are enterprise-funded and recoup the total costs. The City of Austin’s development and planning department is one of these. Other cities use additional revenue sources to fund the compliance review of new residential development. An additional consideration may be that the regulations and their review process have benefits such as ensuring safer housing, public resource protection, and flood control. These are not considered here. This initial report provides a starting point for further investigation into these more comprehensive questions as well as providing the data.

## Introduction

There is a remarkable lack of comprehensive information on local government's role in Texas' housing development process. This limits the ability of researchers, the public, and municipalities to understand the full role individual municipalities play in the process or compare the policies and choices that voters make. Furthermore, without data within a single municipality or across municipalities, it is impossible to analyze the impacts that the potential policies may have.

Housing is another pertinent issue across Texas and beyond. Many things have the potential to drive up housing costs, including increasing materials costs, increasing labor costs, more stringent building standards, increasingly binding zoning constraints, and more. An increasing number or level of fees by local municipalities is commonly cited as one driver burdening residential land and housing development. However, the data on fees are dispersed and piecemeal, making this complaint difficult to verify.

Other reports have covered the range of one particular fee across jurisdictions or the total fees charged for one particular development in one particular jurisdiction. This report explores all fees charged by Texas municipalities and how those fees vary across development characteristics. It surveys the information available online from select municipalities in the Austin metropolitan area as well as the five largest municipalities in the state.

Common economic justifications for the role municipalities play in the residential land and housing development process include preventing or charging for negative externalities and dealing with concerns about asymmetric information. Cost recovery is a common justification for high fees and for charging those who would benefit from or be the cause of the negative externality that the municipality seeks to prevent or limit.

Building inspections and permitting are textbook responses to the potential for asymmetric information problems. In the absence of inspections, a builder or electrician could cut corners, and it

would be difficult for a buyer to verify once the sheetrock goes up. Through the permitting system, the buyer can be more confident that construction quality at least meets the municipality's standard. Comprehensive planning and zoning systems typically are justified as preventing certain uses from locating near each other if those incompatible uses could hinder the enjoyment of the neighboring parcels. Regardless of whether a particular regulation is economically or in any other way justified, its enforcement comes at a cost. This report covers regulations in which costs are passed onto the developer, builder, and consumer of residential housing and land in the form of explicit fees. The appropriate fee level is neither determined nor suggested. That question would require much further study. This is only the first step.

Two model residential developments are proposed to explore the variation in fees across municipalities and how those fees can change depending on the scale of development. Model 1 has the characteristics of a large-scale development often seen along the boundaries of current distribution of population at the suburban fringe. It will have +/- 40 acres yielding +/- 200 lots and homes (Figure 1). Model 2 is on a smaller scale. It will subdivide a lot of +/- one acre into +/- four lots and homes (Figure 2). With just one starting acre, this model is meant to be typical of an infill development one might find closer to town on land that has already undergone one or more development phases as a city has grown.

Municipalities' fee bases are not related solely to the land area of the total development or to the final lot yield. Models 1 and 2 require further assumptions through the development process. For example, the square footage of the structures to be built is a common basis for the fees related to building permits. Under both models, the final structures are assumed to be 1,500 square feet. Further assumptions need to be made about the characteristics of the structures, but also about the size of water connections, infrastructure length, square footage of impervious cover, etc. Table 3 lists the basis on which fees are charged and the assumptions made for this exercise. The assumptions are meant to

be reasonable but are not based on specific calculations or plans. Finally, both models assume the land to be developed is along an existing arterial roadway with all utilities present at the edge of the site. Only those fees directly involved in development, infrastructure, and other activity on site are explored here.

Development of new housing goes through a few typical, broadly defined stages between ideation and new households moving into the units. Fees were first classified among eight broad stages of a typical residential land development process through which municipalities typically charge development fees: comprehensive planning update applications, zoning changes, subdivision and platting of land, site plan applications, building permitting, tap fees, and impact fees. In addition, municipalities often charge fees in lieu of parkland dedication, which were assumed to be paid as opposed to the requirements for in-kind dedications for on-site parkland, when available.

For each municipality, information on fees charged, the base and per-unit value of the fee, and the basis of each fee were collected and compiled into a fee sheet (see appendix).<sup>1</sup> Each fee sheet contains all the municipality's identified fees potentially applicable to single-family residential development. Columns 1 through 3 show the development stage of the fee, name of the fee, and basis on which the fee is charged. Columns 4 and 5 keep track of the multipliers that must be charged depending on the fee basis for Model Development 1. Columns 8 and 9 keep track of the same for Model Development 2. Columns 6 and 10 are the per-basis-unit charge for each fee. Columns 7 and 11 are the total charge for Development Models 1 and 2, respectively, for each fee.

---

<sup>1</sup> While the researchers put forth a good faith effort to gather all pertinent data and accurately report the findings, the data reported here for the individual municipalities' fees should not be relied upon in estimating costs for any particular development in any particular municipality. The data was initially collected through publicly available data on municipal websites by the researchers between June of 2021 and December of 2021. Fees are typically updated every year. Please reach out to your local municipality with any development plans. Pre-submittal meetings are commonly offered to go over the precise rules and fees that your development may have to follow.

## Results

Using data summarized from the individual fee sheets, Table 4 shows each municipality's estimated fees by development stage and/or fee type as well as the total fees for Model 1. Table 5 presents the same but divides the total and subgroup fees by the number of final housing units to put it on a per-housing-unit basis. The average per-housing-unit total fee charged by the municipalities covered here is \$10,707, with a range between \$4,841 and \$20,388. Each fee subcategory tracked also shows significant variation in the fee charged per housing unit. The average multiple between the maximum fee and the average fee by subcategory is five, while the multiple between the average and maximum total fee is closer to two. There is greater variance within fee categories than in total fees. Table 6 illustrates the ratio of each fee category in each municipality to the average fee by category. This illustrates the peril of comparing municipal costs across only one category. For example, Round Rock charges 21 percent of the average zoning fees while charging 147 percent of the average impact fee and almost perfectly average total fees, at 95 percent. Almost none of the cities are consistently below or above average across all categories.

Tables 7 and 8 show more variable results for development Model 2. The average per-housing-unit total fee ranges between \$5,014 and \$41,303 with an average of \$12,438. The average multiple between the average fee and the maximum fee for each subcategory for Model 2 developments is also approximately five here. A similar pattern, as in Model 1, also holds when comparing the ratios between fees by category by city and the average by category as illustrated in Table 9.

Model 2 housing units are also consistently charged more per housing unit than those in a Model 1-type development. This is easily explained by fixed costs baked into the process of development and construction review and reflected in the fees municipalities charge. Some aspects of zoning, design and plan review, etc., do not depend on the size of the development, and they take the same labor hours whether the development is one acre or 40, or four lots or 200. Municipalities charged



the Model 2 development an average of 24 percent more in per-housing-unit fees than they did Model 1. Austin has the most extreme ratio between their Model 1 and Model 2 per-housing-unit fees at 2.27 times. Mathematically, this is due to the larger reliance on base fees rather than marginal fees related to the size of the development.

### **Relation to Home Prices**

The average price of a single-family home in the Austin metropolitan area in 2021 was \$565,740, while the median price was \$450,000.<sup>2</sup> Households renting in the Austin area in 2019 had a median income<sup>3</sup> of \$54,871, which under some affordability metrics<sup>4</sup> may allow them to afford a loan of up to \$204,556. The average per-housing-unit fee for large developments (\$10,845) was 1.92 percent and 2.41 percent of the 2021 average and median Austin metropolitan area home price, respectively. It was 5.30 percent of the price affordable to the median Austin renter household in 2019 (Table 10). The maximum fee for the large development model (\$20,388) represents 3.6 percent and 4.53 percent of the average and median home price in 2021, respectively, and 9.97 percent of the purchase price of a home that was affordable to the median 2019 Austin area renter household.

All surveyed municipalities charge slightly higher rates per housing unit on smaller developments. The maximum per-housing-unit fee identified in this study (\$41,303) ranges from 7.30 percent of the average price of an Austin home in 2021 to 20.19 percent of the price that may be affordable to a 2019 Austin renter household.

---

<sup>2</sup> [https://www.recenter.tamu.edu/data/housing-activity/#!/activity/MSA/Austin-Round\\_Rock](https://www.recenter.tamu.edu/data/housing-activity/#!/activity/MSA/Austin-Round_Rock)

<sup>3</sup> 2019: ACS 1-Year Estimates, MEDIAN HOUSEHOLD INCOME THE PAST 12 MONTHS (IN 2019 INFLATION-ADJUSTED DOLLARS) BY TENURE

<sup>4</sup> 35% or less of monthly income spent on PITI with 360 payments at 3.5% interest, 3% property tax and 1% annual insurance.

## Conclusion

Despite collecting more comprehensive data across municipalities and development types, this report narrowly explores the explicit dollar value charged to residential land and housing development. The modelling here does not account for difficulties that may occur in following municipalities processes. In reality, each step may need to be repeated, and separate fees may be charged for each iteration. Furthermore, the time municipalities take for their review and application iterations, while necessary, will increase financing costs for new housing. The development models are roughly based on yields of 5,000-square-foot lots of single-family home development, which may or may not be an “acceptable” development pattern within a municipality’s zoning ordinance. Even where this development pattern is technically acceptable under some classification within the zoning ordinance, approval of the rezoning is not a given as assumed in this report.

There is also a difficulty that the explicit fees charged may not cover the whole cost of the regulatory compliance process. While some planning, development, and building departments are enterprise-funded, such as the City of Austin’s, not all are. In as much as one believed that the development process should be set up as a user-pay system, some may interpret this as a subsidy. But it leads to the report apparently overstating the total costs of the more fully self-funded departments relative to the costs of the departments receiving a larger portion of their funding from general revenue or other sources.

In economics and policy discussions, cost should always be balanced by benefits. This report does not attempt to explore the potential benefits of varying regulations or the varying levels of enforcement that may drive some of the variation in fees charged between municipalities. The potential benefits of the regulations involved here range from safer housing to public resource preservation to flood control and beyond. These benefits should be weighed against the costs of providing them when voters and policy makers decide on the appropriate mix for their community. This initial report provides

a starting point for these discussion by providing data on what the fees charged to new developments amount to.

**Figure 1. Development Model 1**

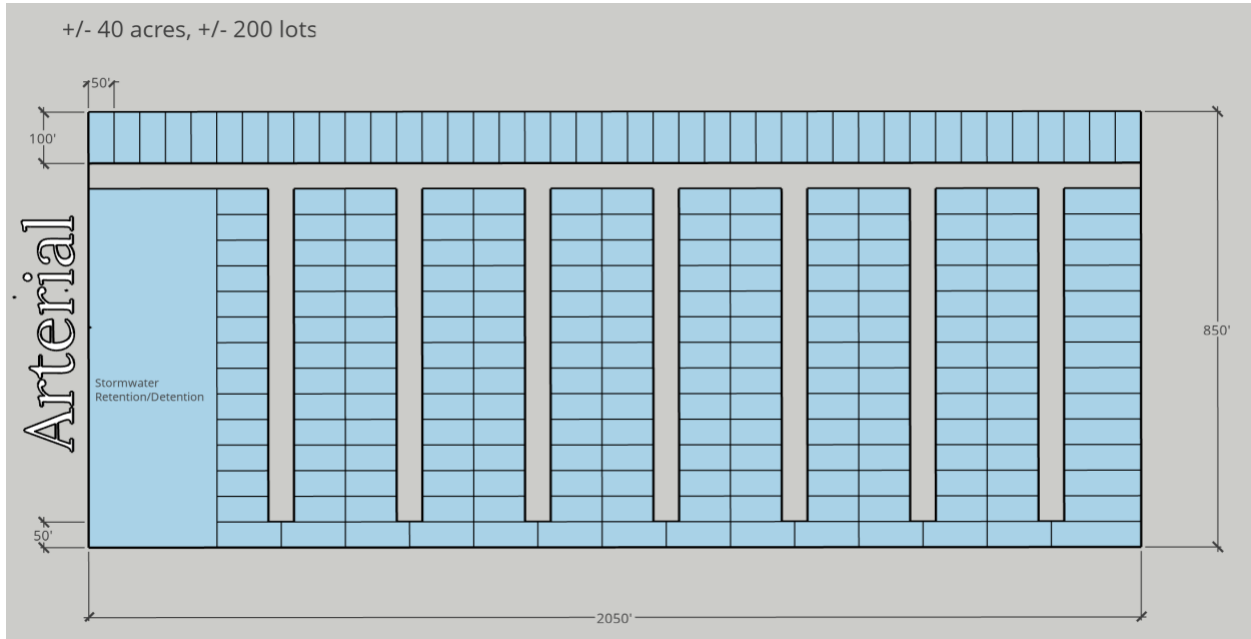

Source: Texas Real Estate Research Center at Texas A&M University

**Figure 2. Development Model 2**

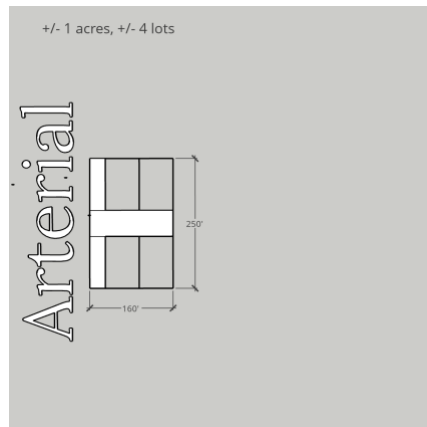

Source: Texas Real Estate Research Center at Texas A&M University

The author submitted the findings of this report to the various municipalities to check for accuracy and completeness and to provide general comments.

**Table 3. Model Development Assumptions for Fee Bases**

	Model 1	Model 2
Development	1	1
Acres	40	1
Final lots	200	4
Living unit equivalent	200	4
Neighboring owner	100	100
Notification signs required	4	4
Professional recovery fees		
Total infrastructure construction costs	6000000	120000
Square foot of impervious cover	191250	3825
Linear foot of public infrastructure/ROW	7000	140
Lineal foot of sidewalk	14000	280
Housing unit characteristics		
Square foot of home	1500	1500
Number of home inspections required per home	1	1
A/C unit per structure (3 to5 ton)	1	1
Plumbing fixtures (water)	12	12
Plumbing fixtures (gas)	3	3
Light fixtures, outlets, switches, and receptacles	30	30
Electrical Outlets	20	20
Electrical Fixture	10	10
Ceiling fan	4	4
Vent fan	1	1
Smoke detectors	7	7
Disposal	1	1
Dishwasher	1	1
Washing machine	1	1
Water Heater	1	1
Dryer	1	1
Range	1	1
Gas Heating unit	1	1
Driveway	1	1
5/8-inch water meter	1	1
3/4-inch water meter	0	0
4-inch sewer line	1	1
Water connection	1	1
Sewer connection	1	1

Source: Texas Real Estate Research Center at Texas A&M University

**Table 4. Total Fees Charged, Development Model 1**

	Houston min	Houston max	Dallas	Fort Worth min	Fort Worth max	Liberty Hill	Manor	Pflugerville min	Pflugerville max
Comprehensive Plan	\$0	\$0	\$0	\$0	\$0	\$0	\$0	\$1,000	\$1,000
Zoning	\$0	\$0	\$11,010	\$4,425	\$4,425	\$383	\$2,165	\$2,500	\$2,500
Subdivision	\$6,177	\$6,177	\$11,186	\$12,385	\$12,385	\$14,500	\$19,175	\$9,000	\$9,000
Dedication Fee in Lieu	\$140,000	\$140,000	\$233,000	\$52,650	\$52,650	\$160,000	\$110,000	\$172,498	\$172,498
Site Plan	\$0	\$0	\$120,050	\$600	\$600	\$12,713	\$1,050	\$210,500	\$210,500
Permit	\$109,478	\$109,478	\$118,800	\$170,776	\$170,776	\$270,000	\$323,000	\$146,000	\$146,000
Tap fee	\$64,572	\$64,400	\$1,770,000	\$760,000	\$760,000	\$1,520,000	\$300,000	\$195,000	\$195,000
impact fee	\$647,948	\$653,264	\$0	\$759,200	\$1,310,400	\$2,100,000	\$1,074,400	\$979,500	\$1,608,100
<b>Total Fees</b>	<b>\$968,175</b>	<b>\$973,319</b>	<b>\$2,264,046</b>	<b>\$1,760,036</b>	<b>\$2,311,236</b>	<b>\$4,077,596</b>	<b>\$1,829,790</b>	<b>\$1,715,998</b>	<b>\$2,344,598</b>

	Round Rock	San Marcos	Austin	San Antonio min	San Antonio max	Kyle	Georgetown	Buda	Leander
Comprehensive Plan	\$0	\$13,737	\$0	\$0	\$0	\$0	\$725	\$3,000	\$1,195
Zoning	\$1,020	\$5,057	\$19,136	\$7,614	\$7,614	\$573	\$1,040	\$4,950	\$2,495
Subdivision	\$12,990	\$11,435	\$39,889	\$625	\$625	\$6,608	\$17,575	\$18,200	\$89,170
Dedication Fee in Lieu	\$64,000	\$163,800	\$1,132,734	\$0	\$0	\$300,000	\$330,000	\$360,000	\$290,000
Site Plan	\$90,000	\$4,378	\$316,889	\$372,388	\$372,388	\$462,709	\$238,941	\$408,650	\$11,038
Permit	\$57,000	\$147,000	\$429,662	\$275,800	\$275,800	\$134,875	\$177,000	\$75,000	\$190,000
Tap fee	\$86,800	\$0	\$218,578	\$0	\$0	\$86,940	\$130,000	\$229,400	\$88,000
impact fee	\$1,866,356	\$1,297,000	\$1,440,000	\$1,184,000	\$1,709,600	\$1,272,200	\$1,338,762	\$943,600	\$1,425,800
<b>Total Fees</b>	<b>\$2,178,166</b>	<b>\$2,178,166</b>	<b>\$3,596,888</b>	<b>\$1,840,427</b>	<b>\$2,366,027</b>	<b>\$2,263,904</b>	<b>\$2,234,043</b>	<b>\$2,042,800</b>	<b>\$2,097,698</b>

	average	median	min	max
Comprehensive Plan	\$1,291	\$0	\$0	\$13,737
Zoning	\$4,807	\$3,463	\$383	\$19,136
Subdivision	\$17,797	\$12,385	\$625	\$89,170
Dedication Fee in Lieu	\$224,614	\$168,149	\$0	\$1,132,734
Site Plan	\$177,087	\$165,275	\$600	\$462,709
Permit	\$194,218	\$170,776	\$57,000	\$429,662
Tap fee	\$396,232	\$195,000	\$0	\$1,770,000
impact fee	\$1,269,307	\$1,303,700	\$0	\$2,100,000
<b>Total Fees</b>	<b>\$2,318,838</b>	<b>\$2,206,105</b>	<b>\$1,715,998</b>	<b>\$4,077,596</b>

Sources: Texas Real Estate Research Center at Texas A&M University; Planning, Development and Building departments of the respective cities

**Table 5. Per-Housing-Unit Fees Charged, Development Model 1**

	Houston min	Houston max	Dallas	Fort Worth min	Fort Worth max	Liberty Hill	Manor	Pflugerville min	Pflugerville max
Comprehensive Plan	\$0	\$0	\$0	\$0	\$0	\$0	\$0	\$5	\$5
Zoning	\$0	\$0	\$55	\$22	\$22	\$2	\$11	\$13	\$13
Subdivision	\$31	\$31	\$56	\$62	\$62	\$73	\$96	\$45	\$45
Dedication Fee in Lieu	\$700	\$700	\$1,165	\$263	\$263	\$800	\$550	\$862	\$862
Site Plan	\$0	\$0	\$600	\$3	\$3	\$64	\$5	\$1,053	\$1,053
Permit	\$547	\$547	\$594	\$854	\$854	\$1,350	\$1,615	\$730	\$730
Tap fee	\$323	\$322	\$8,850	\$3,800	\$3,800	\$7,600	\$1,500	\$975	\$975
impact fee	\$3,240	\$3,266	\$0	\$3,796	\$6,552	\$10,500	\$5,372	\$4,898	\$8,041
<b>Total Fees per unit</b>	<b>\$4,841</b>	<b>\$4,867</b>	<b>\$11,320</b>	<b>\$8,800</b>	<b>\$11,556</b>	<b>\$20,388</b>	<b>\$9,149</b>	<b>\$8,580</b>	<b>\$11,723</b>

	Round Rock	San Marcos	Austin	San Antonio min	San Antonio max	Kyle	Georgetown	Buda	Leander
Comprehensive Plan	\$0	\$69	\$0	\$0	\$0	\$0	\$4	\$15	\$6
Zoning	\$5	\$25	\$96	\$38	\$38	\$3	\$5	\$25	\$12
Subdivision	\$65	\$57	\$199	\$3	\$3	\$33	\$88	\$91	\$446
Dedication Fee in Lieu	\$320	\$819	\$5,664	\$0	\$0	\$1,500	\$1,650	\$1,800	\$1,450
Site Plan	\$450	\$22	\$1,768	\$1,862	\$1,862	\$2,314	\$1,195	\$2,043	\$55
Permit	\$285	\$735	\$2,148	\$1,379	\$1,379	\$674	\$885	\$375	\$950
Tap fee	\$434	\$0	\$1,093	\$0	\$0	\$435	\$650	\$1,147	\$440
impact fee	\$9,332	\$6,485	\$7,200	\$5,920	\$8,548	\$6,361	\$6,694	\$4,718	\$7,129
<b>Total Fees per unit</b>	<b>\$10,891</b>	<b>\$8,212</b>	<b>\$18,168</b>	<b>\$9,202</b>	<b>\$11,830</b>	<b>\$11,320</b>	<b>\$11,170</b>	<b>\$10,214</b>	<b>\$10,488</b>

	average	median	min	max
Comprehensive Plan	\$6	\$0	\$0	\$69
Zoning	\$21	\$13	\$0	\$96
Subdivision	\$83	\$60	\$3	\$446
Dedication Fee in Lieu	\$1,076	\$810	\$0	\$5,664
Site Plan	\$797	\$525	\$0	\$2,314
Permit	\$924	\$794	\$285	\$2,148
Tap fee	\$1,797	\$813	\$0	\$8,850
impact fee	\$6,003	\$6,423	\$0	\$10,500
<b>Total Fees per unit</b>	<b>\$10,707</b>	<b>\$10,690</b>	<b>\$4,841</b>	<b>\$20,388</b>

Sources: Texas Real Estate Research Center at Texas A&M University; Planning, Development and Building departments of the respective cities

**Table 6. Ratio of Fees Charged by Municipality by Fee Category to Average Fee by Fee Category, Development Model 1**

	Houston min	Houston max	Dallas	Fort Worth min	Fort Worth max	Liberty Hill	Manor	Pflugerville le min	Pflugerville max
Comprehensive Plan	0.00	0.00	0.00	0.00	0.00	0.00	0.00	0.77	0.77
Zoning	0.00	0.00	2.29	0.92	0.92	0.08	0.45	0.52	0.52
Subdivision	0.35	0.35	0.63	0.70	0.70	0.81	1.08	0.51	0.51
Dedication Fee in									
Lieu	0.62	0.62	1.04	0.23	0.23	0.71	0.49	0.77	0.77
Site Plan	0.00	0.00	0.68	0.00	0.00	0.07	0.01	1.19	1.19
Permit	0.56	0.56	0.61	0.88	0.88	1.39	1.66	0.75	0.75
Tap fee	0.16	0.16	4.47	1.92	1.92	3.84	0.76	0.49	0.49
impact fee	0.51	0.51	0.00	0.60	1.03	1.65	0.85	0.77	1.27
Total Fees	0.42	0.42	0.98	0.76	1.00	1.76	0.79	0.74	1.01
	Round Rock	San Marcos	Austin	San Antonio min	San Antonio max	Kyle	Georgetown	Buda	Leander
Comprehensive Plan	0.00	10.64	0.00	0.00	0.00	0.00	0.56	2.32	0.93
Zoning	0.21	1.05	3.98	1.58	1.58	0.12	0.22	1.03	0.52
Subdivision	0.73	0.64	2.24	0.04	0.04	0.37	0.99	1.02	5.01
Dedication Fee in									
Lieu	0.28	0.73	5.04	0.00	0.00	1.34	1.47	1.60	1.29
Site Plan	0.51	0.02	1.79	2.10	2.10	2.61	1.35	2.31	0.06
Permit	0.29	0.76	2.21	1.42	1.42	0.69	0.91	0.39	0.98
Tap fee	0.22	0.00	0.55	0.00	0.00	0.22	0.33	0.58	0.22
impact fee	1.47	1.02	1.13	0.93	1.35	1.00	1.05	0.74	1.12
Total Fees	0.94	0.94	1.55	0.79	1.02	0.98	0.96	0.88	0.90

Sources: Texas Real Estate Research Center at Texas A&M University; Planning, Development and Building departments of the respective cities

**Table 7. Total Fees Charged, Development Model 2**

	Houston min	Houston max	Dallas	Fort Worth min	Fort Worth max	Liberty Hill	Manor	Pflugerville min	Pflugerville max
Comprehensive Plan	\$0	\$0	\$0	\$0	\$0	\$0	\$0	\$1,000	\$1,000
Zoning	\$0	\$0	\$1,050	\$1,200	\$1,200	\$383	\$995	\$500	\$500
Subdivision	\$1,040	\$1,040	\$1,633	\$3,565	\$3,565	\$4,700	\$6,435	\$180	\$480
Dedication Fee in Lieu	\$2,800	\$2,800	\$4,660	\$10,530	\$10,530	\$4,000	\$2,200	\$3,450	\$3,450
Site Plan	\$0	\$0	\$7,275	\$600	\$600	\$1,153	\$465	\$4,700	\$4,700
Permit	\$1,966	\$1,966	\$2,376	\$3,416	\$3,416	\$5,400	\$6,460	\$2,920	\$2,920
Tap fee	\$1,291	\$1,288	\$35,400	\$15,200	\$15,200	\$30,400	\$6,000	\$3,900	\$3,900
impact fee	\$12,959	\$13,278	\$0	\$15,184	\$26,208	\$42,000	\$21,488	\$19,590	\$32,162
<b>Total Fees</b>	<b>\$20,057</b>	<b>\$20,373</b>	<b>\$52,394</b>	<b>\$49,695</b>	<b>\$60,719</b>	<b>\$88,036</b>	<b>\$44,043</b>	<b>\$36,240</b>	<b>\$49,112</b>

	Round Rock	San Marcos	Austin	San Antonio min	San Antonio max	Kyle	Georgetown	Buda	Leander
Comprehensive Plan	\$0	\$1,374	\$0	\$0	\$0	\$0	\$725	\$3,000	\$1,195
Zoning	\$1,020	\$1,157	\$9,916	\$1,770	\$1,770	\$432	\$515	\$1,050	\$1,325
Subdivision	\$400	\$3,635	\$32,426	\$625	\$625	\$3,776	\$8,755	\$3,500	\$5,674
Dedication Fee in Lieu	\$1,600	\$3,276	\$22,655	\$0	\$0	\$6,000	\$6,600	\$7,200	\$5,800
Site Plan	\$1,800	\$2,428	\$58,453	\$9,344	\$9,344	\$12,673	\$16,516	\$10,103	\$7,475
Permit	\$1,140	\$2,940	\$8,593	\$5,516	\$5,516	\$2,697	\$3,540	\$1,500	\$3,800
Tap fee	\$1,736	\$0	\$4,372	\$0	\$0	\$1,739	\$2,600	\$4,588	\$1,760
impact fee	\$37,327	\$25,940	\$28,800	\$23,680	\$34,192	\$25,444	\$26,775	\$18,872	\$28,516
<b>Total Fees</b>	<b>\$45,023</b>	<b>\$40,750</b>	<b>\$165,214</b>	<b>\$40,935</b>	<b>\$51,447</b>	<b>\$52,761</b>	<b>\$66,026</b>	<b>\$49,813</b>	<b>\$55,545</b>

	average	median	min	max
Comprehensive Plan	\$518	\$0	\$0	\$3,000
Zoning	\$1,549	\$1,050	\$383	\$9,916
Subdivision	\$4,998	\$3,565	\$180	\$32,426
Dedication Fee in Lieu	\$5,747	\$4,330	\$0	\$22,655
Site Plan	\$9,227	\$5,988	\$465	\$58,453
Permit	\$3,884	\$3,416	\$1,140	\$8,593
Tap fee	\$7,925	\$3,900	\$0	\$35,400
impact fee	\$25,386	\$26,074	\$0	\$42,000
<b>Total Fees</b>	<b>\$59,234</b>	<b>\$50,630</b>	<b>\$36,240</b>	<b>\$165,214</b>

Sources: Texas Real Estate Research Center at Texas A&M University; Planning, Development and Building departments of the respective cities



**Table 8. Per-Housing-Unit Fee, Development Model 2**

	Houston min	Houston max	Dallas	Fort Worth min	Fort Worth max	Liberty Hill	Manor	Pflugerville min	Pflugerville max
Comprehensive Plan	\$0	\$0	\$0	\$0	\$0	\$0	\$0	\$250	\$250
Zoning	\$0	\$0	\$263	\$300	\$300	\$96	\$249	\$125	\$125
Subdivision	\$260	\$260	\$408	\$891	\$891	\$1,175	\$1,609	\$45	\$120
Dedication Fee in Lieu	\$700	\$700	\$1,165	\$2,633	\$2,633	\$1,000	\$550	\$862	\$862
Site Plan	\$0	\$0	\$1,819	\$150	\$150	\$288	\$116	\$1,175	\$1,175
Permit	\$492	\$492	\$594	\$854	\$854	\$1,350	\$1,615	\$730	\$730
Tap fee	\$323	\$322	\$8,850	\$3,800	\$3,800	\$7,600	\$1,500	\$975	\$975
impact fee	\$3,240	\$3,319	\$0	\$3,796	\$6,552	\$10,500	\$5,372	\$4,898	\$8,041
<b>Total Fees per unit</b>	<b>\$5,014</b>	<b>\$5,093</b>	<b>\$13,099</b>	<b>\$12,424</b>	<b>\$15,180</b>	<b>\$22,009</b>	<b>\$11,011</b>	<b>\$9,060</b>	<b>\$12,278</b>
	Round Rock	San Marcos	Austin	San Antonio min	San Antonio max	Kyle	Georgetown	Buda	Leander
Comprehensive Plan	\$0	\$344	\$0	\$0	\$0	\$0	\$181	\$750	\$299
Zoning	\$255	\$289	\$2,479	\$443	\$443	\$108	\$129	\$263	\$331
Subdivision	\$100	\$909	\$8,106	\$156	\$156	\$944	\$2,189	\$875	\$1,419
Dedication Fee in Lieu	\$400	\$819	\$5,664	\$0	\$0	\$1,500	\$1,650	\$1,800	\$1,450
Site Plan	\$450	\$607	\$14,613	\$2,336	\$2,336	\$3,168	\$4,129	\$2,526	\$1,869
Permit	\$285	\$735	\$2,148	\$1,379	\$1,379	\$674	\$885	\$375	\$950
Tap fee	\$434	\$0	\$1,093	\$0	\$0	\$435	\$650	\$1,147	\$440
impact fee	\$9,332	\$6,485	\$7,200	\$5,920	\$8,548	\$6,361	\$6,694	\$4,718	\$7,129
<b>Total Fees per unit</b>	<b>\$11,256</b>	<b>\$10,188</b>	<b>\$41,303</b>	<b>\$10,234</b>	<b>\$12,862</b>	<b>\$13,190</b>	<b>\$16,507</b>	<b>\$12,453</b>	<b>\$13,886</b>
	average	median	min	max					
Comprehensive Plan	\$130	\$0	\$0	\$750					
Zoning	\$344	\$259	\$0	\$2,479					
Subdivision	\$1,140	\$883	\$45	\$8,106					
Dedication Fee in Lieu	\$1,355	\$931	\$0	\$5,664					
Site Plan	\$2,050	\$1,175	\$0	\$14,613					
Permit	\$918	\$794	\$285	\$2,148					
Tap fee	\$1,797	\$813	\$0	\$8,850					
impact fee	\$6,006	\$6,423	\$0	\$10,500					
<b>Total Fees per unit</b>	<b>\$13,725</b>	<b>\$12,438</b>	<b>\$5,014</b>	<b>\$41,303</b>					

Sources: Texas Real Estate Research Center at Texas A&M University; Planning, Development and Building departments of the respective cities

**Table 9. Ratio of Fees Charged by Municipality by Fee Category to Average Fee by Fee Category, Development Model 2**

	Houston min	Houston max	Dallas	Fort Worth min	Fort Worth max	Liberty Hill	Manor	Pflugerville min	Pflugerville max
Comprehensive Plan	0.00	0.00	0.00	0.00	0.00	0.00	0.00	0.77	0.77
Zoning	0.00	0.00	2.29	0.92	0.92	0.08	0.45	0.52	0.52
Subdivision	0.35	0.35	0.63	0.70	0.70	0.81	1.08	0.51	0.51
Dedication Fee in Lieu	0.62	0.62	1.04	0.23	0.23	0.71	0.49	0.77	0.77
Site Plan	0.00	0.00	0.67	0.00	0.00	0.07	0.01	1.17	1.17
Permit	0.56	0.56	0.61	0.88	0.88	1.39	1.66	0.75	0.75
Tap fee	0.16	0.16	4.47	1.92	1.92	3.84	0.76	0.49	0.49
impact fee	0.51	0.51	0.00	0.60	1.03	1.65	0.85	0.77	1.27
<b>Total Fees</b>	<b>0.42</b>	<b>0.43</b>	<b>0.99</b>	<b>0.77</b>	<b>1.01</b>	<b>1.78</b>	<b>0.80</b>	<b>0.75</b>	<b>1.02</b>

	Round Rock	San Marcos	Austin	San Antonio min	San Antonio max	Kyle	Georgetown	Buda	Leander	
Comprehensive Plan	0.00	10.64	0.00	0.00	0.00	0.00	0.00	0.56	2.32	0.93
Zoning	0.21	1.05	3.98	1.58	1.58	0.12	0.22	1.03	1.03	0.52
Subdivision	0.73	0.64	2.24	0.04	0.04	0.37	0.99	1.02	5.01	
Dedication Fee in Lieu	0.28	0.73	5.04	0.00	0.00	1.34	1.47	1.60	1.29	
Site Plan	0.50	0.02	1.97	2.08	2.08	2.58	1.33	2.28	0.06	
Permit	0.29	0.76	2.21	1.42	1.42	0.69	0.91	0.39	0.98	
Tap fee	0.22	0.00	0.55	0.00	0.00	0.22	0.33	0.58	0.22	
impact fee	1.47	1.02	1.13	0.93	1.35	1.00	1.05	0.74	1.12	
<b>Total Fees</b>	<b>0.95</b>	<b>0.72</b>	<b>1.59</b>	<b>0.80</b>	<b>1.03</b>	<b>0.99</b>	<b>0.98</b>	<b>0.89</b>	<b>0.92</b>	

Sources: Texas Real Estate Research Center at Texas A&M University; Planning, Development and Building departments of the respective cities

**Table 10. Proportion of Estimated Fees Relative to Select Housing Values**

	Minimum fee for suburban-style development	Minimum fee for infill-style development	Average fee for suburban-style development	Average fee for infill-style development	Maximum fee for suburban-style development	Maximum fee for infill-style development	
	\$4,841	\$5,014	\$10,845	\$12,438	\$20,388	\$41,303	
2021 average home price	\$565,740	0.86%	0.89%	1.92%	2.20%	3.60%	7.30%
2021 median home price	\$450,000	1.08%	1.11%	2.41%	2.76%	4.53%	9.18%
Loan affordable to 2019 median renter household	\$204,556	2.37%	2.45%	5.30%	6.08%	9.97%	20.19%

Sources: Texas Real Estate Research Center at Texas A&M University; Planning, Development and Building departments of the respective cities

## Appendix - Municipal Fee Charts

The Texas Real Estate Research Center at Texas A&M University compiled all data in the appendix from the planning, development, and building departments of the respective cities.

### City of Houston – Fee Set with Minimum Impact Fee

Fee Category	Fee name	Fee basis	Development Model 1				Development Model 2			
			development, lots, or structures	units of charge	Houston min per-basis-unit fee	Houston min total charged	development, lots, or structures	units of charge	Houston min per basis unit fee	Houston min total charged
<b>Total Fees</b>						<b>\$968,175.07</b>				<b>\$20,057.17</b>
<b>Total Fees per unit</b>						<b>\$4,840.88</b>				<b>\$5,014.29</b>
<b>Comprehensive Plan</b>		<b>Total</b>				<b>\$0.00</b>				<b>\$0.00</b>
<b>Comprehensive Plan</b>		<b>Per Unit</b>				<b>\$0.00</b>				<b>\$0.00</b>
<b>Zoning</b>		<b>Total</b>				<b>\$0.00</b>				<b>\$0.00</b>
<b>Zoning</b>		<b>Per Unit</b>				<b>\$0.00</b>				<b>\$0.00</b>
<b>Subdivision</b>		<b>Total</b>				<b>\$6,177.44</b>				<b>\$1,040.28</b>
<b>Subdivision</b>		<b>Per Unit</b>				<b>\$30.89</b>				<b>\$260.07</b>
		residential creates 4 or fewer lots fronting an existing street, no new street								
Subdivision	Application plat Class I	no new easement	0	0	\$509.49	\$0.00	0	0	\$509.49	\$0.00
Subdivision	Application plat Class II	no new street or easement	0	0	\$935.44	\$0.00	0	0	\$935.44	\$0.00
Subdivision	Application plat Class III	new street or easement	1	1	\$935.44	\$935.44	1	1	\$935.44	\$935.44
Subdivision	plat	per lot	200	1	\$26.21	\$5,242.00	4	1	\$26.21	\$104.84
<b>Dedication Fee in Lieu</b>		<b>Total</b>				<b>\$140,000.00</b>				<b>\$2,800.00</b>
<b>Dedication Fee in Lieu</b>		<b>Per Unit</b>				<b>\$700.00</b>				<b>\$700.00</b>
Dedication Fee in Lieu	parkland Development	per residential unit	200	1	\$700.00	\$140,000.00	4	1	\$700.00	\$2,800.00
<b>Site Plan</b>		<b>Total</b>				<b>\$0.00</b>				<b>\$0.00</b>
<b>Site Plan</b>		<b>Per Unit</b>				<b>\$0.00</b>				<b>\$0.00</b>
<b>Permit</b>		<b>Total</b>				<b>\$109,477.63</b>				<b>\$1,966.49</b>
<b>Permit</b>		<b>Per Unit</b>				<b>\$547.39</b>				<b>\$491.62</b>
Permit	Paving plan	single family structure	200	1	\$85.45	\$17,090.00	4	1	\$85.45	\$341.80
Permit	Sidewalks	First 100 lineal feet	1	1	\$42.72	\$42.72	1	1	\$42.72	\$42.72
Permit	Sidewalks	each additional 100 lineal feet	140	13	\$10.37	\$18,873.40	2	2	\$10.37	\$41.48
Permit	Driveways	each	200	1	\$42.72	\$8,544.00	4	1	\$42.72	\$170.88
Permit	Gas Permit and inspection	up to 4 openings	1	1	\$41.39	\$41.39	1	1	\$41.39	\$41.39
Permit	Gas Permit and inspection	each opening above 4	0	0	\$7.10	\$0.00	0	0	\$7.10	\$0.00
Permit	Furnace	first furnace	1	1	\$31.12	\$31.12	1	1	\$31.12	\$31.12

Permit	Plumbing fixtures	base	200	1	\$31.12	\$6,224.00	4	1	\$31.12	\$124.48
Permit	Plumbing fixtures	each after the first 3	200	9	\$10.37	\$18,666.00	4	9	\$10.37	\$373.32
Permit	Sewer Connection	connection	200	1	\$48.83	\$9,766.00	4	1	\$48.83	\$195.32
Permit	Electrical	Outlets each	200	30	\$1.22	\$7,320.00	4	30	\$1.22	\$146.40
Permit	Electrical	Fixtures each	200	30	\$1.22	\$7,320.00	4	30	\$1.22	\$146.40
Permit	Electrical	per range	200	1	\$4.27	\$854.00	4	1	\$4.27	\$17.08
Permit	Electrical	Clothes Dryer	200	1	\$4.27	\$854.00	4	1	\$4.27	\$17.08
Permit	Electrical	Stove Top	200	1	\$4.27	\$854.00	4	1	\$4.27	\$17.08
Permit	Electrical	Oven	200	1	\$4.27	\$854.00	4	1	\$4.27	\$17.08
Permit	Electrical	Garbage Disposal	200	1	\$4.27	\$854.00	4	1	\$4.27	\$17.08
Permit	HVAC	base	200	1	\$42.72	\$8,544.00	4	1	\$42.72	\$170.88
Permit	HVAC	per ton	200	2.5	\$5.49	\$2,745.00	4	2.5	\$5.49	\$54.90
<b>Tap fee</b>		<b>Total</b>				<b>\$64,572.00</b>				<b>\$1,291.44</b>
<b>Tap fee</b>		<b>Per Unit</b>				<b>\$322.86</b>				<b>\$322.86</b>
Tap fee	water	5/8 meter	200	1	\$291.49	\$58,298.00	4	1	\$291.49	\$1,165.96
tap fee	wastewater	4 inch	200	1	\$31.37	\$6,274.00	4	1	\$31.37	\$125.48
<b>impact fee</b>		<b>Total</b>				<b>\$647,948.00</b>				<b>\$12,958.96</b>
<b>impact fee</b>		<b>Per Unit</b>				<b>\$3,239.74</b>				<b>\$3,239.74</b>
impact fee	water	5/8 meter	200	1	\$1,621.63	\$324,326.00	4	1	\$1,621.63	\$6,486.52
impact fee	sewer	5/8 meter	200	1	\$1,618.11	\$323,622.00	4	1	\$1,618.11	\$6,472.44
impact fee	drainage	per 1,000 sf of impervious surface	200	1.5	\$0.00	\$0.00	12	1.5	\$0.00	\$0.00



## City of Houston – Fee Set with Maximum Impact Fee

Fee Category	Fee name	Fee basis	Development Model 1				Development Model 2			
			development, lots, or structures	units of charge	Houston max per basis unit fee	Houston max total charged	development, lots, or structures	units of charge	Houston max per basis unit fee	Houston max total charged
<b>Total Fees</b>						<b>\$973,319.07</b>				<b>\$20,372.69</b>
<b>Total Fees per unit</b>						<b>\$4,866.60</b>				<b>\$5,093.17</b>
<b>Comprehensive Plan</b>	<b>Total</b>					<b>\$0.00</b>				<b>\$0.00</b>
<b>Comprehensive Plan</b>	<b>Per Unit</b>					<b>\$0.00</b>				<b>\$0.00</b>
<b>Zoning</b>	<b>Total</b>					<b>\$0.00</b>				<b>\$0.00</b>
<b>Zoning</b>	<b>Per Unit</b>					<b>\$0.00</b>				<b>\$0.00</b>
<b>Subdivision</b>	<b>Total</b>					<b>\$6,177.44</b>				<b>\$1,040.28</b>
<b>Subdivision</b>	<b>Per Unit</b>					<b>\$30.89</b>				<b>\$260.07</b>
		residential creates 4 or fewer lots fronting an existing street, no new street								
		no new street or easement								
Subdivision	Application plat Class I	no new street or easement	0	0	\$509.49	\$0.00	0	0	\$509.49	\$0.00
Subdivision	Application plat Class II	no new street or easement	0	0	\$935.44	\$0.00	0	0	\$935.44	\$0.00
Subdivision	Application plat Class III	new street or easement	1	1	\$935.44	\$935.44	1	1	\$935.44	\$935.44
Subdivision	plat	per lot	200	1	\$26.21	\$5,242.00	4	1	\$26.21	\$104.84
<b>Dedication Fee in Lieu</b>	<b>Total</b>					<b>\$140,000.00</b>				<b>\$2,800.00</b>
<b>Dedication Fee in Lieu</b>	<b>Per Unit</b>					<b>\$700.00</b>				<b>\$700.00</b>
Dedication Fee in Lieu	parkland Development	per residential unit	200	1	\$700.00	\$140,000.00	4	1	\$700.00	\$2,800.00
<b>Site Plan</b>	<b>Total</b>					<b>\$0.00</b>				<b>\$0.00</b>
<b>Site Plan</b>	<b>Per Unit</b>					<b>\$0.00</b>				<b>\$0.00</b>
<b>Permit</b>	<b>Total</b>					<b>\$109,477.63</b>				<b>\$1,966.49</b>
<b>Permit</b>	<b>Per Unit</b>					<b>\$547.39</b>				<b>\$491.62</b>
Permit	Paving plan	single family structure	200	1	\$85.45	\$17,090.00	4	1	\$85.45	\$341.80
Permit	Sidewalks	First 100 lineal feet	1	1	\$42.72	\$42.72	1	1	\$42.72	\$42.72
Permit	Sidewalks	each additional 100 lineal feet	140	13	\$10.37	\$18,873.40	2	2	\$10.37	\$41.48
Permit	Driveways	each	200	1	\$42.72	\$8,544.00	4	1	\$42.72	\$170.88
Permit	Gas Permit and inspection	up to 4 openings	1	1	\$41.39	\$41.39	1	1	\$41.39	\$41.39
Permit	Gas Permit and inspection	each opening above 4	0	0	\$7.10	\$0.00	0	0	\$7.10	\$0.00
Permit	Furnace	first furnace	1	1	\$31.12	\$31.12	1	1	\$31.12	\$31.12
Permit	Plumbing fixtures	base	200	1	\$31.12	\$6,224.00	4	1	\$31.12	\$124.48
Permit	Plumbing fixtures	each after the first 3	200	9	\$10.37	\$18,666.00	4	9	\$10.37	\$373.32
Permit	Sewer Connection	connection	200	1	\$48.83	\$9,766.00	4	1	\$48.83	\$195.32
Permit	Electrical	Outlets each	200	30	\$1.22	\$7,320.00	4	30	\$1.22	\$146.40
Permit	Electrical	Fixtures each	200	30	\$1.22	\$7,320.00	4	30	\$1.22	\$146.40

Permit	Electrical	per range	200	1	\$4.27	\$854.00	4	1	\$4.27	\$17.08
Permit	Electrical	Clothes Dryer	200	1	\$4.27	\$854.00	4	1	\$4.27	\$17.08
Permit	Electrical	Stove Top	200	1	\$4.27	\$854.00	4	1	\$4.27	\$17.08
Permit	Electrical	Oven	200	1	\$4.27	\$854.00	4	1	\$4.27	\$17.08
Permit	Electrical	Garbage Disposal	200	1	\$4.27	\$854.00	4	1	\$4.27	\$17.08
Permit	HVAC	base	200	1	\$42.72	\$8,544.00	4	1	\$42.72	\$170.88
Permit	HVAC	per ton	200	2.5	\$5.49	\$2,745.00	4	2.5	\$5.49	\$54.90
Building Permit application	Permit Fee	Permit Application	200	1			4	1		
<b>Tap fee</b>		<b>Total</b>				<b>\$64,400.00</b>				<b>\$1,288.00</b>
<b>Tap fee</b>		<b>Per Unit</b>				<b>\$322.00</b>				<b>\$322.00</b>
Tap fee	water	5/8 meter	200	1	\$291.00	\$58,200.00	4	1	\$291.00	\$1,164.00
tap fee	wastewater	4 inch	200	1	\$31.00	\$6,200.00	4	1	\$31.00	\$124.00
<b>impact fee</b>		<b>Total</b>				<b>\$653,264.00</b>				<b>\$13,277.92</b>
<b>impact fee</b>		<b>Per Unit</b>				<b>\$3,266.32</b>				<b>\$3,319.48</b>
impact fee	water	5/8 meter	200	1	\$1,621.63	\$324,326.00	4	1	\$1,621.63	\$6,486.52
impact fee	sewer	5/8 meter	200	1	\$1,618.11	\$323,622.00	4	1	\$1,618.11	\$6,472.44
impact fee	drainage	per 1,000 sf of impervious surface	200	1.5	\$17.72	\$5,316.00	12	1.5	\$17.72	\$318.96



# City of Dallas – Fee Set

Fee Category	Fee name	Fee basis	Development model 1				Development model 2			
			development, lots, or structures	units of charge	per basis unit fee	total charged	development, lots, or structures	units of charge	per basis unit fee	total charged
<b>Total Fees</b>						<b>\$2,264,046.00</b>				<b>\$52,394.00</b>
<b>Total Fees per unit</b>						<b>\$11,320.23</b>				<b>\$13,098.50</b>
<b>Comprehensive Plan</b>		<b>Total</b>				<b>\$0.00</b>				<b>\$0.00</b>
<b>Comprehensive Plan</b>		<b>Per Unit</b>				<b>\$0.00</b>				<b>\$0.00</b>
<b>Zoning</b>		<b>Total</b>				<b>\$11,010.00</b>				<b>\$1,050.00</b>
<b>Zoning</b>		<b>Per Unit</b>				<b>\$55.05</b>				<b>\$262.50</b>
Zoning	Zoning Review	per acre more than 25 acres	1	15	\$113.00	\$1,695.00	0	0	\$113.00	\$0.00
Zoning	Zoning Review	0-1 acres	0	0	\$1,050.00	\$0.00	1	1	\$1,050.00	\$1,050.00
Zoning	Zoning Review	1-5 acres	0	0	\$2,610.00	\$0.00	0	0	\$2,610.00	\$0.00
Zoning	Zoning Review	5-15 acres	0	0	\$5,820.00	\$0.00	0	0	\$5,820.00	\$0.00
Zoning	Zoning Review	15-25 acres	0	0	\$9,315.00	\$0.00	0	0	\$9,315.00	\$0.00
Zoning	Zoning Review	25+ acres	1	1	\$9,315.00	\$9,315.00	0	0	\$9,315.00	\$0.00
<b>Subdivision</b>		<b>Total</b>				<b>\$11,186.00</b>				<b>\$1,633.00</b>
<b>Subdivision</b>		<b>Per Unit</b>				<b>\$55.93</b>				<b>\$408.25</b>
Subdivision	preliminary plat	development if 20 or fewer lots	0	0	\$1,548.00	\$0.00	0	0	\$1,548.00	\$0.00
Subdivision	preliminary plat	per lot if 20 or fewer lots	0	0	\$17.00	\$0.00	1	1	\$17.00	\$17.00
Subdivision	preliminary plat	development if more than 20 lots	1	1	\$2,193.00	\$2,193.00	0	0	\$2,193.00	\$0.00
Subdivision	preliminary plat	per lot if more than 20 lots	200	1	\$17.00	\$3,400.00	0	0	\$17.00	\$0.00
Subdivision	final plat	development if 20 or fewer lots	0	0	\$1,548.00	\$0.00	1	1	\$1,548.00	\$1,548.00
Subdivision	final plat	per lot if 20 or fewer lots	0	0	\$17.00	\$0.00	1	4	\$17.00	\$68.00
Subdivision	final plat	development if more than 20 lots	1	1	\$2,193.00	\$2,193.00	0	0	\$2,193.00	\$0.00
Subdivision	final plat	per lot if more than 20 lots	200	1	\$17.00	\$3,400.00	0	0	\$17.00	\$0.00
<b>Dedication Fee in Lieu</b>		<b>Total</b>				<b>\$233,000.00</b>				<b>\$4,660.00</b>
<b>Dedication Fee in Lieu</b>		<b>Per Unit</b>				<b>\$1,165.00</b>				<b>\$1,165.00</b>
Dedication fee in Lieu	Parkland Development	per single family unit	200	1	\$403.00	\$80,600.00	4	1	\$403.00	\$1,612.00
Dedication Fee in Lieu	Dedication Fee in Lieu	per single family or duplex	200	1	\$762.00	\$152,400.00	4	1	\$762.00	\$3,048.00
<b>Site Plan</b>		<b>Total</b>				<b>\$120,050.00</b>				<b>\$7,275.00</b>
<b>Site Plan</b>		<b>Per Unit</b>				<b>\$600.25</b>				<b>\$1,818.75</b>
Site Plan	Review fee	per development	1	1	\$50.00	\$50.00	1	1	\$50.00	\$50.00
Site Plan	Infrastructure Inspection	if value less than 12,500	0	0	\$600.00	\$0.00	0	0	\$600.00	\$0.00
Site Plan	Infrastructure Inspection	if value 12501-25000	0	0	\$1,000.00	\$0.00	0	0	\$1,000.00	\$0.00
Site Plan	Infrastructure Inspection	if value 25001 - 100000	0	0	\$1,000.00	\$0.00	0	0	\$1,000.00	\$0.00
Site Plan	Infrastructure Inspection	if value 100001 - 500000	0	0	\$3,625.00	\$0.00	1	1	\$3,625.00	\$3,625.00

Site Plan	Infrastructure Inspection	if value 500001 - 1000000	0	0	\$15,625.00		0	0	\$15,625.00	\$0.00
Site Plan	Infrastructure Inspection	if value 1000001 or greater	1	1	\$28,125.00				\$28,125.00	
Site Plan	Infrastructure Inspection	Per dollar value if value 25001-100000	0	0	\$0.04		0	0	\$0.04	\$0.00
Site Plan	Infrastructure Inspection	Per dollar value if value 100001-500000	0	0	\$0.03		1	1E+05	\$0.03	\$3,600.00
Site Plan	Infrastructure Inspection	Per dollar value if value 500001 - 1000000	0	0	\$0.03		0	0	\$0.03	\$0.00
Site Plan	Infrastructure Inspection	Per dollar value if value 1000001 or greater	1	6E+06	\$0.02	\$120,000.00	0	0	\$0.02	\$0.00
<b>Permit</b>		<b>Total</b>							<b>\$118,800.00</b>	<b>\$2,376.00</b>
<b>Permit</b>		<b>Per Unit</b>							<b>\$594.00</b>	<b>\$594.00</b>
Permit	Building	structure 700 sf or less	0	0	\$0.00	\$0.00	0	0	\$0.00	\$0.00
Permit	Building	per sf in structure 700 sf or less	0	0	\$0.82	\$0.00	0	0	\$0.82	\$0.00
Permit	Building	structure between 701-2350 sf	200	1	\$422.00	\$84,400.00	4	1	\$422.00	\$1,688.00
Permit	Building	per sf between 701-2350 in structure of 701-2350	200	800	\$0.22	\$34,400.00	4	800	\$0.22	\$688.00
Permit	Building	structure between 2351-10500 sf	0	0	\$516.00	\$0.00	0	0	\$516.00	\$0.00
Permit	Building	per sf between 2351-10500 in structure of 2351-10500	0	0	\$0.18	\$0.00	0	0	\$0.18	\$0.00
Permit	Building	structure greater than 10500	0	0	\$1,608.00	\$0.00	0	0	\$1,608.00	\$0.00
Permit	Building	per sf greater than 10500 in structure of 10500 or greater	0	0	\$0.07	\$0.00	0	0	\$0.07	\$0.00
<b>Tap fee</b>		<b>Total</b>							<b>\$1,770,000.00</b>	<b>\$35,400.00</b>
<b>Tap fee</b>		<b>Per Unit</b>							<b>\$8,850.00</b>	<b>\$8,850.00</b>
Tap fee	water	3/4 meter	200	1	\$3,790.00	\$758,000.00	4	1	\$3,790.00	\$15,160.00
Tap fee	water	base	200	1	\$500.00	\$100,000.00	4	1	\$500.00	\$2,000.00
Tap fee	wastewater	base	200	1	\$500.00	\$100,000.00	4	1	\$500.00	\$2,000.00
Tap fee	wastewater connection	6 inch	200	1	\$4,060.00	\$812,000.00	4	1	\$4,060.00	\$16,240.00
<b>impact fee</b>		<b>Total</b>							<b>\$0.00</b>	<b>\$0.00</b>
<b>impact fee</b>		<b>Per Unit</b>							<b>\$0.00</b>	<b>\$0.00</b>



# City of Austin – Fee Set

Fee Category	Fee name	Fee basis	Development model 1				Development model 2			
			development, lots, or structures	units of charge	per basis unit fee	total charged	development, lots, or structures	units of charge	per basis unit fee	total charged
<b>Total Fees</b>						<b>\$3,633,668.60</b>				<b>\$165,213.92</b>
<b>Total Fees per unit</b>						<b>\$18,168.34</b>				<b>\$41,303.48</b>
<b>Comprehensive Plan</b>		<b>Total</b>				<b>\$0.00</b>				<b>\$0.00</b>
<b>Comprehensive Plan</b>		<b>Per Unit</b>				<b>\$0.00</b>				<b>\$0.00</b>
<b>Zoning</b>		<b>Total</b>				<b>\$19,135.60</b>				<b>\$9,916.00</b>
<b>Zoning</b>		<b>Per Unit</b>				<b>\$95.68</b>				<b>\$2,479.00</b>
Zoning	Zoning Review	<.25 acres	0	0	\$8,876.00	\$0.00	0	0	\$8,876.00	\$0.00
Zoning	Zoning Review	.25<x<.5 acres	0	0	\$9,292.00	\$0.00	0	0	\$9,292.00	\$0.00
Zoning	Zoning Review	.5<x<1 acres	0	0	\$9,916.00	\$0.00	1	1	\$9,916.00	\$9,916.00
Zoning	Zoning Review	1<x<10 acres	0	0	\$11,221.20	\$0.00	0	0	\$11,221.20	\$0.00
Zoning	Zoning Review	Per acre 1<x<10 acres	0	0	\$140.00	\$0.00	0	0	\$140.00	\$0.00
Zoning	Zoning Review	10<x<15 acres	0	0	\$12,838.40	\$0.00	0	0	\$12,838.40	\$0.00
Zoning	Zoning Review	Per acre 10<x<15 acres	0	0	\$332.80	\$0.00	0	0	\$332.80	\$0.00
Zoning	Zoning Review	>15 acres	1	1	\$15,235.60	\$15,235.60	0	0	\$15,235.60	\$0.00
Zoning	Zoning Review	Per acre >15 acres	1	25	\$156.00	\$3,900.00	0	0	\$156.00	\$0.00
<b>Subdivision</b>		<b>Total</b>				<b>\$39,888.80</b>				<b>\$32,425.76</b>
<b>Subdivision</b>		<b>Per Unit</b>				<b>\$199.44</b>				<b>\$8,106.44</b>
Subdivision	Preliminary Plan	development	1	1	\$19,901.76	\$19,901.76	1	1	\$19,901.76	\$19,901.76
Subdivision	Preliminary Plan	per acre	1	40	\$95.68	\$3,827.20	1	1	\$95.68	\$95.68
Subdivision	Final Plat	development	1	1	\$12,332.64	\$12,332.64	1	1	\$12,332.64	\$12,332.64
Subdivision	Final Plat	per acre	1	40	\$95.68	\$3,827.20	1	1	\$95.68	\$95.68
<b>Dedication Fee in Lieu</b>		<b>Total</b>				<b>\$1,132,734.00</b>				<b>\$22,654.68</b>
<b>Dedication Fee in Lieu</b>		<b>Per Unit</b>				<b>\$5,663.67</b>				<b>\$5,663.67</b>
Dedication fee in Lieu	Parkland Development	per single family unit	200	1	\$4,796.51	\$959,302.00	4	1	\$4,796.51	\$19,186.04
Dedication Fee in Lieu	parkland Development	per residential unit	200	1	\$867.16	\$173,432.00	4	1	\$867.16	\$3,468.64
<b>Site Plan</b>		<b>Total</b>				<b>\$353,670.20</b>				<b>\$58,452.68</b>
<b>Site Plan</b>		<b>Per Unit</b>				<b>\$1,768.35</b>				<b>\$14,613.17</b>
Site Plan	D Site Plan Building Parking Other Site Work	development	1	1	\$17,544.88	\$17,544.88	1	1	\$17,544.88	\$17,544.88
Site Plan	D Site Plan Building Parking Other Site Work	per acre over 10 acres	1	30	\$175.76	\$5,272.80	1	0	\$175.76	\$0.00
Site Plan	D Site Plan Utility Lines	less 1000 linear feet	0	0	\$7,912.36	\$0.00	1	1	\$7,912.36	\$7,912.36
Site Plan	D Site Plan Utility Lines	1001-5000 linear feet	0	0	\$8,095.40	\$0.00	0	0	\$8,095.40	\$0.00
Site Plan	D Site Plan Utility Lines	5001-10000 linear feet	1	1	\$8,279.48	\$8,279.48	0	0	\$8,279.48	\$0.00

Site Plan	D Site Plan Utility Lines	greater than 10000 linear feet	0	0	\$8,462.52	\$0.00	0	0	\$8,462.52	\$0.00
Site Plan	D Site Plan Utility Lines	per 5000 linear over 10000 linear feet	0	0	\$183.04	\$0.00	0	0	\$183.04	\$0.00
Site Plan	D Site Plan Street & Drainage	less 1000 linear feet	0	0	\$11,696.16	\$0.00	1	1	\$11,696.16	\$11,696.16
Site Plan	D Site Plan Street & Drainage	1001-5000 linear feet	0	0	\$12,063.28	\$0.00	0	0	\$12,063.28	\$0.00
Site Plan	D Site Plan Street & Drainage	5001-10000 linear feet	1	1	\$12,430.40	\$12,430.40	0	0	\$12,430.40	\$0.00
Site Plan	D Site Plan Street & Drainage	greater than 10000 linear feet	0	0	\$12,430.40	\$0.00	0	0	\$12,430.40	\$0.00
Site Plan	D Site Plan Street & Drainage	per 5000 linear over 10000 linear feet	0	0	\$183.04	\$0.00	0	0	\$183.04	\$0.00
Site Plan	D Site Plan Major Drainage	less than 2 acres	0	0	\$8,482.56	\$0.00	1	1	\$8,482.56	\$8,482.56
Site Plan	D Site Plan Major Drainage	2-5 acres	0	0	\$8,849.68	\$0.00	0	0	\$8,849.68	\$0.00
Site Plan	D Site Plan Major Drainage	5-10 acres	0	0	\$9,215.76	\$0.00	0	0	\$9,215.76	\$0.00
Site Plan	D Site Plan Major Drainage	greater than 10 acres	1	1	\$9,215.76	\$9,215.76	0	0	\$9,215.76	\$0.00
Site Plan	D Site Plan Major Drainage	per acre greater than 10 acres	1	30	\$220.48	\$6,614.40	0	0	\$220.48	\$0.00
Site Plan	Transportation Engineering Review	development	1	1	\$1,100.32	\$1,100.32	1	1	\$1,100.32	\$1,100.32
Site Plan	Transportation Engineering Review	per acre	40	1	\$36.40	\$1,456.00	1	1	\$36.40	\$36.40
Site Plan	Transportation Site Plan As part of other site plan	development	1	1	\$5,964.16	\$5,964.16	1	1	\$5,964.16	\$5,964.16
Tree Protection	Pre-Development Consultation	lot	200	1	\$390.00	\$78,000.00	4	1	\$390.00	\$1,560.00
Tree Protection	Tree Plan Review	lot	200	1	\$569.92	\$113,984.00	4	1	\$569.92	\$2,279.68
Tree Protection	Inspection, New Construction	lot	200	1	\$469.04	\$93,808.00	4	1	\$469.04	\$1,876.16
<b>Permit</b>		<b>Total</b>				<b>\$429,662.00</b>			<b>\$8,593.24</b>	<b>\$8,593.24</b>
<b>Permit</b>		<b>Per Unit</b>				<b>\$2,148.31</b>			<b>\$2,148.31</b>	<b>\$2,148.31</b>
Permit	Building	per structure of 0-1000 sf	0	0	\$292.46	\$0.00	0	0	\$292.46	\$0.00
Permit	Building	per structure of 1000-2000 sf	200	1	\$292.46	\$58,492.00	4	1	\$292.46	\$1,169.84
Permit	Building	per structure of 2000-3000 sf	0	0	\$350.62	\$0.00	0	0	\$350.62	\$0.00
Permit	Building	per structure of 3000-4000 sf	0	0	\$408.79	\$0.00	0	0	\$408.79	\$0.00
Permit	Building	per structure of 4000-5000 sf	0	0	\$466.95	\$0.00	0	0	\$466.95	\$0.00
Permit	Building	per structure of 5000- sf	0	0	\$525.11	\$0.00	0	0	\$525.11	\$0.00
Permit	Building	per 100 sf between 1000-2000 sf	200	5	\$5.82	\$5,820.00	4	5	\$5.82	\$116.40
Permit	Building	per 100 sf between 2000-3000 sf	0	0	\$5.82	\$0.00	0	0	\$5.82	\$0.00
Permit	Building	per 100 sf between 3000-4000 sf	0	0	\$5.82	\$0.00	0	0	\$5.82	\$0.00
Permit	Building	per 100 sf between 4000-5000 sf	0	0	\$5.82	\$0.00	0	0	\$5.82	\$0.00
Permit	Building	per 100 sf between 5000- sf	0	0	\$29.08	\$0.00	0	0	\$29.08	\$0.00

Permit	Electrical	per structure of 0-1000 sf	0	0	\$300.77	\$0.00	0	0	\$300.77	\$0.00
Permit	Electrical	per structure of 1000-2000 sf	200	1	\$300.77	\$60,154.00	4	1	\$300.77	\$1,203.08
Permit	Electrical	per structure of 2000-3000 sf	0	0	\$327.78	\$0.00	0	0	\$327.78	\$0.00
Permit	Electrical	per structure of 3000-4000 sf	0	0	\$404.63	\$0.00	0	0	\$404.63	\$0.00
Permit	Electrical	per structure of 4000-5000 sf	0	0	\$435.79	\$0.00	0	0	\$435.79	\$0.00
Permit	Electrical	per structure of 5000- sf	0	0	\$525.11	\$0.00	0	0	\$525.11	\$0.00
Permit	Electrical	per 100 sf between 1000-2000 sf	200	5	\$2.70	\$2,700.00	4	5	\$2.70	\$54.00
Permit	Electrical	per 100 sf between 2000-3000 sf	0	0	\$7.69	\$0.00	0	0	\$7.69	\$0.00
Permit	Electrical	per 100 sf between 3000-4000 sf	0	0	\$3.12	\$0.00	0	0	\$3.12	\$0.00
Permit	Electrical	per 100 sf between 4000-5000 sf	0	0	\$8.93	\$0.00	0	0	\$8.93	\$0.00
Permit	Electrical	per 100 sf between 5000- sf	0	0	\$44.66	\$0.00	0	0	\$44.66	\$0.00
Permit	Mechanical Permit	per structure of 0-1000 sf	0	0	\$105.52	\$0.00	0	0	\$105.52	\$0.00
Permit	Mechanical Permit	per structure of 1000-2000 sf	200	1	\$105.52	\$21,104.00	4	1	\$105.52	\$422.08
Permit	Mechanical Permit	per structure of 2000-3000 sf	0	0	\$117.98	\$0.00	0	0	\$117.98	\$0.00
Permit	Mechanical Permit	per structure of 3000-4000 sf	0	0	\$130.45	\$0.00	0	0	\$130.45	\$0.00
Permit	Mechanical Permit	per structure of 4000-5000 sf	0	0	\$142.91	\$0.00	0	0	\$142.91	\$0.00
Permit	Mechanical Permit	per structure of 5000- sf	0	0	\$167.84	\$0.00	0	0	\$167.84	\$0.00
Permit	Mechanical Permit	per 100 sf between 1000-2000 sf	200	5	\$1.25	\$1,250.00	4	5	\$1.25	\$25.00
Permit	Mechanical Permit	per 100 sf between 2000-3000 sf	0	0	\$1.25	\$0.00	0	0	\$1.25	\$0.00
Permit	Mechanical Permit	per 100 sf between 3000-4000 sf	0	0	\$1.25	\$0.00	0	0	\$1.25	\$0.00
Permit	Mechanical Permit	per 100 sf between 4000-5000 sf	0	0	\$2.49	\$0.00	0	0	\$2.49	\$0.00
Permit	Mechanical Permit	per 100 sf between 5000- sf	0	0	\$12.46	\$0.00	0	0	\$12.46	\$0.00
Permit	Plumbing Permit	per structure of 0-1000 sf	0	0	\$205.22	\$0.00	0	0	\$205.22	\$0.00
Permit	Plumbing Permit	per structure of 1000-2000 sf	200	1	\$205.22	\$41,044.00	4	1	\$205.22	\$820.88
Permit	Plumbing Permit	per structure of 2000-3000 sf	0	0	\$234.30	\$0.00	0	0	\$234.30	\$0.00
Permit	Plumbing Permit	per structure of 3000-4000 sf	0	0	\$263.38	\$0.00	0	0	\$263.38	\$0.00
Permit	Plumbing Permit	per structure of 4000-5000 sf	0	0	\$292.46	\$0.00	0	0	\$292.46	\$0.00
Permit	Plumbing Permit	per structure of 5000- sf	0	0	\$350.62	\$0.00	0	0	\$350.62	\$0.00
Permit	Plumbing Permit	per 100 sf between 1000-2000 sf	200	5	\$2.91	\$2,910.00	4	5	\$2.91	\$58.20
Permit	Plumbing Permit	per 100 sf between 2000-3000 sf	0	0	\$2.91	\$0.00	0	0	\$2.91	\$0.00
Permit	Plumbing Permit	per 100 sf between 3000-4000 sf	0	0	\$2.91	\$0.00	0	0	\$2.91	\$0.00

Permit	Plumbing Permit	per 100 sf between 4000-5000 sf	0	0	\$5.82	\$0.00	0	0	\$5.82	\$0.00
Permit	Plumbing Permit	per 100 sf between 5000-sf	0	0	\$29.08	\$0.00	0	0	\$29.08	\$0.00
Permit	Energy	per structure of 0-1000 sf	0	0	\$59.82	\$0.00	0	0	\$59.82	\$0.00
Permit	Energy	per structure of 1000-2000 sf	200	1	\$59.82	\$11,964.00	4	1	\$59.82	\$239.28
Permit	Energy	per structure of 2000-3000 sf	0	0	\$59.82	\$0.00	0	0	\$59.82	\$0.00
Permit	Energy	per structure of 3000-4000 sf	0	0	\$59.82	\$0.00	0	0	\$59.82	\$0.00
Permit	Energy	per structure of 4000-5000 sf	0	0	\$59.82	\$0.00	0	0	\$59.82	\$0.00
Permit	Energy	per structure of 5000- sf	0	0	\$59.82	\$0.00	0	0	\$59.82	\$0.00
Permit	Energy	per 100 sf between 1000-2000 sf	200	5	\$0.00	\$0.00	4	5	\$0.00	\$0.00
Permit	Energy	per 100 sf between 2000-3000 sf	0	0	\$0.00	\$0.00	0	0	\$0.00	\$0.00
Permit	Energy	per 100 sf between 3000-4000 sf	0	0	\$0.00	\$0.00	0	0	\$0.00	\$0.00
Permit	Energy	per 100 sf between 4000-5000 sf	0	0	\$0.00	\$0.00	0	0	\$0.00	\$0.00
Permit	Energy	per 100 sf between 5000-sf	0	0	\$0.00	\$0.00	0	0	\$0.00	\$0.00
Permit	Plan Review	per structure of 0-1000 sf	0	0	\$847.60	\$0.00	0	0	\$847.60	\$0.00
Permit	Plan Review	per structure of 1000-2000 sf	200	1	\$1,017.12	\$203,424.00	4	1	\$1,017.12	\$4,068.48
Permit	Plan Review	per structure of 2000-3000 sf	0	0	\$1,186.64	\$0.00	0	0	\$1,186.64	\$0.00
Permit	Plan Review	per structure of 3000-4000 sf	0	0	\$1,356.16	\$0.00	0	0	\$1,356.16	\$0.00
Permit	Plan Review	per structure of 4000-5000 sf	0	0	\$1,525.68	\$0.00	0	0	\$1,525.68	\$0.00
Permit	Plan Review	per structure of 5000- sf	0	0	\$1,695.20	\$0.00	0	0	\$1,695.20	\$0.00
Permit	Plan Review	per 100 sf between 1000-2000 sf	200	5	\$20.80	\$20,800.00	4	5	\$20.80	\$416.00
Permit	Plan Review	per 100 sf between 2000-3000 sf	0	0	\$20.80	\$0.00	0	0	\$20.80	\$0.00
Permit	Plan Review	per 100 sf between 3000-4000 sf	0	0	\$20.80	\$0.00	0	0	\$20.80	\$0.00
Permit	Plan Review	per 100 sf between 4000-5000 sf	0	0	\$20.80	\$0.00	0	0	\$20.80	\$0.00
Permit	Plan Review	per 100 sf between 5000-sf	0	0	\$20.80	\$0.00	0	0	\$20.80	\$0.00
<b>Tap fee</b>	<b>Total</b>					<b>\$218,578.00</b>				<b>\$4,371.56</b>
<b>Tap fee</b>	<b>Per Unit</b>					<b>\$1,092.89</b>				<b>\$1,092.89</b>
Tap fee	water	5/8 meter	200	1	\$52.39	\$10,478.00	4	1	\$52.39	\$209.56
Tap fee	water drop in base fee	5/8 inch	200	1	\$172.00	\$34,400.00	4	1	\$172.00	\$688.00
Tap fee	water CRF	5/8 inch	200	1	\$500.00	\$100,000.00	4	1	\$500.00	\$2,000.00
Tap fee	wastewater CRF	5/8 inch	200	1	\$300.00	\$60,000.00	4	1	\$300.00	\$1,200.00
Tap fee	meter install inspection fee	5/8 inch	200	1	\$68.50	\$13,700.00	4	1	\$68.50	\$274.00
<b>impact fee</b>	<b>Total</b>					<b>\$1,440,000.00</b>				<b>\$28,800.00</b>
<b>impact fee</b>	<b>Per Unit</b>					<b>\$7,200.00</b>				<b>\$7,200.00</b>



impact fee	water	5/8 meter	200	1	\$4,700.00	\$940,000.00	4	1	\$4,700.00	\$18,800.00
impact fee	sewer	5/8 meter	200	1	\$2,500.00	\$500,000.00	4	1	\$2,500.00	\$10,000.00

# City of Fort Worth – Fee Set with Maximum Impact Fee

Fee Category	Fee name	Fee basis	Development Model 1				Development Model 2			
			development, lots, or structures	units of charge	Fort Worth max	Fort Worth max	development, lots, or structures	units of charge	Fort Worth max	Fort Worth max
					per basis unit fee	total charged			per basis unit fee	total charged
<b>Total Fees</b>						<b>\$2,311,236.00</b>				<b>\$60,718.52</b>
<b>Total Fees per unit</b>						<b>\$11,556.18</b>				<b>\$15,179.63</b>
<b>Comprehensive Plan</b>		<b>Total</b>				<b>\$0.00</b>				<b>\$0.00</b>
<b>Comprehensive Plan</b>		<b>Per Unit</b>				<b>\$0.00</b>				<b>\$0.00</b>
<b>Zoning</b>		<b>Total</b>				<b>\$4,425.00</b>				<b>\$1,200.00</b>
<b>Zoning</b>		<b>Per Unit</b>				<b>\$22.13</b>				<b>\$300.00</b>
Zoning	Zoning Review	per acre more than 25 acres	1	15	\$75.00	\$1,125.00	0	0	\$75.00	\$0.00
Zoning	Zoning Review	0-1 acres	0	0	\$1,200.00	\$0.00	1	1	\$1,200.00	\$1,200.00
Zoning	Zoning Review	1-5 acres	0	0	\$1,800.00	\$0.00	0	0	\$1,800.00	\$0.00
Zoning	Zoning Review	5.01-10 acres	0	0	\$2,700.00	\$0.00	0	0	\$2,700.00	\$0.00
Zoning	Zoning Review	10.01-25 acres	0	0	\$3,300.00	\$0.00	0	0	\$3,300.00	\$0.00
Zoning	Zoning Review	25.01 or more acres	1	1	\$3,300.00	\$3,300.00	0	0	\$3,300.00	\$0.00
<b>Subdivision</b>		<b>Total</b>				<b>\$12,385.00</b>				<b>\$3,565.00</b>
<b>Subdivision</b>		<b>Per Unit</b>				<b>\$61.93</b>				<b>\$891.25</b>
Subdivision	Preliminary Plan	development	1	1	\$850.00	\$850.00	1	1	\$850.00	\$850.00
Subdivision	Preliminary Plan	per lot	200	1	\$15.00	\$3,000.00	4	1	\$15.00	\$60.00
Subdivision	Concept Plan	development	1	1	\$900.00	\$900.00	1	1	\$900.00	\$900.00
Subdivision	Final Plat	development	1	1	\$385.00	\$385.00	1	1	\$385.00	\$385.00
Subdivision	Final Plat	per lot	200	1	\$30.00	\$6,000.00	4	1	\$30.00	\$120.00
Subdivision	Drainage Study Review	development	1	1	\$1,250.00	\$1,250.00	1	1	\$1,250.00	\$1,250.00
<b>Dedication Fee in Lieu</b>		<b>Total</b>				<b>\$52,650.00</b>				<b>\$10,530.00</b>
<b>Dedication Fee in Lieu</b>		<b>Per Unit</b>				<b>\$263.25</b>				<b>\$2,632.50</b>
Dedication Fee in Lieu	Neighborhood Based Park Development Fee	per single family unit	200	1	\$263.25	\$52,650.00	40	1	\$263.25	\$10,530.00
<b>Site Plan</b>		<b>Total</b>				<b>\$600.00</b>				<b>\$600.00</b>
<b>Site Plan</b>		<b>Per Unit</b>				<b>\$3.00</b>				<b>\$150.00</b>
Site plan	Site Development Plan	development	1	1	\$600.00	\$600.00	1	1	\$600.00	\$600.00
<b>Permit</b>		<b>Total</b>				<b>\$170,776.00</b>				<b>\$3,415.52</b>
<b>Permit</b>		<b>Per Unit</b>				<b>\$853.88</b>				<b>\$853.88</b>
Permit	Building	per structure of 0-700 sf	0	0	\$76.86	\$0.00	0	0	\$76.86	\$0.00
Permit	Building	per sf between 0-700 sf	0	0	\$0.56	\$0.00	0	0	\$0.56	\$0.00
Permit	Building	per structure of 700-1400 sf	0	0	\$430.51	\$0.00	0	0	\$430.51	\$0.00
Permit	Building	per sf between 700-1400 sf	0	0	\$0.40	\$0.00	0	0	\$0.40	\$0.00
Permit	Building	per structure of 1400-2700 sf	200	1	\$708.14	\$141,628.00	4	1	\$708.14	\$2,832.56

Permit	Building	per sf between 1400-2700 sf	200	100	\$0.30	\$5,990.00	4	100	\$0.30	\$119.80
Permit	Building	per structure of 2700- 11800 sf	0	0	\$1,092.53	\$0.00	0	0	\$1,092.53	\$0.00
Permit	Building	per sf between 2700-11800 sf	0	0	\$0.26	\$0.00	0	0	\$0.26	\$0.00
Permit	Building	per structure of 11800- 24500 sf	0	0	\$3,484.33	\$0.00	0	0	\$3,484.33	\$0.00
Permit	Building	per sf between 11800-24500 sf	0	0	\$0.20	\$0.00	0	0	\$0.20	\$0.00
Permit	Building	per structure of 24500- sf	0	0	\$6,047.01	\$0.00	0	0	\$6,047.01	\$0.00
Permit	Building	per sf between 24500- sf	0	0	\$0.15	\$0.00	0	0	\$0.15	\$0.00
Permit	HVAC	per furnace of less than	200	1	\$5.14	\$1,028.00	4	1	\$5.14	\$20.56
Permit	HVAC	per A/C unit	200	1	\$5.57	\$1,114.00	4	1	\$5.57	\$22.28
Permit	Plumbing	first fixture or appliance	200	1	\$8.76	\$1,752.00	4	1	\$8.76	\$35.04
Permit	Plumbing Permit	additional fixtures or appliances	200	11	\$3.58	\$7,876.00	4	11	\$3.58	\$157.52
Permit	Gas Service	base per each light fixtures, outlets, switches and receptacles	200	1	\$8.76	\$1,752.00	4	1	\$8.76	\$35.04
Permit	Electrical	Ceiling Fan	200	30	\$0.46	\$2,760.00	4	30	\$0.46	\$55.20
Permit	Electrical	Vent Fan	200	4	\$1.27	\$1,016.00	4	4	\$1.27	\$20.32
Permit	Electrical	Smoke Detectors	200	1	\$1.27	\$254.00	4	1	\$1.27	\$5.08
Permit	Electrical	Detectors	200	7	\$1.27	\$1,778.00	4	7	\$1.27	\$35.56
Permit	Electrical	Disposal	200	1	\$1.27	\$254.00	4	1	\$1.27	\$5.08
Permit	Electrical	Dishwasher	200	1	\$1.27	\$254.00	4	1	\$1.27	\$5.08
Permit	Electrical	Washing Machine	200	1	\$1.27	\$254.00	4	1	\$1.27	\$5.08
Permit	Electrical	Water Heater	200	1	\$2.54	\$508.00	4	1	\$2.54	\$10.16
Permit	Electrical	Dryer	200	1	\$2.54	\$508.00	4	1	\$2.54	\$10.16
Permit	Electrical	Range	200	1	\$2.54	\$508.00	4	1	\$2.54	\$10.16
Permit	Electrical	Air Conditioner 3 to 5 ton	200	1	\$5.17	\$1,034.00	4	1	\$5.17	\$20.68
Permit	Electrical	Heating Unit, Gas	200	1	\$2.54	\$508.00	4	1	\$2.54	\$10.16
<b>Tap fee</b>		<b>Total</b>				<b>\$760,000.00</b>				<b>\$15,200.00</b>
<b>Tap fee</b>		<b>Per Unit</b>				<b>\$3,800.00</b>				<b>\$3,800.00</b>
tap fee	wastewater	4 inch	200	1	\$2,000.00	\$400,000.00	4	1	\$2,000.00	\$8,000.00
Tap fee	water	1-inch short unpaved	200	1	\$1,800.00	\$360,000.00	4	1	\$1,800.00	\$7,200.00
<b>impact fee</b>		<b>Total</b>				<b>\$1,310,400.00</b>				<b>\$26,208.00</b>
<b>impact fee</b>		<b>Per Unit</b>				<b>\$6,552.00</b>				<b>\$6,552.00</b>
impact fee	water	5/8 meter	200	1	\$1,758.00	\$351,600.00	4	1	\$1,758.00	\$7,032.00
impact fee	sewer	5/8 meter per single family housing unit	200	1	\$1,044.00	\$208,800.00	4	1	\$1,044.00	\$4,176.00
impact fee	roadway		200	1	\$3,750.00	\$750,000.00	4	1	\$3,750.00	\$15,000.00

## City of Fort Worth – Fee Set with Minimum Impact Fee

Fee Category	Fee name	Fee basis	development, lots, or structures	units of charge	Development Model 1		development, lots, or structures	units of charge	Development Model 2	
					Fort Worth min	Fort Worth min			Fort Worth min	Fort Worth min
					per basis unit fee	total charged			per basis unit fee	total charged
<b>Total Fees</b>						<b>\$1,760,036.00</b>				<b>\$49,694.52</b>
<b>Total Fees per unit</b>						<b>\$8,800.18</b>				<b>\$12,423.63</b>
<b>Comprehensive Plan</b>		<b>Total</b>				<b>\$0.00</b>				<b>\$0.00</b>
<b>Comprehensive Plan</b>		<b>Per Unit</b>				<b>\$0.00</b>				<b>\$0.00</b>
<b>Zoning</b>		<b>Total</b>				<b>\$4,425.00</b>				<b>\$1,200.00</b>
<b>Zoning</b>		<b>Per Unit</b>				<b>\$22.13</b>				<b>\$300.00</b>
Zoning	Zoning Review	per acre more than 25 acres	1	15	\$75.00	\$1,125.00	0	0	\$75.00	\$0.00
Zoning	Zoning Review	0-1 acres	0	0	\$1,200.00	\$0.00	1	1	\$1,200.00	\$1,200.00
Zoning	Zoning Review	1-5 acres	0	0	\$1,800.00	\$0.00	0	0	\$1,800.00	\$0.00
Zoning	Zoning Review	5.01-10 acres	0	0	\$2,700.00	\$0.00	0	0	\$2,700.00	\$0.00
Zoning	Zoning Review	10.01-25 acres	0	0	\$3,300.00	\$0.00	0	0	\$3,300.00	\$0.00
Zoning	Zoning Review	25.01 or more acres	1	1	\$3,300.00	\$3,300.00	0	0	\$3,300.00	\$0.00
<b>Subdivision</b>		<b>Total</b>				<b>\$12,385.00</b>				<b>\$3,565.00</b>
<b>Subdivision</b>		<b>Per Unit</b>				<b>\$61.93</b>				<b>\$891.25</b>
Subdivision	Preliminary Plan	development	1	1	\$850.00	\$850.00	1	1	\$850.00	\$850.00
Subdivision	Preliminary Plan	per lot	200	1	\$15.00	\$3,000.00	4	1	\$15.00	\$60.00
Subdivision	Concept Plan	development	1	1	\$900.00	\$900.00	1	1	\$900.00	\$900.00
Subdivision	Final Plat	development	1	1	\$385.00	\$385.00	1	1	\$385.00	\$385.00
Subdivision	Final Plat	per lot	200	1	\$30.00	\$6,000.00	4	1	\$30.00	\$120.00
Subdivision	Drainage Study Review	development	1	1	\$1,250.00	\$1,250.00	1	1	\$1,250.00	\$1,250.00
<b>Dedication Fee in Lieu</b>		<b>Total</b>				<b>\$52,650.00</b>				<b>\$10,530.00</b>
<b>Dedication Fee in Lieu</b>		<b>Per Unit</b>				<b>\$263.25</b>				<b>\$2,632.50</b>
Dedication Fee in Lieu	Neighborhood Based Park Development Fee	per single family unit	200	1	\$263.25	\$52,650.00	40	1	\$263.25	\$10,530.00
<b>Site Plan</b>		<b>Total</b>				<b>\$600.00</b>				<b>\$600.00</b>
<b>Site Plan</b>		<b>Per Unit</b>				<b>\$3.00</b>				<b>\$150.00</b>
Site plan	Site Development Plan	development	1	1	\$600.00	\$600.00	1	1	\$600.00	\$600.00
<b>Permit</b>		<b>Total</b>				<b>\$170,776.00</b>				<b>\$3,415.52</b>
<b>Permit</b>		<b>Per Unit</b>				<b>\$853.88</b>				<b>\$853.88</b>
Permit	Building	per structure of 0-700 sf	0	0	\$76.86	\$0.00	0	0	\$76.86	\$0.00
Permit	Building	per sf between 0-700 sf	0	0	\$0.56	\$0.00	0	0	\$0.56	\$0.00
Permit	Building	per structure of 700-1400 sf	0	0	\$430.51	\$0.00	0	0	\$430.51	\$0.00
Permit	Building	per sf between 700-1400 sf	0	0	\$0.40	\$0.00	0	0	\$0.40	\$0.00
Permit	Building	per structure of 1400-2700 sf	200	1	\$708.14	\$141,628.00	4	1	\$708.14	\$2,832.56



Permit	Building	per sf between 1400-2700 sf	200	100	\$0.30	\$5,990.00	4	100	\$0.30	\$119.80
Permit	Building	per structure of 2700- 11800 sf	0	0	\$1,092.53	\$0.00	0	0	\$1,092.53	\$0.00
Permit	Building	per sf between 2700-11800 sf	0	0	\$0.26	\$0.00	0	0	\$0.26	\$0.00
Permit	Building	per structure of 11800- 24500 sf	0	0	\$3,484.33	\$0.00	0	0	\$3,484.33	\$0.00
Permit	Building	per sf between 11800-24500 sf	0	0	\$0.20	\$0.00	0	0	\$0.20	\$0.00
Permit	Building	per structure of 24500- sf	0	0	\$6,047.01	\$0.00	0	0	\$6,047.01	\$0.00
Permit	Building	per sf between 24500- sf	0	0	\$0.15	\$0.00	0	0	\$0.15	\$0.00
Permit	HVAC	per furnace of less than	200	1	\$5.14	\$1,028.00	4	1	\$5.14	\$20.56
Permit	HVAC	per A/C unit	200	1	\$5.57	\$1,114.00	4	1	\$5.57	\$22.28
Permit	Plumbing	first fixture or appliance	200	1	\$8.76	\$1,752.00	4	1	\$8.76	\$35.04
Permit	Plumbing Permit	additional fixtures or appliances	200	11	\$3.58	\$7,876.00	4	11	\$3.58	\$157.52
Permit	Gas Service	base per each light fixtures, outlets, switches and receptacles	200	1	\$8.76	\$1,752.00	4	1	\$8.76	\$35.04
Permit	Electrical	Ceiling Fan	200	4	\$1.27	\$1,016.00	4	4	\$1.27	\$20.32
Permit	Electrical	Vent Fan	200	1	\$1.27	\$254.00	4	1	\$1.27	\$5.08
Permit	Electrical	Smoke Detectors	200	7	\$1.27	\$1,778.00	4	7	\$1.27	\$35.56
Permit	Electrical	Disposal	200	1	\$1.27	\$254.00	4	1	\$1.27	\$5.08
Permit	Electrical	Dishwasher	200	1	\$1.27	\$254.00	4	1	\$1.27	\$5.08
Permit	Electrical	Washing Machine	200	1	\$1.27	\$254.00	4	1	\$1.27	\$5.08
Permit	Electrical	Water Heater	200	1	\$2.54	\$508.00	4	1	\$2.54	\$10.16
Permit	Electrical	Dryer	200	1	\$2.54	\$508.00	4	1	\$2.54	\$10.16
Permit	Electrical	Range	200	1	\$2.54	\$508.00	4	1	\$2.54	\$10.16
Permit	Electrical	Air Conditioner 3 to 5 ton	200	1	\$5.17	\$1,034.00	4	1	\$5.17	\$20.68
Permit	Electrical	Heating Unit, Gas	200	1	\$2.54	\$508.00	4	1	\$2.54	\$10.16
<b>Tap fee</b>		<b>Total</b>				<b>\$760,000.00</b>				<b>\$15,200.00</b>
<b>Tap fee</b>		<b>Per Unit</b>				<b>\$3,800.00</b>				<b>\$3,800.00</b>
tap fee	wastewater	4 inch	200	1	\$2,000.00	\$400,000.00	4	1	\$2,000.00	\$8,000.00
Tap fee	water	1-inch short unpaved	200	1	\$1,800.00	\$360,000.00	4	1	\$1,800.00	\$7,200.00
<b>impact fee</b>		<b>Total</b>				<b>\$759,200.00</b>				<b>\$15,184.00</b>
<b>impact fee</b>		<b>Per Unit</b>				<b>\$3,796.00</b>				<b>\$3,796.00</b>
impact fee	water	5/8 meter	200	1	\$1,758.00	\$351,600.00	4	1	\$1,758.00	\$7,032.00
impact fee	sewer	5/8 meter per single family housing unit	200	1	\$1,044.00	\$208,800.00	4	1	\$1,044.00	\$4,176.00
impact fee	roadway		200	1	\$994.00	\$198,800.00	4	1	\$994.00	\$3,976.00

# Liberty Hill – Fee Set

Fee Category	Fee name	Fee basis	Development Model 1				Development Model 2			
			development, lots, or structures	units of charge	per basis unit fee	total charged	development, lots, or structures	units of charge	per basis unit fee	total charged
<b>Total Fees</b>						<b>4,077,595.50</b>				<b>88,036.00</b>
<b>Total Fees per unit</b>						<b>20,387.98</b>				<b>22,009.00</b>
<b>Comprehensive Plan</b>		<b>Total</b>				<b>0.00</b>				<b>0.00</b>
<b>Comprehensive Plan</b>		<b>Per Unit</b>				<b>0.00</b>				<b>0.00</b>
<b>Zoning</b>		<b>Total</b>				<b>383.00</b>				<b>383.00</b>
<b>Zoning</b>		<b>Per Unit</b>				<b>1.92</b>				<b>95.75</b>
Zoning	Zoning Review	development	1	1	325.00	325.00	1	1	325.00	325.00
Zoning	Zoning change owner notification	per owner	1	100	0.58	58.00	1	100	0.58	58.00
<b>Subdivision</b>		<b>Total</b>				<b>14,500.00</b>				<b>4,700.00</b>
<b>Subdivision</b>		<b>Per Unit</b>				<b>72.50</b>				<b>1,175.00</b>
Subdivision	Pre-Development Meeting	development	1	1	250.00	250.00	1	1	250.00	250.00
Subdivision	Completeness Review	development	1	1	500.00	500.00	1	1	500.00	500.00
Subdivision	Preliminary Plat	development per lot or acre	1	1	1,500.00	1,500.00	1	1	1,500.00	1,500.00
Subdivision	Preliminary Plat	greater	200	1	25.00	5,000.00	4	1	25.00	100.00
Subdivision	Final Plat	development per lot or acre	1	1	750.00	750.00	1	1	750.00	750.00
Subdivision	Final Plat	greater	200	1	25.00	5,000.00	4	1	25.00	100.00
Subdivision	Construction Plan Review	development per \$ of total construction costs	1	1	1,500.00	1,500.00	1	1	1,500.00	1,500.00
Subdivision	Construction Inspection		0	0	0.04	0.00	0	0	0.04	0.00
<b>Dedication Fee in Lieu</b>		<b>Total</b>				<b>160,000.00</b>				<b>4,000.00</b>
<b>Dedication Fee in Lieu</b>		<b>Per Unit</b>				<b>800.00</b>				<b>1,000.00</b>
Dedication Fee in Lieu	Parkland Dedication	development land value	40	50000	0.08	160,000.00	1	50000	0.08	4,000.00
<b>Site Plan</b>		<b>Total</b>				<b>12,712.50</b>				<b>1,153.00</b>
<b>Site Plan</b>		<b>Per Unit</b>				<b>63.56</b>				<b>288.25</b>
Site Plan	Construction Plan Review	per sf impervious cover up to 50000 sf	1	50000	0.04	2,000.00	1	3825	0.04	153.00
Site Plan	Construction Plan Review	per sf impervious cover between 50000 and 100000	1	50000	0.02	1,000.00	1	0	0.02	0.00
Site Plan	Construction Plan Review	per sf impervious cover between 100000 and 200000	1	91250	0.01	912.50	1	0	0.01	0.00
Site Plan	Review fee	development Per acre after 1st	1	1	1,000.00	1,000.00	1	1	1,000.00	1,000.00
Site Plan	Review fee		1	39	200.00	7,800.00	1	0	200.00	0.00
<b>Permit</b>		<b>Total</b>				<b>270,000.00</b>				<b>5,400.00</b>



<b>Permit</b>		<b>Per Unit</b>			<b>1,350.00</b>				<b>1,350.00</b>	
Permit	plan review	per structure up to 5000 sf	200	1	100.00	20,000.00	4	1	100.00	400.00
Permit	plan review	per structure over 5001 sf	0	0	150.00	0.00	0	0	150.00	0.00
permit	plan review	per sf greater than 5001	0	0	0.10	0.00	0	0	0.10	0.00
Permit	Building Permit	per structure up to 5000 sf	200	1	1,250.00	250,000.00	4	1	1,250.00	5,000.00
Permit	Building Permit	per structure over 5001 sf	0	0	1,250.00	0.00	0	0	1,250.00	0.00
Permit	Building Permit	per sf greater than 5001	0	0	0.10	0.00	0	0	0.10	0.00
<b>Tap fee</b>		<b>Total</b>				<b>1,520,000.00</b>				<b>30,400.00</b>
<b>Tap fee</b>		<b>Per Unit</b>				<b>7,600.00</b>				<b>7,600.00</b>
Tap fee	wastewater	base	200	1	600.00	120,000.00	4	1	600.00	2,400.00
Tap fee	water	LUE	200	1	3,500.00	700,000.00	4	1	3,500.00	14,000.00
Tap fee	wastewater	LUE	200	1	3,500.00	700,000.00	4	1	3,500.00	14,000.00
<b>impact fee</b>		<b>Total</b>				<b>2,100,000.00</b>				<b>42,000.00</b>
<b>impact fee</b>		<b>Per Unit</b>				<b>10,500.00</b>				<b>10,500.00</b>
impact fee	water	5/8 meter	200	1	6,500.00	1,300,000.00	4	1	6,500.00	26,000.00
impact fee	sewer	5/8 meter	200	1	4,000.00	800,000.00	4	1	4,000.00	16,000.00

## City of Manor – Fee Set

Fee Category	Fee name	Fee basis	Development Model 1				Development Model 2			
			development, lots, or structures	units of charge	per basis unit fee	total charged	development, lots, or structures	units of charge	per basis unit fee	total charged
<b>Total Fees</b>						<b>\$1,829,790.00</b>				<b>\$44,043.00</b>
<b>Total Fees per unit</b>						<b>\$9,148.95</b>				<b>\$11,010.75</b>
<b>Comprehensive Plan</b>		<b>Total</b>				<b>\$0.00</b>				<b>\$0.00</b>
<b>Comprehensive Plan</b>		<b>Per Unit</b>				<b>\$0.00</b>				<b>\$0.00</b>
<b>Zoning</b>		<b>Total</b>				<b>\$2,165.00</b>				<b>\$995.00</b>
<b>Zoning</b>		<b>Per Unit</b>				<b>\$10.83</b>				<b>\$248.75</b>
Zoning	Zoning Review	development	1	1	\$465.00	\$465.00	1	1	\$465.00	\$465.00
Zoning	Zoning Review	per acre	1	40	\$30.00	\$1,200.00	1	1	\$30.00	\$30.00
Zoning	Zoning change owner notification	per owner	1	100	\$5.00	\$500.00	1	100	\$5.00	\$500.00
<b>Subdivision</b>		<b>Total</b>				<b>\$19,175.00</b>				<b>\$6,435.00</b>
<b>Subdivision</b>		<b>Per Unit</b>				<b>\$95.88</b>				<b>\$1,608.75</b>
Subdivision	Preliminary Plan	development	1	1	\$1,450.00	\$1,450.00	1	1	\$1,450.00	\$1,450.00
Subdivision	Preliminary Plan	per lot	200	1	\$10.00	\$2,000.00	4	1	\$10.00	\$40.00
Subdivision	Preliminary Plan	owner notification	1	100	\$5.00	\$500.00	1	100	\$5.00	\$500.00
Subdivision	Short form plat	development	1	1	\$725.00	\$725.00	1	1	\$725.00	\$725.00
Subdivision	Short form plat	per lot	200	1	\$5.00	\$1,000.00	4	1	\$5.00	\$20.00
Subdivision	Concept Plan	development	1	1	\$1,200.00	\$1,200.00	1	1	\$1,200.00	\$1,200.00
Subdivision	Concept Plan	per lot	200	1	\$10.00	\$2,000.00	4	1	\$10.00	\$40.00
Subdivision	Concept Plan	per owner	1	100	\$5.00	\$500.00	1	100	\$5.00	\$500.00
Subdivision	Final Plat	development	1	1	\$1,800.00	\$1,800.00	1	1	\$1,800.00	\$1,800.00
Subdivision	Final Plat	per lot	200	1	\$40.00	\$8,000.00	4	1	\$40.00	\$160.00
<b>Dedication Fee in Lieu</b>		<b>Total</b>				<b>\$110,000.00</b>				<b>\$2,200.00</b>
<b>Dedication Fee in Lieu</b>		<b>Per Unit</b>				<b>\$550.00</b>				<b>\$550.00</b>
Dedication Fee in Lieu	Land Dedication	per residential unit	200	1	\$550.00	\$110,000.00	4	1	\$550.00	\$2,200.00
<b>Site Plan</b>		<b>Total</b>				<b>\$1,050.00</b>				<b>\$465.00</b>
<b>Site Plan</b>		<b>Per Unit</b>				<b>\$5.25</b>				<b>\$116.25</b>
Site plan	Site Development Plan	development	1	1	\$450.00	\$450.00	1	1	\$450.00	\$450.00
Site plan	Site Development Plan	Per acre	1	40	\$15.00	\$600.00	1	1	\$15.00	\$15.00
<b>Permit</b>		<b>Total</b>				<b>\$323,000.00</b>				<b>\$6,460.00</b>
<b>Permit</b>		<b>Per Unit</b>				<b>\$1,615.00</b>				<b>\$1,615.00</b>
Permit	Building Permit	per structure	200	1	\$90.00	\$18,000.00	4	1	\$90.00	\$360.00
Permit	Building Permit	per structure per sf	200	1500	\$0.60	\$180,000.00	4	1500	\$0.60	\$3,600.00
Permit	Driveway	per structure	200	1	\$95.00	\$19,000.00	4	1	\$95.00	\$380.00
Permit	Electrical	per structure	200	1	\$105.00	\$21,000.00	4	1	\$105.00	\$420.00

Permit	Plumbing	per structure	200	1	\$105.00	\$21,000.00	4	1	\$105.00	\$420.00
Permit	mechanical	per structure	200	1	\$105.00	\$21,000.00	4	1	\$105.00	\$420.00
Permit	Foundation	per structure	200	1	\$95.00	\$19,000.00	4	1	\$95.00	\$380.00
Permit	Certificate of Occupancy	per structure	200	1	\$120.00	\$24,000.00	4	1	\$120.00	\$480.00
<b>Tap fee</b>		<b>Total</b>				<b>\$300,000.00</b>				<b>\$6,000.00</b>
<b>Tap fee</b>		<b>Per Unit</b>				<b>\$1,500.00</b>				<b>\$1,500.00</b>
Tap fee	water	base	200	1	\$750.00	\$150,000.00	4	1	\$750.00	\$3,000.00
Tap fee	wastewater	base	200	1	\$750.00	\$150,000.00	4	1	\$750.00	\$3,000.00
<b>impact fee</b>		<b>Total</b>				<b>\$1,074,400.00</b>				<b>\$21,488.00</b>
<b>impact fee</b>		<b>Per Unit</b>				<b>\$5,372.00</b>				<b>\$5,372.00</b>
impact fee	water	5/8 meter	200	1	\$1,325.00	\$265,000.00	4	1	\$1,325.00	\$5,300.00
impact fee	sewer	5/8 meter	200	1	\$4,047.00	\$809,400.00	4	1	\$4,047.00	\$16,188.00



## City of Pflugerville – Fee Set with Minimum Impact Fee

Fee Category	Fee name	Fee basis	development, lots, or structures	units of charge	Development Model 1		Development Model 2		total charged	total charged
					Pflugerville min	Pflugerville min	Pflugerville min	Pflugerville min		
					per basis unit fee		development, lots, or structures	units of charge	per basis unit fee	
<b>Total Fees</b>										<b>\$1,715,997.60</b>
<b>Total Fees per unit</b>										<b>\$8,579.99</b>
<b>Comprehensive Plan</b>		<b>Total</b>								<b>\$1,000.00</b>
<b>Comprehensive Plan</b>		<b>Per Unit</b>								<b>\$5.00</b>
Comprehensive Plan	Comprehensive Plan Amendment	development	1	1	\$1,000.00	\$1,000.00	1	1	\$1,000.00	\$1,000.00
<b>Zoning</b>		<b>Total</b>								<b>\$2,500.00</b>
<b>Zoning</b>		<b>Per Unit</b>								<b>\$12.50</b>
Zoning	Rezoning	less than 5 acres	0	0	\$500.00	\$0.00	1	1	\$500.00	\$500.00
Zoning	Rezoning	5 to 10 acres	0	0	\$1,000.00	\$0.00	0	0	\$1,000.00	\$0.00
Zoning	Rezoning	10 or more acres	1	1	\$2,500.00	\$2,500.00	0	0	\$2,500.00	\$0.00
<b>Subdivision</b>		<b>Total</b>								<b>\$9,000.00</b>
<b>Subdivision</b>		<b>Per Unit</b>								<b>\$45.00</b>
Subdivision	Preliminary Plan	per lot	200	1	\$30.00	\$6,000.00	4	1	\$30.00	\$120.00
Subdivision	Final Plat	per lot	200	1	\$15.00	\$3,000.00	4	1	\$15.00	\$60.00
<b>Dedication Fee in Lieu</b>		<b>Total</b>								<b>\$172,497.60</b>
<b>Dedication Fee in Lieu</b>		<b>Per Unit</b>								<b>\$862.49</b>
Dedication Fee in Lieu	Parkland Dedication	per single family unit	200	1	\$862.49	\$172,497.60	4	1	\$862.49	\$3,449.95
<b>Site Plan</b>		<b>Total</b>								<b>\$210,500.00</b>
<b>Site Plan</b>		<b>Per Unit</b>								<b>\$1,052.50</b>
Site Plan	Public Improvement Construction Plan Review	per development	1	1	\$500.00	\$500.00	1	1	\$500.00	\$500.00
Site Plan	Public Improvement Construction Plan Review	estimated value of improvements	1	6E+06	\$0.04	\$210,000.00	1	1E+05	\$0.04	\$4,200.00
<b>Permit</b>		<b>Total</b>								<b>\$146,000.00</b>
<b>Permit</b>		<b>Per Unit</b>								<b>\$730.00</b>
Permit	plan review	per structure	200	1	\$70.00	\$14,000.00	4	1	\$70.00	\$280.00
Permit	Building Permit	per structure per sf	200	1500	\$0.32	\$96,000.00	4	1500	\$0.32	\$1,920.00
Permit	Electrical	per structure	200	1	\$60.00	\$12,000.00	4	1	\$60.00	\$240.00
Permit	Plumbing	per structure	200	1	\$60.00	\$12,000.00	4	1	\$60.00	\$240.00
Permit	mechanical	per structure	200	1	\$60.00	\$12,000.00	4	1	\$60.00	\$240.00
<b>Tap fee</b>		<b>Total</b>								<b>\$195,000.00</b>
<b>Tap fee</b>		<b>Per Unit</b>								<b>\$975.00</b>
Tap fee	water	5/8 meter	200	1	\$350.00	\$70,000.00	4	1	\$350.00	\$1,400.00
tap fee	water meter	5/8 meter	200	1	\$125.00	\$25,000.00	4	1	\$125.00	\$500.00

Tap fee	water	base	200	1	\$250.00	\$50,000.00	4	1	\$250.00	\$1,000.00
Tap fee	wastewater	base	200	1	\$250.00	\$50,000.00	4	1	\$250.00	\$1,000.00
<b>impact fee</b>		<b>Total</b>				<b>\$979,500.00</b>				<b>\$19,590.00</b>
<b>impact fee</b>		<b>Per Unit</b>				<b>\$4,897.50</b>				<b>\$4,897.50</b>
impact fee	water	5/8 meter	200	1	\$3,948.50	\$789,700.00	4	1	\$3,948.50	\$15,794.00
impact fee	sewer	5/8 meter	200	1	\$949.00	\$189,800.00	4	1	\$949.00	\$3,796.00



## City of Pflugerville – Fee Set with Maximum Impact Fee

Fee Category	Fee name	Fee basis	Development Model 1 Pflugerville max				Development Model 2 Pflugerville max			
			development, lots, or structures	units of charge	per basis unit fee	total charged	development, lots, or structures	units of charge	per basis unit fee	total charged
<b>Total Fees</b>						<b>\$2,344,597.60</b>				<b>\$49,111.95</b>
<b>Total Fees per unit</b>						<b>\$11,722.99</b>				<b>\$12,277.99</b>
<b>Comprehensive Plan</b>		<b>Total</b>				<b>\$1,000.00</b>				<b>\$1,000.00</b>
<b>Comprehensive Plan</b>		<b>Per Unit</b>				<b>\$5.00</b>				<b>\$250.00</b>
Comprehensive Plan	Comprehensive Plan Amendment	development	1	1	\$1,000.00	\$1,000.00	1	1	\$1,000.00	\$1,000.00
<b>Zoning</b>		<b>Total</b>				<b>\$2,500.00</b>				<b>\$500.00</b>
<b>Zoning</b>		<b>Per Unit</b>				<b>\$12.50</b>				<b>\$125.00</b>
Zoning	Rezoning	less than 5 acres	0	0	\$500.00	\$0.00	1	1	\$500.00	\$500.00
Zoning	Rezoning	5 to 10 acres	0	0	\$1,000.00	\$0.00	0	0	\$1,000.00	\$0.00
Zoning	Rezoning	10 or more acres	1	1	\$2,500.00	\$2,500.00	0	0	\$2,500.00	\$0.00
<b>Subdivision</b>		<b>Total</b>				<b>\$9,000.00</b>				<b>\$480.00</b>
<b>Subdivision</b>		<b>Per Unit</b>				<b>\$45.00</b>				<b>\$120.00</b>
Subdivision	Preliminary Plan	per lot	200	1	\$30.00	\$6,000.00	4	1	\$30.00	\$120.00
Subdivision	Concept Plan neighbor notification	development	1	1			1	1	\$300.00	\$300.00
Subdivision	Final Plat	per lot	200	1	\$15.00	\$3,000.00	4	1	\$15.00	\$60.00
<b>Dedication Fee in Lieu</b>		<b>Total</b>				<b>\$172,497.60</b>				<b>\$3,449.95</b>
<b>Dedication Fee in Lieu</b>		<b>Per Unit</b>				<b>\$862.49</b>				<b>\$862.49</b>
Dedication Fee in Lieu	Parkland Dedication	per single family unit	200	1	\$862.49	\$172,497.60	4	1	\$862.49	\$3,449.95
<b>Site Plan</b>		<b>Total</b>				<b>\$210,500.00</b>				<b>\$4,700.00</b>
<b>Site Plan</b>		<b>Per Unit</b>				<b>\$1,052.50</b>				<b>\$1,175.00</b>
Site Plan	Public Improvement Construction Plan Review	per development	1	1	\$500.00	\$500.00	1	1	\$500.00	\$500.00
Site Plan	Public Improvement Construction Plan Review	estimated value of improvements	1	6E+06	\$0.04	\$210,000.00	1	1E+05	\$0.04	\$4,200.00
<b>Permit</b>		<b>Total</b>				<b>\$146,000.00</b>				<b>\$2,920.00</b>
<b>Permit</b>		<b>Per Unit</b>				<b>\$730.00</b>				<b>\$730.00</b>
Permit	plan review	per structure	200	1	\$70.00	\$14,000.00	4	1	\$70.00	\$280.00
Permit	Building Permit	per structure per sf	200	1500	\$0.32	\$96,000.00	4	1500	\$0.32	\$1,920.00
Permit	Electrical	per structure	200	1	\$60.00	\$12,000.00	4	1	\$60.00	\$240.00
Permit	Plumbing	per structure	200	1	\$60.00	\$12,000.00	4	1	\$60.00	\$240.00
Permit	mechanical	per structure	200	1	\$60.00	\$12,000.00	4	1	\$60.00	\$240.00
<b>Tap fee</b>		<b>Total</b>				<b>\$195,000.00</b>				<b>\$3,900.00</b>
<b>Tap fee</b>		<b>Per Unit</b>				<b>\$975.00</b>				<b>\$975.00</b>
Tap fee	water	5/8 meter	200	1	\$350.00	\$70,000.00	4	1	\$350.00	\$1,400.00



tap fee	water meter	5/8 meter	200	1	\$125.00	\$25,000.00	4	1	\$125.00	\$500.00
Tap fee	water	base	200	1	\$250.00	\$50,000.00	4	1	\$250.00	\$1,000.00
Tap fee	wastewater	base	200	1	\$250.00	\$50,000.00	4	1	\$250.00	\$1,000.00
<b>impact fee</b>		<b>Total</b>				<b>\$1,608,100.00</b>				<b>\$32,162.00</b>
<b>impact fee</b>		<b>Per Unit</b>				<b>\$8,040.50</b>				<b>\$8,040.50</b>
impact fee	water	5/8 meter	200	1	\$3,948.50	\$789,700.00	4	1	\$3,948.50	\$15,794.00
impact fee	sewer	5/8 meter	200	1	\$4,092.00	\$818,400.00	4	1	\$4,092.00	\$16,368.00



# City of Round Rock – Fee Set

Fee Category	Fee name	Fee basis	Development Model 1				Development Model 2			
			development, lots, or structures	units of charge	per basis unit fee	total charged	development, lots, or structures	units of charge	per basis unit fee	total charged
<b>Total Fees</b>						<b>\$2,178,166.00</b>				<b>\$45,023.12</b>
<b>Total Fees per unit</b>						<b>\$10,890.83</b>				<b>\$11,255.78</b>
<b>Comprehensive Plan</b>		<b>Total</b>				<b>\$0.00</b>				<b>\$0.00</b>
<b>Comprehensive Plan</b>		<b>Per Unit</b>				<b>\$0.00</b>				<b>\$0.00</b>
<b>Zoning</b>		<b>Total</b>				<b>\$1,020.00</b>				<b>\$1,020.00</b>
<b>Zoning</b>		<b>Per Unit</b>				<b>\$5.10</b>				<b>\$255.00</b>
Zoning	Rezoning	less than or equal to 30 acres	0	0	\$1,050.00	\$0.00	1	1	\$900.00	\$900.00
Zoning	Rezoning	greater than 30 acres	1	1	\$900.00	\$900.00	0	0	\$1,200.00	\$0.00
Zoning	Zoning change owner notification	per owner	1	100	\$1.00	\$100.00	1	100	\$1.00	\$100.00
Zoning	Zoning change signage fee	1 sign per road frontage	1	1	\$20.00	\$20.00	1	1	\$20.00	\$20.00
<b>Subdivision</b>		<b>Total</b>				<b>\$12,990.00</b>				<b>\$400.00</b>
<b>Subdivision</b>		<b>Per Unit</b>				<b>\$64.95</b>				<b>\$100.00</b>
Subdivision	Concept Plan	development	1	1	\$500.00	\$500.00	1	1		
Subdivision	Concept Plan	per acre	1	40	\$25.00	\$1,000.00	1	1		
Subdivision	Concept Plan neighbor notification	development	1	1	\$390.00	\$390.00	1	1	\$300.00	\$300.00
Subdivision	Final Plat	legal fee	1	1	\$100.00	\$100.00	1	1	\$100.00	\$100.00
<b>Dedication Fee in Lieu</b>		<b>Total</b>				<b>\$64,000.00</b>				<b>\$1,600.00</b>
<b>Dedication Fee in Lieu</b>		<b>Per Unit</b>				<b>\$320.00</b>				<b>\$400.00</b>
Dedication Fee in Lieu	Parkland Dedication	per acre	40	1	\$1,600.00	\$64,000.00	1	1	\$1,600.00	\$1,600.00
<b>Site Plan</b>		<b>Total</b>				<b>\$90,000.00</b>				<b>\$1,800.00</b>
<b>Site Plan</b>		<b>Per Unit</b>				<b>\$450.00</b>				<b>\$450.00</b>
Site Plan	Public Improvement Construction Plan Review	estimated value of improvements	1	6E+06	\$0.02	\$90,000.00	1	1E+05	\$0.02	\$1,800.00
<b>Permit</b>		<b>Total</b>				<b>\$57,000.00</b>				<b>\$1,140.00</b>
<b>Permit</b>		<b>Per Unit</b>				<b>\$285.00</b>				<b>\$285.00</b>
Building Permit application	Permit Fee	Permit Application	200	1	\$285.00	\$57,000.00	4	1	\$285.00	\$1,140.00
<b>Tap fee</b>		<b>Total</b>				<b>\$86,800.00</b>				<b>\$1,736.00</b>
<b>Tap fee</b>		<b>Per Unit</b>				<b>\$434.00</b>				<b>\$434.00</b>
Tap fee	water	5/8 meter	200	1	\$234.00	\$46,800.00	4	1	\$234.00	\$936.00
tap fee	wastewater	connection	200	1	\$200.00	\$40,000.00	4	1	\$200.00	\$800.00
<b>impact fee</b>		<b>Total</b>				<b>\$1,866,356.00</b>				<b>\$37,327.12</b>
<b>impact fee</b>		<b>Per Unit</b>				<b>\$9,331.78</b>				<b>\$9,331.78</b>
impact fee	water	5/8 meter	200	1	\$4,025.00	\$805,000.00	4	1	\$4,025.00	\$16,100.00

impact fee	sewer	5/8 meter	200	1	\$2,099.00	\$419,800.00	4	1	\$2,099.00	\$8,396.00
impact fee	roadway	per single family housing unit	200	1	\$3,207.78	\$641,556.00	4	1	\$3,207.78	\$12,831.12

# City of San Marcos – Fee Set

Fee Category	Fee name	Fee basis	Development Model 1				Development Model 2			
			development, lots, or structures	units of charge	San Marcos per basis unit fee	San Marcos total charged	development, lots, or structures	units of charge	San Marcos per basis unit fee	San Marcos total charged
<b>Total Fees</b>						<b>\$2,178,166.00</b>				<b>\$40,750.00</b>
<b>Total Fees per unit</b>						<b>\$10,890.83</b>				<b>\$10,187.50</b>
<b>Comprehensive Plan</b>		<b>Total</b>				<b>\$13,737.00</b>				<b>\$1,374.00</b>
<b>Comprehensive Plan</b>		<b>Per Unit</b>				<b>\$68.69</b>				<b>\$343.50</b>
Comprehensive Plan	Comprehensive Plan Amendment	development	1	1	\$1,057.00	\$1,057.00	1	1	\$1,057.00	\$1,057.00
Comprehensive Plan	Comprehensive Plan Amendment	per acre	1	40	\$317.00	\$12,680.00	1	1	\$317.00	\$317.00
<b>Zoning</b>		<b>Total</b>				<b>\$5,057.00</b>				<b>\$1,157.00</b>
<b>Zoning</b>		<b>Per Unit</b>				<b>\$25.29</b>				<b>\$289.25</b>
Zoning	Zoning Review	development	1	1	\$1,057.00	\$1,057.00	1	1	\$1,057.00	\$1,057.00
Zoning	Zoning Review	per acre	1	40	\$100.00	\$4,000.00	1	1	\$100.00	\$100.00
<b>Subdivision</b>		<b>Total</b>				<b>\$11,435.00</b>				<b>\$3,635.00</b>
<b>Subdivision</b>		<b>Per Unit</b>				<b>\$57.18</b>				<b>\$908.75</b>
Subdivision	Concept Plan	development	1	1	\$1,057.00	\$1,057.00	1	1	\$1,057.00	\$1,057.00
Subdivision	Concept Plan	per acre	1	40	\$50.00	\$2,000.00	1	1	\$50.00	\$50.00
Subdivision	Preliminary Plat	development	1	1	\$1,057.00	\$1,057.00	1	1	\$1,057.00	\$1,057.00
Subdivision	Preliminary Plat	per acre	1	40	\$50.00	\$2,000.00	1	1	\$50.00	\$50.00
Subdivision	Final Plat	development	1	1	\$1,321.00	\$1,321.00	1	1	\$1,321.00	\$1,321.00
Subdivision	Final Plat	per acre	1	40	\$100.00	\$4,000.00	1	1	\$100.00	\$100.00
<b>Dedication Fee in Lieu</b>		<b>Total</b>				<b>\$163,800.00</b>				<b>\$3,276.00</b>
<b>Dedication Fee in Lieu</b>		<b>Per Unit</b>				<b>\$819.00</b>				<b>\$819.00</b>
Dedication Fee in Lieu	Land Dedication	per residential unit	200	1	\$396.00	\$79,200.00	4	1	\$396.00	\$1,584.00
Dedication Fee in Lieu	parkland Development	per residential unit	200	1	\$423.00	\$84,600.00	4	1	\$423.00	\$1,692.00
<b>Site Plan</b>		<b>Total</b>				<b>\$4,378.00</b>				<b>\$2,428.00</b>
<b>Site Plan</b>		<b>Per Unit</b>				<b>\$21.89</b>				<b>\$607.00</b>
Site Plan	Public Improvement Construction Plan Review	per development	1	1	\$2,378.00	\$2,378.00	1	1	\$2,378.00	\$2,378.00
Site Plan	Public Improvement Construction Plan Review	per acre	1	40	\$50.00	\$2,000.00	1	1	\$50.00	\$50.00
<b>Permit</b>		<b>Total</b>				<b>\$147,000.00</b>				<b>\$2,940.00</b>
<b>Permit</b>		<b>Per Unit</b>				<b>\$735.00</b>				<b>\$735.00</b>
Permit	Building Permit	per structure per sf	200	1500	\$0.49	\$147,000.00	4	1500	\$0.49	\$2,940.00
<b>Tap fee</b>		<b>Total</b>				<b>\$0.00</b>				<b>\$0.00</b>
<b>Tap fee</b>		<b>Per Unit</b>				<b>\$0.00</b>				<b>\$0.00</b>

<b>impact fee</b>		<b>Total</b>				<b>\$1,297,000.00</b>				<b>\$25,940.00</b>
<b>impact fee</b>		<b>Per Unit</b>				<b>\$6,485.00</b>				<b>\$6,485.00</b>
impact fee	water	5/8 meter	200	1	\$3,801.00	\$760,200.00	4	1	\$3,801.00	\$15,204.00
impact fee	sewer	5/8 meter	200	1	\$2,684.00	\$536,800.00	4	1	\$2,684.00	\$10,736.00

# City of San Antonio- Fee Set with Minimum Impact Fee

Fee Category	Fee name	Fee basis	development, lots, or structures	units of charge	Development Model 1		development, lots, or structures	units of charge	Development Model 2	
					San Antonio min	San Antonio min			San Antonio min	San Antonio min
					per basis unit fee	total charged			per basis unit fee	total charged
<b>Total Fees</b>						<b>\$1,840,426.50</b>				<b>\$40,934.75</b>
<b>Total Fees per unit</b>						<b>\$9,202.13</b>				<b>\$10,233.69</b>
<b>Comprehensive Plan</b>	<b>Total</b>					<b>\$0.00</b>				<b>\$0.00</b>
<b>Comprehensive Plan</b>	<b>Per Unit</b>					<b>\$0.00</b>				<b>\$0.00</b>
<b>Zoning</b>	<b>Total</b>					<b>\$7,614.00</b>				<b>\$1,770.00</b>
<b>Zoning</b>	<b>Per Unit</b>					<b>\$38.07</b>				<b>\$442.50</b>
Zoning	Zoning Review	0-0.5 acres	0	0	\$795.00	\$0.00	0	0	\$795.00	\$0.00
Zoning	Zoning Review	0.5-5 acres	0	0	\$1,770.00	\$0.00	1	1	\$1,770.00	\$1,770.00
Zoning	Zoning Review	5-10 acres	0	0	\$3,182.00	\$0.00	0	0	\$3,182.00	\$0.00
Zoning	Zoning Review	10-25 acres	0	0	\$5,620.00	\$0.00	0	0	\$5,620.00	\$0.00
Zoning	Zoning Review	25-50 acres	1	1	\$5,814.00	\$5,814.00	0	0	\$5,814.00	\$0.00
Zoning	Zoning Review	50- acres	0	0	\$5,930.00	\$0.00	0	0	\$5,930.00	\$0.00
Zoning	Zoning Review	per acre more than 25 acres	1	15	\$120.00	\$1,800.00	0	0	\$120.00	\$0.00
<b>Subdivision</b>	<b>Total</b>					<b>\$625.00</b>				<b>\$625.00</b>
<b>Subdivision</b>	<b>Per Unit</b>					<b>\$3.13</b>				<b>\$156.25</b>
Subdivision	Final Plat	development	1	1	\$625.00	\$625.00	1	1	\$625.00	\$625.00
<b>Dedication Fee in Lieu</b>	<b>Total</b>					<b>\$0.00</b>				<b>\$0.00</b>
<b>Dedication Fee in Lieu</b>	<b>Per Unit</b>					<b>\$0.00</b>				<b>\$0.00</b>
<b>Site Plan</b>	<b>Total</b>					<b>\$372,387.50</b>				<b>\$9,343.75</b>
<b>Site Plan</b>	<b>Per Unit</b>					<b>\$1,861.94</b>				<b>\$2,335.94</b>
Site Plan	Stormwater Impervious Cover Tree Preservation Preliminary Plan Review	development	1	2E+05	\$0.15	\$28,687.50	1	3825	\$0.15	\$573.75
Tree Protection	Tree Preservation Validation	development	1	1	\$100.00	\$100.00	1	1	\$100.00	\$100.00
Tree Protection	Tree Permit	per lot, \$2000 maximum	200	1	\$50.00	\$10,000.00	4	1	\$50.00	\$200.00
Tree Protection	Tree Affidavit	per lot, \$1,000 maximum	200	1	\$50.00	\$10,000.00	4	1	\$50.00	\$200.00
Tree Protection	Tree Canopy Enhancement Tree Certification Credit	per lot, \$2000 maximum	200	1	\$15.00	\$3,000.00	4	1	\$15.00	\$60.00
Tree Protection	Tree Certification Credit	development	1	1	\$100.00	\$100.00	1	1	\$100.00	\$100.00
Tree Protection	Tree Certification Credit	per inch	40	10	\$1.00	\$400.00	1	10	\$1.00	\$10.00
Tree Protection	Significant Tree Mitigation	per inch	40	10	\$200.00	\$80,000.00	1	10	\$200.00	\$2,000.00
Tree Protection	Heritage Tree Mitigation	per inch	40	10	\$600.00	\$240,000.00	1	10	\$600.00	\$6,000.00
<b>Permit</b>	<b>Total</b>					<b>\$275,800.00</b>				<b>\$5,516.00</b>

Permit	Per Unit				\$1,379.00				\$1,379.00	
Permit	Building Permit	per structure of 0-500 sf	0	0	\$150.00	\$0.00	0	0	\$150.00	\$0.00
Permit	Building Permit	per structure of 501-1000 sf	0	0	\$425.00	\$0.00	0	0	\$425.00	\$0.00
Permit	Building Permit	per structure of 1001-1250 sf	0	0	\$450.00	\$0.00	0	0	\$450.00	\$0.00
Permit	Building Permit	per structure of 1251-1500 sf	200	1	\$625.00	\$125,000.00	4	1	\$625.00	\$2,500.00
Permit	Building Permit	per structure of 1501-1750 sf	0	0	\$800.00	\$0.00	0	0	\$800.00	\$0.00
Permit	Building Permit	per structure of 1751-2000 sf	0	0	\$850.00	\$0.00	0	0	\$850.00	\$0.00
Permit	Building Permit	per structure of 2001-2250 sf	0	0	\$850.00	\$0.00	0	0	\$850.00	\$0.00
Permit	Building Permit	per structure of 2251-2500 sf	0	0	\$850.00	\$0.00	0	0	\$850.00	\$0.00
Permit	Building Permit	per structure of 2501-3000 sf	0	0	\$880.00	\$0.00	0	0	\$880.00	\$0.00
Permit	Building Permit	per structure of 3001-3500 sf	0	0	\$920.00	\$0.00	0	0	\$920.00	\$0.00
Permit	Building Permit	per structure of 3501-4000 sf	0	0	\$930.00	\$0.00	0	0	\$930.00	\$0.00
Permit	Building Permit	per structure of 4001-5000 sf	0	0	\$1,000.00	\$0.00	0	0	\$1,000.00	\$0.00
Permit	Building Permit	per structure of 5001-6000 sf	0	0	\$1,100.00	\$0.00	0	0	\$1,100.00	\$0.00
Permit	Building Permit	per structure of 6001-6500 sf	0	0	\$1,200.00	\$0.00	0	0	\$1,200.00	\$0.00
Permit	Building Permit	per structure of 6501-7000 sf	0	0	\$1,400.00	\$0.00	0	0	\$1,400.00	\$0.00
Permit	Building Permit	per structure of 7001-7250 sf	0	0	\$1,550.00	\$0.00	0	0	\$1,550.00	\$0.00
Permit	Building Permit	per structure of 7251-7500 sf	0	0	\$1,725.00	\$0.00	0	0	\$1,725.00	\$0.00
Permit	Building Permit	per structure of 7501-7750 sf	0	0	\$1,900.00	\$0.00	0	0	\$1,900.00	\$0.00
Permit	Building Permit	per structure of 7751-9000 sf	0	0	\$2,000.00	\$0.00	0	0	\$2,000.00	\$0.00
Permit	Electrical Permit	per structure of 0-500 sf	0	0	\$100.00	\$0.00	0	0	\$100.00	\$0.00
Permit	Electrical Permit	per structure of 501-1000 sf	0	0	\$100.00	\$0.00	0	0	\$100.00	\$0.00
Permit	Electrical Permit	per structure of 1001-1250 sf	0	0	\$100.00	\$0.00	0	0	\$100.00	\$0.00
Permit	Electrical Permit	per structure of 1251-1500 sf	200	1	\$100.00	\$20,000.00	4	1	\$100.00	\$400.00
Permit	Electrical Permit	per structure of 1501-1750 sf	0	0	\$100.00	\$0.00	0	0	\$100.00	\$0.00
Permit	Electrical Permit	per structure of 1751-2000 sf	0	0	\$100.00	\$0.00	0	0	\$100.00	\$0.00
Permit	Electrical Permit	per structure of 2001-2250 sf	0	0	\$100.00	\$0.00	0	0	\$100.00	\$0.00
Permit	Electrical Permit	per structure of 2251-2500 sf	0	0	\$100.00	\$0.00	0	0	\$100.00	\$0.00
Permit	Electrical Permit	per structure of 2501-3000 sf	0	0	\$110.00	\$0.00	0	0	\$110.00	\$0.00
Permit	Electrical Permit	per structure of 3001-3500 sf	0	0	\$110.00	\$0.00	0	0	\$110.00	\$0.00
Permit	Electrical Permit	per structure of 3501-4000 sf	0	0	\$120.00	\$0.00	0	0	\$120.00	\$0.00
Permit	Electrical Permit	per structure of 4001-5000 sf	0	0	\$125.00	\$0.00	0	0	\$125.00	\$0.00
Permit	Electrical Permit	per structure of 5001-6000 sf	0	0	\$125.00	\$0.00	0	0	\$125.00	\$0.00
Permit	Electrical Permit	per structure of 6001-6500 sf	0	0	\$150.00	\$0.00	0	0	\$150.00	\$0.00
Permit	Electrical Permit	per structure of 6501-7000 sf	0	0	\$150.00	\$0.00	0	0	\$150.00	\$0.00
Permit	Electrical Permit	per structure of 7001-7250 sf	0	0	\$200.00	\$0.00	0	0	\$200.00	\$0.00
Permit	Electrical Permit	per structure of 7251-7500 sf	0	0	\$200.00	\$0.00	0	0	\$200.00	\$0.00

Permit	Electrical Permit	per structure of 7501-7750 sf	0	0	\$200.00	\$0.00	0	0	\$200.00	\$0.00
Permit	Electrical Permit	per structure of 7751-9000 sf	0	0	\$200.00	\$0.00	0	0	\$200.00	\$0.00
Permit	Mechanical Permit	per structure of 0-500 sf	0	0	\$80.00	\$0.00	0	0	\$80.00	\$0.00
Permit	Mechanical Permit	per structure of 501-1000 sf	0	0	\$80.00	\$0.00	0	0	\$80.00	\$0.00
Permit	Mechanical Permit	per structure of 1001-1250 sf	0	0	\$80.00	\$0.00	0	0	\$80.00	\$0.00
Permit	Mechanical Permit	per structure of 1251-1500 sf	200	1	\$80.00	\$16,000.00	4	1	\$80.00	\$320.00
Permit	Mechanical Permit	per structure of 1501-1750 sf	0	0	\$85.00	\$0.00	0	0	\$85.00	\$0.00
Permit	Mechanical Permit	per structure of 1751-2000 sf	0	0	\$85.00	\$0.00	0	0	\$85.00	\$0.00
Permit	Mechanical Permit	per structure of 2001-2250 sf	0	0	\$85.00	\$0.00	0	0	\$85.00	\$0.00
Permit	Mechanical Permit	per structure of 2251-2500 sf	0	0	\$85.00	\$0.00	0	0	\$85.00	\$0.00
Permit	Mechanical Permit	per structure of 2501-3000 sf	0	0	\$85.00	\$0.00	0	0	\$85.00	\$0.00
Permit	Mechanical Permit	per structure of 3001-3500 sf	0	0	\$90.00	\$0.00	0	0	\$90.00	\$0.00
Permit	Mechanical Permit	per structure of 3501-4000 sf	0	0	\$110.00	\$0.00	0	0	\$110.00	\$0.00
Permit	Mechanical Permit	per structure of 4001-5000 sf	0	0	\$140.00	\$0.00	0	0	\$140.00	\$0.00
Permit	Mechanical Permit	per structure of 5001-6000 sf	0	0	\$165.00	\$0.00	0	0	\$165.00	\$0.00
Permit	Mechanical Permit	per structure of 6001-6500 sf	0	0	\$245.00	\$0.00	0	0	\$245.00	\$0.00
Permit	Mechanical Permit	per structure of 6501-7000 sf	0	0	\$245.00	\$0.00	0	0	\$245.00	\$0.00
Permit	Mechanical Permit	per structure of 7001-7250 sf	0	0	\$245.00	\$0.00	0	0	\$245.00	\$0.00
Permit	Mechanical Permit	per structure of 7251-7500 sf	0	0	\$245.00	\$0.00	0	0	\$245.00	\$0.00
Permit	Mechanical Permit	per structure of 7501-7750 sf	0	0	\$250.00	\$0.00	0	0	\$250.00	\$0.00
Permit	Mechanical Permit	per structure of 7751-9000 sf	0	0	\$250.00	\$0.00	0	0	\$250.00	\$0.00
Permit	Plumbing Permit	per structure of 0-500 sf	0	0	\$60.00	\$0.00	0	0	\$60.00	\$0.00
Permit	Plumbing Permit	per structure of 501-1000 sf	0	0	\$119.00	\$0.00	0	0	\$119.00	\$0.00
Permit	Plumbing Permit	per structure of 1001-1250 sf	0	0	\$128.00	\$0.00	0	0	\$128.00	\$0.00
Permit	Plumbing Permit	per structure of 1251-1500 sf	200	1	\$132.00	\$26,400.00	4	1	\$132.00	\$528.00
Permit	Plumbing Permit	per structure of 1501-1750 sf	0	0	\$145.00	\$0.00	0	0	\$145.00	\$0.00
Permit	Plumbing Permit	per structure of 1751-2000 sf	0	0	\$149.00	\$0.00	0	0	\$149.00	\$0.00
Permit	Plumbing Permit	per structure of 2001-2250 sf	0	0	\$151.00	\$0.00	0	0	\$151.00	\$0.00
Permit	Plumbing Permit	per structure of 2251-2500 sf	0	0	\$156.00	\$0.00	0	0	\$156.00	\$0.00
Permit	Plumbing Permit	per structure of 2501-3000 sf	0	0	\$164.00	\$0.00	0	0	\$164.00	\$0.00
Permit	Plumbing Permit	per structure of 3001-3500 sf	0	0	\$178.00	\$0.00	0	0	\$178.00	\$0.00
Permit	Plumbing Permit	per structure of 3501-4000 sf	0	0	\$190.00	\$0.00	0	0	\$190.00	\$0.00
Permit	Plumbing Permit	per structure of 4001-5000 sf	0	0	\$207.00	\$0.00	0	0	\$207.00	\$0.00
Permit	Plumbing Permit	per structure of 5001-6000 sf	0	0	\$223.00	\$0.00	0	0	\$223.00	\$0.00
Permit	Plumbing Permit	per structure of 6001-6500 sf	0	0	\$283.00	\$0.00	0	0	\$283.00	\$0.00
Permit	Plumbing Permit	per structure of 6501-7000 sf	0	0	\$342.00	\$0.00	0	0	\$342.00	\$0.00
Permit	Plumbing Permit	per structure of 7001-7250 sf	0	0	\$351.00	\$0.00	0	0	\$351.00	\$0.00





Permit	Plumbing Permit	per structure of 7251-7500 sf	0	0	\$355.00	\$0.00	0	0	\$355.00	\$0.00
Permit	Plumbing Permit	per structure of 7501-7750 sf	0	0	\$368.00	\$0.00	0	0	\$368.00	\$0.00
Permit	Plumbing Permit	per structure of 7751-9000 sf	0	0	\$372.00	\$0.00	0	0	\$372.00	\$0.00
Permit	Sewer Permit	per structure of 501-1000 sf	0	0	\$64.00	\$0.00	0	0	\$64.00	\$0.00
Permit	Sewer Permit	per structure of 1001-1250 sf	0	0	\$64.00	\$0.00	0	0	\$64.00	\$0.00
Permit	Sewer Permit	per structure of 1251-1500 sf	200	1	\$64.00	\$12,800.00	4	1	\$64.00	\$256.00
Permit	Sewer Permit	per structure of 1501-1750 sf	0	0	\$64.00	\$0.00	0	0	\$64.00	\$0.00
Permit	Sewer Permit	per structure of 1751-2000 sf	0	0	\$64.00	\$0.00	0	0	\$64.00	\$0.00
Permit	Sewer Permit	per structure of 2001-2250 sf	0	0	\$64.00	\$0.00	0	0	\$64.00	\$0.00
Permit	Sewer Permit	per structure of 2251-2500 sf	0	0	\$64.00	\$0.00	0	0	\$64.00	\$0.00
Permit	Sewer Permit	per structure of 2501-3000 sf	0	0	\$64.00	\$0.00	0	0	\$64.00	\$0.00
Permit	Sewer Permit	per structure of 3001-3500 sf	0	0	\$64.00	\$0.00	0	0	\$64.00	\$0.00
Permit	Sewer Permit	per structure of 3501-4000 sf	0	0	\$64.00	\$0.00	0	0	\$64.00	\$0.00
Permit	Sewer Permit	per structure of 4001-5000 sf	0	0	\$64.00	\$0.00	0	0	\$64.00	\$0.00
Permit	Sewer Permit	per structure of 5001-6000 sf	0	0	\$64.00	\$0.00	0	0	\$64.00	\$0.00
Permit	Sewer Permit	per structure of 6001-6500 sf	0	0	\$64.00	\$0.00	0	0	\$64.00	\$0.00
Permit	Sewer Permit	per structure of 6501-7000 sf	0	0	\$64.00	\$0.00	0	0	\$64.00	\$0.00
Permit	Sewer Permit	per structure of 7001-7250 sf	0	0	\$64.00	\$0.00	0	0	\$64.00	\$0.00
Permit	Sewer Permit	per structure of 7251-7500 sf	0	0	\$64.00	\$0.00	0	0	\$64.00	\$0.00
Permit	Sewer Permit	per structure of 7501-7750 sf	0	0	\$64.00	\$0.00	0	0	\$64.00	\$0.00
Permit	Sewer Permit	per structure of 7751-9000 sf	0	0	\$64.00	\$0.00	0	0	\$64.00	\$0.00
Permit	Plan Review	per structure of 501-1000 sf	0	0	\$200.00	\$0.00	0	0	\$200.00	\$0.00
Permit	Plan Review	per structure of 1001-1250 sf	0	0	\$200.00	\$0.00	0	0	\$200.00	\$0.00
Permit	Plan Review	per structure of 1251-1500 sf	200	1	\$200.00	\$40,000.00	4	1	\$200.00	\$800.00
Permit	Plan Review	per structure of 1501-1750 sf	0	0	\$200.00	\$0.00	0	0	\$200.00	\$0.00
Permit	Plan Review	per structure of 1751-2000 sf	0	0	\$200.00	\$0.00	0	0	\$200.00	\$0.00
Permit	Plan Review	per structure of 2001-2250 sf	0	0	\$200.00	\$0.00	0	0	\$200.00	\$0.00
Permit	Plan Review	per structure of 2251-2500 sf	0	0	\$200.00	\$0.00	0	0	\$200.00	\$0.00
Permit	Plan Review	per structure of 2501-3000 sf	0	0	\$200.00	\$0.00	0	0	\$200.00	\$0.00
Permit	Plan Review	per structure of 3001-3500 sf	0	0	\$400.00	\$0.00	0	0	\$400.00	\$0.00
Permit	Plan Review	per structure of 3501-4000 sf	0	0	\$400.00	\$0.00	0	0	\$400.00	\$0.00
Permit	Plan Review	per structure of 4001-5000 sf	0	0	\$400.00	\$0.00	0	0	\$400.00	\$0.00
Permit	Plan Review	per structure of 5001-6000 sf	0	0	\$400.00	\$0.00	0	0	\$400.00	\$0.00
Permit	Plan Review	per structure of 6001-6500 sf	0	0	\$600.00	\$0.00	0	0	\$600.00	\$0.00
Permit	Plan Review	per structure of 6501-7000 sf	0	0	\$600.00	\$0.00	0	0	\$600.00	\$0.00
Permit	Plan Review	per structure of 7001-7250 sf	0	0	\$600.00	\$0.00	0	0	\$600.00	\$0.00
Permit	Plan Review	per structure of 7251-7500 sf	0	0	\$600.00	\$0.00	0	0	\$600.00	\$0.00



Permit	Plan Review	per structure of 7501-7750 sf	0	0	\$600.00	\$0.00	0	0	\$600.00	\$0.00
Permit	Plan Review	per structure of 7751-9000 sf	0	0	\$600.00	\$0.00	0	0	\$600.00	\$0.00
Permit	Temporary electrical panel permit	per structure of 501-1000 sf	0	0	\$57.00	\$0.00	0	0	\$57.00	\$0.00
Permit	Temporary electrical panel permit	per structure of 1001-1250 sf	0	0	\$57.00	\$0.00	0	0	\$57.00	\$0.00
Permit	Temporary electrical panel permit	per structure of 1251-1500 sf	200	1	\$57.00	\$11,400.00	4	1	\$57.00	\$228.00
Permit	Temporary electrical panel permit	per structure of 1501-1750 sf	0	0	\$57.00	\$0.00	0	0	\$57.00	\$0.00
Permit	Temporary electrical panel permit	per structure of 1751-2000 sf	0	0	\$57.00	\$0.00	0	0	\$57.00	\$0.00
Permit	Temporary electrical panel permit	per structure of 2001-2250 sf	0	0	\$57.00	\$0.00	0	0	\$57.00	\$0.00
Permit	Temporary electrical panel permit	per structure of 2251-2500 sf	0	0	\$57.00	\$0.00	0	0	\$57.00	\$0.00
Permit	Temporary electrical panel permit	per structure of 2501-3000 sf	0	0	\$57.00	\$0.00	0	0	\$57.00	\$0.00
Permit	Temporary electrical panel permit	per structure of 3001-3500 sf	0	0	\$57.00	\$0.00	0	0	\$57.00	\$0.00
Permit	Temporary electrical panel permit	per structure of 3501-4000 sf	0	0	\$57.00	\$0.00	0	0	\$57.00	\$0.00
Permit	Temporary electrical panel permit	per structure of 4001-5000 sf	0	0	\$57.00	\$0.00	0	0	\$57.00	\$0.00
Permit	Temporary electrical panel permit	per structure of 5001-6000 sf	0	0	\$57.00	\$0.00	0	0	\$57.00	\$0.00
Permit	Temporary electrical panel permit	per structure of 6001-6500 sf	0	0	\$57.00	\$0.00	0	0	\$57.00	\$0.00
Permit	Temporary electrical panel permit	per structure of 6501-7000 sf	0	0	\$57.00	\$0.00	0	0	\$57.00	\$0.00
Permit	Temporary electrical panel permit	per structure of 7001-7250 sf	0	0	\$57.00	\$0.00	0	0	\$57.00	\$0.00
Permit	Temporary electrical panel permit	per structure of 7251-7500 sf	0	0	\$57.00	\$0.00	0	0	\$57.00	\$0.00
Permit	Temporary electrical panel permit	per structure of 7501-7750 sf	0	0	\$57.00	\$0.00	0	0	\$57.00	\$0.00
Permit	Temporary electrical panel permit	per structure of 7751-9000 sf	0	0	\$57.00	\$0.00	0	0	\$57.00	\$0.00
Permit	Temporary on permanent electrical panel permit	per structure of 501-1000 sf	0	0	\$57.00	\$0.00	0	0	\$57.00	\$0.00
Permit	Temporary on permanent electrical panel permit	per structure of 1001-1250 sf	0	0	\$57.00	\$0.00	0	0	\$57.00	\$0.00
Permit	Temporary on permanent electrical panel permit	per structure of 1251-1500 sf	200	1	\$57.00	\$11,400.00	4	1	\$57.00	\$228.00
Permit	Temporary on permanent electrical panel permit	per structure of 1501-1750 sf	0	0	\$57.00	\$0.00	0	0	\$57.00	\$0.00



Permit	Temporary on permanent electrical panel permit	per structure of 1751-2000 sf	0	0	\$57.00	\$0.00	0	0	\$57.00	\$0.00
Permit	Temporary on permanent electrical panel permit	per structure of 2001-2250 sf	0	0	\$57.00	\$0.00	0	0	\$57.00	\$0.00
Permit	Temporary on permanent electrical panel permit	per structure of 2251-2500 sf	0	0	\$57.00	\$0.00	0	0	\$57.00	\$0.00
Permit	Temporary on permanent electrical panel permit	per structure of 2501-3000 sf	0	0	\$57.00	\$0.00	0	0	\$57.00	\$0.00
Permit	Temporary on permanent electrical panel permit	per structure of 3001-3500 sf	0	0	\$57.00	\$0.00	0	0	\$57.00	\$0.00
Permit	Temporary on permanent electrical panel permit	per structure of 3501-4000 sf	0	0	\$57.00	\$0.00	0	0	\$57.00	\$0.00
Permit	Temporary on permanent electrical panel permit	per structure of 4001-5000 sf	0	0	\$57.00	\$0.00	0	0	\$57.00	\$0.00
Permit	Temporary on permanent electrical panel permit	per structure of 5001-6000 sf	0	0	\$57.00	\$0.00	0	0	\$57.00	\$0.00
Permit	Temporary on permanent electrical panel permit	per structure of 6001-6500 sf	0	0	\$57.00	\$0.00	0	0	\$57.00	\$0.00
Permit	Temporary on permanent electrical panel permit	per structure of 6501-7000 sf	0	0	\$57.00	\$0.00	0	0	\$57.00	\$0.00
Permit	Temporary on permanent electrical panel permit	per structure of 7001-7250 sf	0	0	\$57.00	\$0.00	0	0	\$57.00	\$0.00
Permit	Temporary on permanent electrical panel permit	per structure of 7251-7500 sf	0	0	\$57.00	\$0.00	0	0	\$57.00	\$0.00
Permit	Temporary on permanent electrical panel permit	per structure of 7501-7750 sf	0	0	\$57.00	\$0.00	0	0	\$57.00	\$0.00
Permit	Temporary on permanent electrical panel permit	per structure of 7751-9000 sf	0	0	\$57.00	\$0.00	0	0	\$57.00	\$0.00
Permit	Gas Permit	per structure of 501-1000 sf	0	0	\$64.00	\$0.00	0	0	\$64.00	\$0.00
Permit	Gas Permit	per structure of 1001-1250 sf	0	0	\$64.00	\$0.00	0	0	\$64.00	\$0.00
Permit	Gas Permit	per structure of 1251-1500 sf	200	1	\$64.00	\$12,800.00	4	1	\$64.00	\$256.00
Permit	Gas Permit	per structure of 1501-1750 sf	0	0	\$64.00	\$0.00	0	0	\$64.00	\$0.00
Permit	Gas Permit	per structure of 1751-2000 sf	0	0	\$64.00	\$0.00	0	0	\$64.00	\$0.00
Permit	Gas Permit	per structure of 2001-2250 sf	0	0	\$64.00	\$0.00	0	0	\$64.00	\$0.00
Permit	Gas Permit	per structure of 2251-2500 sf	0	0	\$64.00	\$0.00	0	0	\$64.00	\$0.00
Permit	Gas Permit	per structure of 2501-3000 sf	0	0	\$64.00	\$0.00	0	0	\$64.00	\$0.00
Permit	Gas Permit	per structure of 3001-3500 sf	0	0	\$64.00	\$0.00	0	0	\$64.00	\$0.00
Permit	Gas Permit	per structure of 3501-4000 sf	0	0	\$64.00	\$0.00	0	0	\$64.00	\$0.00



Permit	Gas Permit	per structure of 4001-5000 sf	0	0	\$64.00	\$0.00	0	0	\$64.00	\$0.00
Permit	Gas Permit	per structure of 5001-6000 sf	0	0	\$64.00	\$0.00	0	0	\$64.00	\$0.00
Permit	Gas Permit	per structure of 6001-6500 sf	0	0	\$64.00	\$0.00	0	0	\$64.00	\$0.00
Permit	Gas Permit	per structure of 6501-7000 sf	0	0	\$64.00	\$0.00	0	0	\$64.00	\$0.00
Permit	Gas Permit	per structure of 7001-7250 sf	0	0	\$64.00	\$0.00	0	0	\$64.00	\$0.00
Permit	Gas Permit	per structure of 7251-7500 sf	0	0	\$64.00	\$0.00	0	0	\$64.00	\$0.00
Permit	Gas Permit	per structure of 7501-7750 sf	0	0	\$64.00	\$0.00	0	0	\$64.00	\$0.00
Permit	Gas Permit	per structure of 7751-9000 sf	0	0	\$64.00	\$0.00	0	0	\$64.00	\$0.00
<b>Tap fee</b>		<b>Total</b>				<b>\$0.00</b>			<b>\$0.00</b>	<b>\$0.00</b>
<b>Tap fee</b>		<b>Per Unit</b>				<b>\$0.00</b>			<b>\$0.00</b>	<b>\$0.00</b>
<b>impact fee</b>		<b>Total</b>				<b>\$1,184,000.00</b>				<b>\$23,680.00</b>
<b>impact fee</b>		<b>Per Unit</b>				<b>\$5,920.00</b>				<b>\$5,920.00</b>
impact fee	water	5/8 meter	200	1	\$4,749.00	\$949,800.00	4	1	\$4,749.00	\$18,996.00
impact fee	sewer	5/8 meter	200	1	\$1,171.00	\$234,200.00	4	1	\$1,171.00	\$4,684.00

# City of San Antonio- Fee Set with Maximum Impact Fee

Fee Category	Fee name	Fee basis	development, lots, or structures	units of charge	San Antonio max	San Antonio max	development, lots, or structures	units of charge	San Antonio max	San Antonio max
					per basis unit fee	total charged			per basis unit fee	total charged
<b>Total Fees</b>										
<b>Total Fees per unit</b>										
<b>Comprehensive Plan</b>		<b>Total</b>								
<b>Comprehensive Plan</b>		<b>Per Unit</b>								
<b>Zoning</b>		<b>Total</b>								
<b>Zoning</b>		<b>Per Unit</b>								
Zoning	Zoning Review	0-0.5 acres	0	0	\$795.00	\$0.00	0	0	\$795.00	\$0.00
Zoning	Zoning Review	0.5-5 acres	0	0	\$1,770.00	\$0.00	1	1	\$1,770.00	\$1,770.00
Zoning	Zoning Review	5-10 acres	0	0	\$3,182.00	\$0.00	0	0	\$3,182.00	\$0.00
Zoning	Zoning Review	10-25 acres	0	0	\$5,620.00	\$0.00	0	0	\$5,620.00	\$0.00
Zoning	Zoning Review	25-50 acres	1	1	\$5,814.00	\$5,814.00	0	0	\$5,814.00	\$0.00
Zoning	Zoning Review	50- acres	0	0	\$5,930.00	\$0.00	0	0	\$5,930.00	\$0.00
Zoning	Zoning Review	per acre more than 25 acres	1	15	\$120.00	\$1,800.00	0	0	\$120.00	\$0.00
<b>Subdivision</b>		<b>Total</b>								
<b>Subdivision</b>		<b>Per Unit</b>								
Subdivision	Final Plat	development	1	1	\$625.00	\$625.00	1	1	\$625.00	\$625.00
<b>Dedication Fee in Lieu</b>		<b>Total</b>								
<b>Dedication Fee in Lieu</b>		<b>Per Unit</b>								
<b>Site Plan</b>		<b>Total</b>								
<b>Site Plan</b>		<b>Per Unit</b>								
Site Plan	Stormwater Impervious Cover Tree Preservation Preliminary Plan Review	development	1	2E+05	\$0.15	\$28,687.50	1	3825	\$0.15	\$573.75
Tree Protection	Tree Preservation Validation	development	1	1	\$100.00	\$100.00	1	1	\$100.00	\$100.00
Tree Protection	Tree Permit	per lot, \$2000 maximum	200	1	\$50.00	\$10,000.00	4	1	\$50.00	\$200.00
Tree Protection	Tree Affidavit	per lot, \$1,000 maximum	200	1	\$50.00	\$10,000.00	4	1	\$50.00	\$200.00
Tree Protection	Tree Canopy Enhancement Tree Certification Credit	per lot, \$2000 maximum	200	1	\$15.00	\$3,000.00	4	1	\$15.00	\$60.00
Tree Protection	Tree Certification Credit	development	1	1	\$100.00	\$100.00	1	1	\$100.00	\$100.00
Tree Protection	Tree Certification Credit	per inch	40	10	\$1.00	\$400.00	1	10	\$1.00	\$10.00
Tree Protection	Significant Tree Mitigation	per inch	40	10	\$200.00	\$80,000.00	1	10	\$200.00	\$2,000.00
Tree Protection	Heritage Tree Mitigation	per inch	40	10	\$600.00	\$240,000.00	1	10	\$600.00	\$6,000.00
<b>Permit</b>		<b>Total</b>								

Permit	Per Unit				\$1,379.00				\$1,379.00	
Permit	Building Permit	per structure of 0-500 sf	0	0	\$150.00	\$0.00	0	0	\$150.00	\$0.00
Permit	Building Permit	per structure of 501-1000 sf	0	0	\$425.00	\$0.00	0	0	\$425.00	\$0.00
Permit	Building Permit	per structure of 1001-1250 sf	0	0	\$450.00	\$0.00	0	0	\$450.00	\$0.00
Permit	Building Permit	per structure of 1251-1500 sf	200	1	\$625.00	\$125,000.00	4	1	\$625.00	\$2,500.00
Permit	Building Permit	per structure of 1501-1750 sf	0	0	\$800.00	\$0.00	0	0	\$800.00	\$0.00
Permit	Building Permit	per structure of 1751-2000 sf	0	0	\$850.00	\$0.00	0	0	\$850.00	\$0.00
Permit	Building Permit	per structure of 2001-2250 sf	0	0	\$850.00	\$0.00	0	0	\$850.00	\$0.00
Permit	Building Permit	per structure of 2251-2500 sf	0	0	\$850.00	\$0.00	0	0	\$850.00	\$0.00
Permit	Building Permit	per structure of 2501-3000 sf	0	0	\$880.00	\$0.00	0	0	\$880.00	\$0.00
Permit	Building Permit	per structure of 3001-3500 sf	0	0	\$920.00	\$0.00	0	0	\$920.00	\$0.00
Permit	Building Permit	per structure of 3501-4000 sf	0	0	\$930.00	\$0.00	0	0	\$930.00	\$0.00
Permit	Building Permit	per structure of 4001-5000 sf	0	0	\$1,000.00	\$0.00	0	0	\$1,000.00	\$0.00
Permit	Building Permit	per structure of 5001-6000 sf	0	0	\$1,100.00	\$0.00	0	0	\$1,100.00	\$0.00
Permit	Building Permit	per structure of 6001-6500 sf	0	0	\$1,200.00	\$0.00	0	0	\$1,200.00	\$0.00
Permit	Building Permit	per structure of 6501-7000 sf	0	0	\$1,400.00	\$0.00	0	0	\$1,400.00	\$0.00
Permit	Building Permit	per structure of 7001-7250 sf	0	0	\$1,550.00	\$0.00	0	0	\$1,550.00	\$0.00
Permit	Building Permit	per structure of 7251-7500 sf	0	0	\$1,725.00	\$0.00	0	0	\$1,725.00	\$0.00
Permit	Building Permit	per structure of 7501-7750 sf	0	0	\$1,900.00	\$0.00	0	0	\$1,900.00	\$0.00
Permit	Building Permit	per structure of 7751-9000 sf	0	0	\$2,000.00	\$0.00	0	0	\$2,000.00	\$0.00
Permit	Electrical Permit	per structure of 0-500 sf	0	0	\$100.00	\$0.00	0	0	\$100.00	\$0.00
Permit	Electrical Permit	per structure of 501-1000 sf	0	0	\$100.00	\$0.00	0	0	\$100.00	\$0.00
Permit	Electrical Permit	per structure of 1001-1250 sf	0	0	\$100.00	\$0.00	0	0	\$100.00	\$0.00
Permit	Electrical Permit	per structure of 1251-1500 sf	200	1	\$100.00	\$20,000.00	4	1	\$100.00	\$400.00
Permit	Electrical Permit	per structure of 1501-1750 sf	0	0	\$100.00	\$0.00	0	0	\$100.00	\$0.00
Permit	Electrical Permit	per structure of 1751-2000 sf	0	0	\$100.00	\$0.00	0	0	\$100.00	\$0.00
Permit	Electrical Permit	per structure of 2001-2250 sf	0	0	\$100.00	\$0.00	0	0	\$100.00	\$0.00
Permit	Electrical Permit	per structure of 2251-2500 sf	0	0	\$100.00	\$0.00	0	0	\$100.00	\$0.00
Permit	Electrical Permit	per structure of 2501-3000 sf	0	0	\$110.00	\$0.00	0	0	\$110.00	\$0.00
Permit	Electrical Permit	per structure of 3001-3500 sf	0	0	\$110.00	\$0.00	0	0	\$110.00	\$0.00
Permit	Electrical Permit	per structure of 3501-4000 sf	0	0	\$120.00	\$0.00	0	0	\$120.00	\$0.00
Permit	Electrical Permit	per structure of 4001-5000 sf	0	0	\$125.00	\$0.00	0	0	\$125.00	\$0.00
Permit	Electrical Permit	per structure of 5001-6000 sf	0	0	\$125.00	\$0.00	0	0	\$125.00	\$0.00
Permit	Electrical Permit	per structure of 6001-6500 sf	0	0	\$150.00	\$0.00	0	0	\$150.00	\$0.00
Permit	Electrical Permit	per structure of 6501-7000 sf	0	0	\$150.00	\$0.00	0	0	\$150.00	\$0.00
Permit	Electrical Permit	per structure of 7001-7250 sf	0	0	\$200.00	\$0.00	0	0	\$200.00	\$0.00
Permit	Electrical Permit	per structure of 7251-7500 sf	0	0	\$200.00	\$0.00	0	0	\$200.00	\$0.00



Permit	Electrical Permit	per structure of 7501-7750 sf	0	0	\$200.00	\$0.00	0	0	\$200.00	\$0.00
Permit	Electrical Permit	per structure of 7751-9000 sf	0	0	\$200.00	\$0.00	0	0	\$200.00	\$0.00
Permit	Mechanical Permit	per structure of 0-500 sf	0	0	\$80.00	\$0.00	0	0	\$80.00	\$0.00
Permit	Mechanical Permit	per structure of 501-1000 sf	0	0	\$80.00	\$0.00	0	0	\$80.00	\$0.00
Permit	Mechanical Permit	per structure of 1001-1250 sf	0	0	\$80.00	\$0.00	0	0	\$80.00	\$0.00
Permit	Mechanical Permit	per structure of 1251-1500 sf	200	1	\$80.00	\$16,000.00	4	1	\$80.00	\$320.00
Permit	Mechanical Permit	per structure of 1501-1750 sf	0	0	\$85.00	\$0.00	0	0	\$85.00	\$0.00
Permit	Mechanical Permit	per structure of 1751-2000 sf	0	0	\$85.00	\$0.00	0	0	\$85.00	\$0.00
Permit	Mechanical Permit	per structure of 2001-2250 sf	0	0	\$85.00	\$0.00	0	0	\$85.00	\$0.00
Permit	Mechanical Permit	per structure of 2251-2500 sf	0	0	\$85.00	\$0.00	0	0	\$85.00	\$0.00
Permit	Mechanical Permit	per structure of 2501-3000 sf	0	0	\$85.00	\$0.00	0	0	\$85.00	\$0.00
Permit	Mechanical Permit	per structure of 3001-3500 sf	0	0	\$90.00	\$0.00	0	0	\$90.00	\$0.00
Permit	Mechanical Permit	per structure of 3501-4000 sf	0	0	\$110.00	\$0.00	0	0	\$110.00	\$0.00
Permit	Mechanical Permit	per structure of 4001-5000 sf	0	0	\$140.00	\$0.00	0	0	\$140.00	\$0.00
Permit	Mechanical Permit	per structure of 5001-6000 sf	0	0	\$165.00	\$0.00	0	0	\$165.00	\$0.00
Permit	Mechanical Permit	per structure of 6001-6500 sf	0	0	\$245.00	\$0.00	0	0	\$245.00	\$0.00
Permit	Mechanical Permit	per structure of 6501-7000 sf	0	0	\$245.00	\$0.00	0	0	\$245.00	\$0.00
Permit	Mechanical Permit	per structure of 7001-7250 sf	0	0	\$245.00	\$0.00	0	0	\$245.00	\$0.00
Permit	Mechanical Permit	per structure of 7251-7500 sf	0	0	\$245.00	\$0.00	0	0	\$245.00	\$0.00
Permit	Mechanical Permit	per structure of 7501-7750 sf	0	0	\$250.00	\$0.00	0	0	\$250.00	\$0.00
Permit	Mechanical Permit	per structure of 7751-9000 sf	0	0	\$250.00	\$0.00	0	0	\$250.00	\$0.00
Permit	Plumbing Permit	per structure of 0-500 sf	0	0	\$60.00	\$0.00	0	0	\$60.00	\$0.00
Permit	Plumbing Permit	per structure of 501-1000 sf	0	0	\$119.00	\$0.00	0	0	\$119.00	\$0.00
Permit	Plumbing Permit	per structure of 1001-1250 sf	0	0	\$128.00	\$0.00	0	0	\$128.00	\$0.00
Permit	Plumbing Permit	per structure of 1251-1500 sf	200	1	\$132.00	\$26,400.00	4	1	\$132.00	\$528.00
Permit	Plumbing Permit	per structure of 1501-1750 sf	0	0	\$145.00	\$0.00	0	0	\$145.00	\$0.00
Permit	Plumbing Permit	per structure of 1751-2000 sf	0	0	\$149.00	\$0.00	0	0	\$149.00	\$0.00
Permit	Plumbing Permit	per structure of 2001-2250 sf	0	0	\$151.00	\$0.00	0	0	\$151.00	\$0.00
Permit	Plumbing Permit	per structure of 2251-2500 sf	0	0	\$156.00	\$0.00	0	0	\$156.00	\$0.00
Permit	Plumbing Permit	per structure of 2501-3000 sf	0	0	\$164.00	\$0.00	0	0	\$164.00	\$0.00
Permit	Plumbing Permit	per structure of 3001-3500 sf	0	0	\$178.00	\$0.00	0	0	\$178.00	\$0.00
Permit	Plumbing Permit	per structure of 3501-4000 sf	0	0	\$190.00	\$0.00	0	0	\$190.00	\$0.00
Permit	Plumbing Permit	per structure of 4001-5000 sf	0	0	\$207.00	\$0.00	0	0	\$207.00	\$0.00
Permit	Plumbing Permit	per structure of 5001-6000 sf	0	0	\$223.00	\$0.00	0	0	\$223.00	\$0.00
Permit	Plumbing Permit	per structure of 6001-6500 sf	0	0	\$283.00	\$0.00	0	0	\$283.00	\$0.00
Permit	Plumbing Permit	per structure of 6501-7000 sf	0	0	\$342.00	\$0.00	0	0	\$342.00	\$0.00
Permit	Plumbing Permit	per structure of 7001-7250 sf	0	0	\$351.00	\$0.00	0	0	\$351.00	\$0.00



Permit	Plumbing Permit	per structure of 7251-7500 sf	0	0	\$355.00	\$0.00	0	0	\$355.00	\$0.00
Permit	Plumbing Permit	per structure of 7501-7750 sf	0	0	\$368.00	\$0.00	0	0	\$368.00	\$0.00
Permit	Plumbing Permit	per structure of 7751-9000 sf	0	0	\$372.00	\$0.00	0	0	\$372.00	\$0.00
Permit	Sewer Permit	per structure of 501-1000 sf	0	0	\$64.00	\$0.00	0	0	\$64.00	\$0.00
Permit	Sewer Permit	per structure of 1001-1250 sf	0	0	\$64.00	\$0.00	0	0	\$64.00	\$0.00
Permit	Sewer Permit	per structure of 1251-1500 sf	200	1	\$64.00	\$12,800.00	4	1	\$64.00	\$256.00
Permit	Sewer Permit	per structure of 1501-1750 sf	0	0	\$64.00	\$0.00	0	0	\$64.00	\$0.00
Permit	Sewer Permit	per structure of 1751-2000 sf	0	0	\$64.00	\$0.00	0	0	\$64.00	\$0.00
Permit	Sewer Permit	per structure of 2001-2250 sf	0	0	\$64.00	\$0.00	0	0	\$64.00	\$0.00
Permit	Sewer Permit	per structure of 2251-2500 sf	0	0	\$64.00	\$0.00	0	0	\$64.00	\$0.00
Permit	Sewer Permit	per structure of 2501-3000 sf	0	0	\$64.00	\$0.00	0	0	\$64.00	\$0.00
Permit	Sewer Permit	per structure of 3001-3500 sf	0	0	\$64.00	\$0.00	0	0	\$64.00	\$0.00
Permit	Sewer Permit	per structure of 3501-4000 sf	0	0	\$64.00	\$0.00	0	0	\$64.00	\$0.00
Permit	Sewer Permit	per structure of 4001-5000 sf	0	0	\$64.00	\$0.00	0	0	\$64.00	\$0.00
Permit	Sewer Permit	per structure of 5001-6000 sf	0	0	\$64.00	\$0.00	0	0	\$64.00	\$0.00
Permit	Sewer Permit	per structure of 6001-6500 sf	0	0	\$64.00	\$0.00	0	0	\$64.00	\$0.00
Permit	Sewer Permit	per structure of 6501-7000 sf	0	0	\$64.00	\$0.00	0	0	\$64.00	\$0.00
Permit	Sewer Permit	per structure of 7001-7250 sf	0	0	\$64.00	\$0.00	0	0	\$64.00	\$0.00
Permit	Sewer Permit	per structure of 7251-7500 sf	0	0	\$64.00	\$0.00	0	0	\$64.00	\$0.00
Permit	Sewer Permit	per structure of 7501-7750 sf	0	0	\$64.00	\$0.00	0	0	\$64.00	\$0.00
Permit	Sewer Permit	per structure of 7751-9000 sf	0	0	\$64.00	\$0.00	0	0	\$64.00	\$0.00
Permit	Plan Review	per structure of 501-1000 sf	0	0	\$200.00	\$0.00	0	0	\$200.00	\$0.00
Permit	Plan Review	per structure of 1001-1250 sf	0	0	\$200.00	\$0.00	0	0	\$200.00	\$0.00
Permit	Plan Review	per structure of 1251-1500 sf	200	1	\$200.00	\$40,000.00	4	1	\$200.00	\$800.00
Permit	Plan Review	per structure of 1501-1750 sf	0	0	\$200.00	\$0.00	0	0	\$200.00	\$0.00
Permit	Plan Review	per structure of 1751-2000 sf	0	0	\$200.00	\$0.00	0	0	\$200.00	\$0.00
Permit	Plan Review	per structure of 2001-2250 sf	0	0	\$200.00	\$0.00	0	0	\$200.00	\$0.00
Permit	Plan Review	per structure of 2251-2500 sf	0	0	\$200.00	\$0.00	0	0	\$200.00	\$0.00
Permit	Plan Review	per structure of 2501-3000 sf	0	0	\$200.00	\$0.00	0	0	\$200.00	\$0.00
Permit	Plan Review	per structure of 3001-3500 sf	0	0	\$400.00	\$0.00	0	0	\$400.00	\$0.00
Permit	Plan Review	per structure of 3501-4000 sf	0	0	\$400.00	\$0.00	0	0	\$400.00	\$0.00
Permit	Plan Review	per structure of 4001-5000 sf	0	0	\$400.00	\$0.00	0	0	\$400.00	\$0.00
Permit	Plan Review	per structure of 5001-6000 sf	0	0	\$400.00	\$0.00	0	0	\$400.00	\$0.00
Permit	Plan Review	per structure of 6001-6500 sf	0	0	\$600.00	\$0.00	0	0	\$600.00	\$0.00
Permit	Plan Review	per structure of 6501-7000 sf	0	0	\$600.00	\$0.00	0	0	\$600.00	\$0.00
Permit	Plan Review	per structure of 7001-7250 sf	0	0	\$600.00	\$0.00	0	0	\$600.00	\$0.00
Permit	Plan Review	per structure of 7251-7500 sf	0	0	\$600.00	\$0.00	0	0	\$600.00	\$0.00





Permit	Plan Review	per structure of 7501-7750 sf	0	0	\$600.00	\$0.00	0	0	\$600.00	\$0.00
Permit	Plan Review	per structure of 7751-9000 sf	0	0	\$600.00	\$0.00	0	0	\$600.00	\$0.00
Permit	Temporary electrical panel permit	per structure of 501-1000 sf	0	0	\$57.00	\$0.00	0	0	\$57.00	\$0.00
Permit	Temporary electrical panel permit	per structure of 1001-1250 sf	0	0	\$57.00	\$0.00	0	0	\$57.00	\$0.00
Permit	Temporary electrical panel permit	per structure of 1251-1500 sf	200	1	\$57.00	\$11,400.00	4	1	\$57.00	\$228.00
Permit	Temporary electrical panel permit	per structure of 1501-1750 sf	0	0	\$57.00	\$0.00	0	0	\$57.00	\$0.00
Permit	Temporary electrical panel permit	per structure of 1751-2000 sf	0	0	\$57.00	\$0.00	0	0	\$57.00	\$0.00
Permit	Temporary electrical panel permit	per structure of 2001-2250 sf	0	0	\$57.00	\$0.00	0	0	\$57.00	\$0.00
Permit	Temporary electrical panel permit	per structure of 2251-2500 sf	0	0	\$57.00	\$0.00	0	0	\$57.00	\$0.00
Permit	Temporary electrical panel permit	per structure of 2501-3000 sf	0	0	\$57.00	\$0.00	0	0	\$57.00	\$0.00
Permit	Temporary electrical panel permit	per structure of 3001-3500 sf	0	0	\$57.00	\$0.00	0	0	\$57.00	\$0.00
Permit	Temporary electrical panel permit	per structure of 3501-4000 sf	0	0	\$57.00	\$0.00	0	0	\$57.00	\$0.00
Permit	Temporary electrical panel permit	per structure of 4001-5000 sf	0	0	\$57.00	\$0.00	0	0	\$57.00	\$0.00
Permit	Temporary electrical panel permit	per structure of 5001-6000 sf	0	0	\$57.00	\$0.00	0	0	\$57.00	\$0.00
Permit	Temporary electrical panel permit	per structure of 6001-6500 sf	0	0	\$57.00	\$0.00	0	0	\$57.00	\$0.00
Permit	Temporary electrical panel permit	per structure of 6501-7000 sf	0	0	\$57.00	\$0.00	0	0	\$57.00	\$0.00
Permit	Temporary electrical panel permit	per structure of 7001-7250 sf	0	0	\$57.00	\$0.00	0	0	\$57.00	\$0.00
Permit	Temporary electrical panel permit	per structure of 7251-7500 sf	0	0	\$57.00	\$0.00	0	0	\$57.00	\$0.00
Permit	Temporary electrical panel permit	per structure of 7501-7750 sf	0	0	\$57.00	\$0.00	0	0	\$57.00	\$0.00
Permit	Temporary electrical panel permit	per structure of 7751-9000 sf	0	0	\$57.00	\$0.00	0	0	\$57.00	\$0.00
Permit	Temporary on permanent electrical panel permit	per structure of 501-1000 sf	0	0	\$57.00	\$0.00	0	0	\$57.00	\$0.00
Permit	Temporary on permanent electrical panel permit	per structure of 1001-1250 sf	0	0	\$57.00	\$0.00	0	0	\$57.00	\$0.00
Permit	Temporary on permanent electrical panel permit	per structure of 1251-1500 sf	200	1	\$57.00	\$11,400.00	4	1	\$57.00	\$228.00
Permit	Temporary on permanent electrical panel permit	per structure of 1501-1750 sf	0	0	\$57.00	\$0.00	0	0	\$57.00	\$0.00



Permit	Temporary on permanent electrical panel permit	per structure of 1751-2000 sf	0	0	\$57.00	\$0.00	0	0	\$57.00	\$0.00
Permit	Temporary on permanent electrical panel permit	per structure of 2001-2250 sf	0	0	\$57.00	\$0.00	0	0	\$57.00	\$0.00
Permit	Temporary on permanent electrical panel permit	per structure of 2251-2500 sf	0	0	\$57.00	\$0.00	0	0	\$57.00	\$0.00
Permit	Temporary on permanent electrical panel permit	per structure of 2501-3000 sf	0	0	\$57.00	\$0.00	0	0	\$57.00	\$0.00
Permit	Temporary on permanent electrical panel permit	per structure of 3001-3500 sf	0	0	\$57.00	\$0.00	0	0	\$57.00	\$0.00
Permit	Temporary on permanent electrical panel permit	per structure of 3501-4000 sf	0	0	\$57.00	\$0.00	0	0	\$57.00	\$0.00
Permit	Temporary on permanent electrical panel permit	per structure of 4001-5000 sf	0	0	\$57.00	\$0.00	0	0	\$57.00	\$0.00
Permit	Temporary on permanent electrical panel permit	per structure of 5001-6000 sf	0	0	\$57.00	\$0.00	0	0	\$57.00	\$0.00
Permit	Temporary on permanent electrical panel permit	per structure of 6001-6500 sf	0	0	\$57.00	\$0.00	0	0	\$57.00	\$0.00
Permit	Temporary on permanent electrical panel permit	per structure of 6501-7000 sf	0	0	\$57.00	\$0.00	0	0	\$57.00	\$0.00
Permit	Temporary on permanent electrical panel permit	per structure of 7001-7250 sf	0	0	\$57.00	\$0.00	0	0	\$57.00	\$0.00
Permit	Temporary on permanent electrical panel permit	per structure of 7251-7500 sf	0	0	\$57.00	\$0.00	0	0	\$57.00	\$0.00
Permit	Temporary on permanent electrical panel permit	per structure of 7501-7750 sf	0	0	\$57.00	\$0.00	0	0	\$57.00	\$0.00
Permit	Temporary on permanent electrical panel permit	per structure of 7751-9000 sf	0	0	\$57.00	\$0.00	0	0	\$57.00	\$0.00
Permit	Gas Permit	per structure of 501-1000 sf	0	0	\$64.00	\$0.00	0	0	\$64.00	\$0.00
Permit	Gas Permit	per structure of 1001-1250 sf	0	0	\$64.00	\$0.00	0	0	\$64.00	\$0.00
Permit	Gas Permit	per structure of 1251-1500 sf	200	1	\$64.00	\$12,800.00	4	1	\$64.00	\$256.00
Permit	Gas Permit	per structure of 1501-1750 sf	0	0	\$64.00	\$0.00	0	0	\$64.00	\$0.00
Permit	Gas Permit	per structure of 1751-2000 sf	0	0	\$64.00	\$0.00	0	0	\$64.00	\$0.00
Permit	Gas Permit	per structure of 2001-2250 sf	0	0	\$64.00	\$0.00	0	0	\$64.00	\$0.00
Permit	Gas Permit	per structure of 2251-2500 sf	0	0	\$64.00	\$0.00	0	0	\$64.00	\$0.00
Permit	Gas Permit	per structure of 2501-3000 sf	0	0	\$64.00	\$0.00	0	0	\$64.00	\$0.00
Permit	Gas Permit	per structure of 3001-3500 sf	0	0	\$64.00	\$0.00	0	0	\$64.00	\$0.00
Permit	Gas Permit	per structure of 3501-4000 sf	0	0	\$64.00	\$0.00	0	0	\$64.00	\$0.00



Permit	Gas Permit	per structure of 4001-5000 sf	0	0	\$64.00	\$0.00	0	0	\$64.00	\$0.00
Permit	Gas Permit	per structure of 5001-6000 sf	0	0	\$64.00	\$0.00	0	0	\$64.00	\$0.00
Permit	Gas Permit	per structure of 6001-6500 sf	0	0	\$64.00	\$0.00	0	0	\$64.00	\$0.00
Permit	Gas Permit	per structure of 6501-7000 sf	0	0	\$64.00	\$0.00	0	0	\$64.00	\$0.00
Permit	Gas Permit	per structure of 7001-7250 sf	0	0	\$64.00	\$0.00	0	0	\$64.00	\$0.00
Permit	Gas Permit	per structure of 7251-7500 sf	0	0	\$64.00	\$0.00	0	0	\$64.00	\$0.00
Permit	Gas Permit	per structure of 7501-7750 sf	0	0	\$64.00	\$0.00	0	0	\$64.00	\$0.00
Permit	Gas Permit	per structure of 7751-9000 sf	0	0	\$64.00	\$0.00	0	0	\$64.00	\$0.00
<b>Tap fee</b>		<b>Total</b>				<b>\$0.00</b>			<b>\$0.00</b>	<b>\$0.00</b>
<b>Tap fee</b>		<b>Per Unit</b>				<b>\$0.00</b>			<b>\$0.00</b>	<b>\$0.00</b>
<b>impact fee</b>		<b>Total</b>				<b>\$1,709,600.00</b>				<b>\$34,192.00</b>
<b>impact fee</b>		<b>Per Unit</b>				<b>\$8,548.00</b>				<b>\$8,548.00</b>
impact fee	water	5/8 meter	200	1	\$5,097.00	\$1,019,400.00	4	1	\$5,097.00	\$20,388.00
impact fee	sewer	5/8 meter	200	1	\$3,451.00	\$690,200.00	4	1	\$3,451.00	\$13,804.00

# City of Kyle – Fee Sheet

Fee Category	Fee name	Fee basis	Development Model 1				Development model 2			
			development, lots, or structures	units of charge	per basis unit fee	total charged	development, lots, or structures	units of charge	per basis unit fee	total charged
<b>Total Fees</b>						<b>\$2,263,903.97</b>				<b>\$52,761.08</b>
<b>Total Fees per unit</b>						<b>\$11,319.52</b>				<b>\$13,190.27</b>
<b>Comprehensive Plan</b>		<b>Total</b>				<b>\$0.00</b>				<b>\$0.00</b>
<b>Comprehensive Plan</b>		<b>Per Unit</b>				<b>\$0.00</b>				<b>\$0.00</b>
<b>Zoning</b>		<b>Total</b>				<b>\$572.86</b>				<b>\$431.68</b>
<b>Zoning</b>		<b>Per Unit</b>				<b>\$2.86</b>				<b>\$107.92</b>
Zoning	Zoning Review	development	1	1	\$428.06	\$428.06	1	1	\$428.06	\$428.06
Zoning	Zoning Review	per acre	1	40	\$3.62	\$144.80	1	1	\$3.62	\$3.62
<b>Subdivision</b>		<b>Total</b>				<b>\$6,607.91</b>				<b>\$3,775.93</b>
<b>Subdivision</b>		<b>Per Unit</b>				<b>\$33.04</b>				<b>\$943.98</b>
Subdivision	Preliminary Plan	development	1	1	\$1,002.58	\$1,002.58	1	1	\$1,002.58	\$1,002.58
Subdivision	Preliminary Plan	per acre	1	40	\$6.04	\$241.60	1	1	\$6.04	\$6.04
Subdivision	Short form plat	development	1	1	\$453.26	\$453.26	1	1	\$453.26	\$453.26
Subdivision	Short form plat	per lot	200	1	\$6.04	\$1,208.00	4	1	\$6.04	\$24.16
Subdivision	Concept Plan	development	1	1	\$1,110.91	\$1,110.91	1	1	\$1,110.91	\$1,110.91
Subdivision	Concept Plan	per acre	1	40	\$18.11	\$724.40	1	1	\$18.11	\$18.11
Subdivision	Final Plat	development	1	1	\$1,142.76	\$1,142.76	1	1	\$1,142.76	\$1,142.76
Subdivision	Final Plat	per acre	1	40	\$18.11	\$724.40	1	1	\$18.11	\$18.11
<b>Dedication Fee in Lieu</b>		<b>Total</b>				<b>\$300,000.00</b>				<b>\$6,000.00</b>
<b>Dedication Fee in Lieu</b>		<b>Per Unit</b>				<b>\$1,500.00</b>				<b>\$1,500.00</b>
Dedication Fee in Lieu	Land Dedication	per residential unit	200	1	\$750.00	\$150,000.00	4	1	\$750.00	\$3,000.00
Dedication Fee in Lieu	parkland Development	per residential unit	200	1	\$750.00	\$150,000.00	4	1	\$750.00	\$3,000.00
<b>Site Plan</b>		<b>Total</b>				<b>\$462,708.70</b>				<b>\$12,673.18</b>
<b>Site Plan</b>		<b>Per Unit</b>				<b>\$2,313.54</b>				<b>\$3,168.30</b>
Site Plan	Public Improvement Construction Plan Review	per development	1	1	\$1,838.52	\$1,838.52	1	1	\$1,838.52	\$1,838.52
Site Plan	Public Improvement Construction Plan Review	estimated value of improvements per \$ of site public infrastructure construction costs	1	6E+06	\$0.02	\$90,000.00	1	1E+05	\$0.02	\$1,800.00
Site plan	Construction Infrastructure Inspection Site Development Plan	development	1	1	\$1,631.78	\$1,631.78	1	1	\$1,631.78	\$1,631.78
Site plan	Site Development Plan	Per acre	1	40	\$90.56	\$3,622.40	1	1	\$90.56	\$90.56
Site Plan	Adjacent Lane Mile Fee	Dwelling units	200	1	\$1,228.08	\$245,616.00	4	1	\$1,228.08	\$4,912.32

<b>Permit</b>		<b>Total</b>			<b>\$134,874.50</b>				<b>\$2,697.49</b>	
<b>Permit</b>		<b>Per Unit</b>			<b>\$674.37</b>				<b>\$674.37</b>	
Permit	Inspection Flood Plain Review	per structure	200	1	\$71.31	\$14,262.50	4	1	\$71.31	\$285.25
Permit	Certificate of Occupancy	per structure	200	1	\$82.41	\$16,482.00	4	1	\$82.41	\$329.64
Permit	Building Permit	per structure of 900 sf or less	0	0	\$193.65	\$0.00	0	0	\$193.65	\$0.00
Permit	Building Permit	per structure of 901 to 1200 sf	0	0	\$329.23	\$0.00	0	0	\$329.23	\$0.00
Permit	Building Permit	per structure of 1201 to 1500 sf	200	1	\$445.40	\$89,080.00	4	1	\$445.40	\$1,781.60
Permit	Building Permit	per structure of 1501 to 2000 sf	0	0	\$561.59	\$0.00	0	0	\$561.59	\$0.00
Permit	Building Permit	per structure of 2001 to 2500 sf	0	0	\$793.98	\$0.00	0	0	\$793.98	\$0.00
Permit	Building Permit	per structure of 2501 to 3000 sf	0	0	\$1,142.64	\$0.00	0	0	\$1,142.64	\$0.00
Permit	Building Permit	per structure of 3001 and up sf	0	0	\$1,258.73	\$0.00	0	0	\$1,258.73	\$0.00
Permit	Building Permit	per each additional 1,000 sf above 3000	0	0	\$99.05	\$0.00	0	0	\$99.05	\$0.00
Permit	Inspection	per inspection	200	1	\$75.25	\$15,050.00	4	1	\$75.25	\$301.00
<b>Tap fee</b>		<b>Total</b>			<b>\$86,940.00</b>				<b>\$1,738.80</b>	
<b>Tap fee</b>		<b>Per Unit</b>			<b>\$434.70</b>				<b>\$434.70</b>	
Tap fee	water	base	200	1	\$217.35	\$43,470.00	4	1	\$217.35	\$869.40
tap fee	water	+cost			\$1.00				\$1.00	
Tap fee	wastewater	base	200	1	\$217.35	\$43,470.00	4	1	\$217.35	\$869.40
tap fee	wastewater	+cost			\$1.00				\$1.00	
<b>impact fee</b>		<b>Total</b>			<b>\$1,272,200.00</b>				<b>\$25,444.00</b>	
<b>impact fee</b>		<b>Per Unit</b>			<b>\$6,361.00</b>				<b>\$6,361.00</b>	
impact fee	water	5/8 meter	200	1	\$3,535.00	\$707,000.00	4	1	\$3,535.00	\$14,140.00
impact fee	sewer	5/8 meter	200	1	\$2,826.00	\$565,200.00	4	1	\$2,826.00	\$11,304.00

## City of Georgetown – Fee Set

Fee Category	Fee name	Fee basis	Development Model 1				Development Model 2			
			development, lots, or structures	units of charge	per basis unit fee	total charged	development, lots, or structures	units of charge	per basis unit fee	total charged
<b>Total Fees</b>						<b>\$2,234,043.00</b>				<b>\$66,026.24</b>
<b>Total Fees per unit</b>						<b>\$11,170.22</b>				<b>\$16,506.56</b>
<b>Comprehensive Plan</b>		<b>Total</b>				<b>\$725.00</b>				<b>\$725.00</b>
<b>Comprehensive Plan</b>		<b>Per Unit</b>				<b>\$3.63</b>				<b>\$181.25</b>
Comprehensive Plan	Comprehensive Plan Amendment	development	1	1	\$725.00	\$725.00	1	1	\$725.00	\$725.00
<b>Zoning</b>		<b>Total</b>				<b>\$1,040.00</b>				<b>\$515.00</b>
<b>Zoning</b>		<b>Per Unit</b>				<b>\$5.20</b>				<b>\$128.75</b>
Zoning	Zoning Review	development	1	1	\$515.00	\$515.00	1	1	\$515.00	\$515.00
Zoning	Zoning Review	per each additional 5 acres above 5	1	7	\$75.00	\$525.00	0	0	\$75.00	\$0.00
<b>Subdivision</b>		<b>Total</b>				<b>\$17,575.00</b>				<b>\$8,755.00</b>
<b>Subdivision</b>		<b>Per Unit</b>				<b>\$87.88</b>				<b>\$2,188.75</b>
Subdivision	Preliminary Plat	development per lot or acre whichever greater	1	1	\$5,050.00	\$5,050.00	1	1	\$5,050.00	\$5,050.00
Subdivision	Preliminary Plat	development per lot or acre whichever greater	200	1	\$20.00	\$4,000.00	4	1	\$20.00	\$80.00
Subdivision	Final Plat	development per lot or acre whichever greater	1	1	\$3,525.00	\$3,525.00	1	1	\$3,525.00	\$3,525.00
Subdivision	Final Plat	development per lot or acre whichever greater	200	1	\$25.00	\$5,000.00	4	1	\$25.00	\$100.00
<b>Dedication Fee in Lieu</b>		<b>Total</b>				<b>\$330,000.00</b>				<b>\$6,600.00</b>
<b>Dedication Fee in Lieu</b>		<b>Per Unit</b>				<b>\$1,650.00</b>				<b>\$1,650.00</b>
Dedication Fee in Lieu	Parkland Dedication	per residential unit w/ 2 or less du	200	1	\$650.00	\$130,000.00	4	1	\$650.00	\$2,600.00
Dedication Fee in Lieu	Parkland Dedication	per residential unit w/ 3 or more du	0	0	\$475.00	\$0.00	0	0	\$475.00	\$0.00
Dedication Fee in Lieu	Parkland Development	per residential unit w/ 2 or less du	200	1	\$1,000.00	\$200,000.00	4	1	\$1,000.00	\$4,000.00
Dedication Fee in Lieu	Parkland Development	per residential unit w/ 3 or more du	0	0	\$750.00	\$0.00	0	0	\$750.00	\$0.00
<b>Site Plan</b>		<b>Total</b>				<b>\$238,941.00</b>				<b>\$16,516.00</b>
<b>Site Plan</b>		<b>Per Unit</b>				<b>\$1,194.71</b>				<b>\$4,129.00</b>
Site plan	Construction Plans	per development per lot or acre whichever greater	1	1	\$4,550.00	\$4,550.00	1	1	\$4,550.00	\$4,550.00
Site plan	Construction Plans	per development per lot or acre whichever greater	200	1	\$100.00	\$20,000.00	4	1	\$100.00	\$400.00
Site plan	Water Engineering and Inspection	Per dwelling unit -Single Family	200	1	\$500.00	\$100,000.00	4	1	\$500.00	\$2,000.00
Site plan	Water Engineering and Inspection	Per dwelling unit - Multi-Family	0	0	\$250.00	\$0.00	0	0	\$250.00	\$0.00
Site plan	Waste Water Engineering and Inspection	Per dwelling unit -Single Family	200	1	\$500.00	\$100,000.00	4	1	\$500.00	\$2,000.00



Site plan	Waste Water Engineering and Inspection Site	Per dwelling unit - Multi-Family	0	0	\$250.00	\$0.00	0	0	\$250.00	\$0.00
Site plan	Development Plan	development	1	1	\$5,050.00	\$5,050.00	1	1	\$5,050.00	\$5,050.00
Site plan	Development Plan	Per acre after 1st	1	39	\$175.00	\$6,825.00	1	0	\$175.00	\$0.00
Site Plan	Stormwater Permit	development	1	1	\$2,010.00	\$2,010.00	1	1	\$2,010.00	\$2,010.00
Tree Protection	Tree Protection Priority	development	1	1	\$506.00	\$506.00	1	1	\$506.00	\$506.00
<b>Permit</b>		<b>Total</b>				<b>\$177,000.00</b>				<b>\$3,540.00</b>
<b>Permit</b>		<b>Per Unit</b>				<b>\$885.00</b>				<b>\$885.00</b>
Permit	Building Permit	per structure	200	1	\$125.00	\$25,000.00	4	1	\$125.00	\$500.00
Permit	Building Permit	per structure per sf	200	1500	\$0.40	\$120,000.00	4	1500	\$0.40	\$2,400.00
Permit	Flood Plain Review	per structure	200	1	\$110.00	\$22,000.00	4	1	\$110.00	\$440.00
Permit	Certificate of Occupancy	per structure	200	1	\$50.00	\$10,000.00	4	1	\$50.00	\$200.00
<b>Tap fee</b>		<b>Total</b>				<b>\$130,000.00</b>				<b>\$2,600.00</b>
<b>Tap fee</b>		<b>Per Unit</b>				<b>\$650.00</b>				<b>\$650.00</b>
Tap fee	water	3/4 meter	200	1	\$350.00	\$70,000.00	4	1	\$350.00	\$1,400.00
tap fee	wastewater	4 inch	200	1	\$300.00	\$60,000.00	4	1	\$300.00	\$1,200.00
<b>impact fee</b>		<b>Total</b>				<b>\$1,338,762.00</b>				<b>\$26,775.24</b>
<b>impact fee</b>		<b>Per Unit</b>				<b>\$6,693.81</b>				<b>\$6,693.81</b>
impact fee	water	5/8 meter	200	1	\$4,616.10	\$923,220.00	4	1	\$4,616.10	\$18,464.40
impact fee	sewer	5/8 meter	200	1	\$2,077.71	\$415,542.00	4	1	\$2,077.71	\$8,310.84

# City of Buda – Fee Set

Fee Category	Fee name	Fee basis	Development Model 1				Development Model 2			
			development, lots, or structures	units of charge	per basis unit fee	total charged	development, lots, or structures	units of charge	per basis unit fee	total charged
<b>Total Fees</b>						<b>\$2,042,800.00</b>				<b>\$49,813.00</b>
<b>Total Fees per unit</b>						<b>\$10,214.00</b>				<b>\$12,453.25</b>
<b>Comprehensive Plan</b>		<b>Total</b>				<b>\$3,000.00</b>				<b>\$3,000.00</b>
<b>Comprehensive Plan</b>		<b>Per Unit</b>				<b>\$15.00</b>				<b>\$750.00</b>
Comprehensive Plan	Comprehensive Plan amendment	less than 5 acres	0	0	\$1,500.00	\$0.00	0	0	\$1,500.00	\$0.00
Comprehensive Plan	Comprehensive Plan amendment	5+ to 25 acres	0	0	\$2,000.00	\$0.00	0	0	\$2,000.00	\$0.00
Comprehensive Plan	Comprehensive Plan amendment	25+ to 50 acres	1	1	\$3,000.00	\$3,000.00	1	1	\$3,000.00	\$3,000.00
Comprehensive Plan	Comprehensive Plan amendment	50+ acres	0	0	\$4,000.00	\$0.00	0	0	\$4,000.00	\$0.00
Comprehensive Plan	Comprehensive Plan amendment	per acre greater than 50	0	0	\$10.00	\$0.00	0	0	\$10.00	\$0.00
<b>Zoning</b>		<b>Total</b>				<b>\$4,950.00</b>				<b>\$1,050.00</b>
<b>Zoning</b>		<b>Per Unit</b>				<b>\$24.75</b>				<b>\$262.50</b>
Zoning	Zoning change application	development	1	1	\$950.00	\$950.00	1	1	\$950.00	\$950.00
Zoning	Zoning change application	per acre	1	40	\$100.00	\$4,000.00	1	1	\$100.00	\$100.00
<b>Subdivision</b>		<b>Total</b>				<b>\$18,200.00</b>				<b>\$3,500.00</b>
<b>Subdivision</b>		<b>Per Unit</b>				<b>\$91.00</b>				<b>\$875.00</b>
Subdivision	Preliminary Plan	development per lot or acre	1	1	\$2,000.00	\$2,000.00	1	1	\$2,000.00	\$2,000.00
Subdivision	Preliminary Plan	whichever greater	200	1	\$50.00	\$10,000.00	4	1	\$50.00	\$200.00
Subdivision	Final Plat	development per lot or acre	1	1	\$1,200.00	\$1,200.00	1	1	\$1,200.00	\$1,200.00
Subdivision	Final Plat	whichever greater	200	1	\$25.00	\$5,000.00	4	1	\$25.00	\$100.00
<b>Dedication Fee in Lieu</b>		<b>Total</b>				<b>\$360,000.00</b>				<b>\$7,200.00</b>
<b>Dedication Fee in Lieu</b>		<b>Per Unit</b>				<b>\$1,800.00</b>				<b>\$1,800.00</b>
Dedication Fee in Lieu	Land Dedication	per residential unit	200	1	\$800.00	\$160,000.00	4	1	\$800.00	\$3,200.00
Dedication Fee in Lieu	parkland Development	per residential unit	200	1	\$1,000.00	\$200,000.00	4	1	\$1,000.00	\$4,000.00
<b>Site Plan</b>		<b>Total</b>				<b>\$408,650.00</b>				<b>\$10,103.00</b>
<b>Site Plan</b>		<b>Per Unit</b>				<b>\$2,043.25</b>				<b>\$2,525.75</b>
Site plan	Construction Infrastructure Inspection	development per \$ of site	1	1	\$500.00	\$500.00	1	1	\$500.00	\$500.00
Site plan	Construction Infrastructure Inspection	public infrastructure construction costs	1	6E+06	\$0.04	\$210,000.00	1	#####	\$0.04	\$4,200.00
Site plan	Development review	development	1	1	\$500.00	\$500.00	1	1	\$500.00	\$500.00



Site plan	Development review	per sf of impervious cover	1	2E+05	\$0.04	\$7,650.00	1	3,825	\$0.04	\$153.00
Tree Protection	Tree Removal Permit	development per tree of 8 to 20 caliper inches	1	0	\$75.00	\$0.00	1	0	\$75.00	\$0.00
Tree Protection	Tree Mitigation Fee	per tree of 20 to 30 caliper inches	40	10	\$200.00	\$80,000.00	1	10	\$200.00	\$2,000.00
Tree Protection	Tree Mitigation Fee	per tree of 30 plus caliper inches	40	5	\$350.00	\$70,000.00	1	5	\$350.00	\$1,750.00
Tree Protection	Tree Mitigation Fee	per tree of 30 plus caliper inches	40	2	\$500.00	\$40,000.00	1	2	\$500.00	\$1,000.00
<b>Permit</b>		<b>Total</b>				<b>\$75,000.00</b>				<b>\$1,500.00</b>
<b>Permit</b>		<b>Per Unit</b>				<b>\$375.00</b>				<b>\$375.00</b>
Permit	plan review	per structure	200	1	\$250.00	\$50,000.00	4	1	\$250.00	\$1,000.00
Permit	Inspection	per structure	200	1	\$125.00	\$25,000.00	4	1	\$125.00	\$500.00
<b>Tap fee</b>		<b>Total</b>				<b>\$229,400.00</b>				<b>\$4,588.00</b>
<b>Tap fee</b>		<b>Per Unit</b>				<b>\$1,147.00</b>				<b>\$1,147.00</b>
Tap fee	water	5/8 meter	200	1	\$400.00	\$80,000.00	4	1	\$400.00	\$1,600.00
tap fee	wastewater	4 inch	200	1	\$450.00	\$90,000.00	4	1	\$450.00	\$1,800.00
tap fee	water meter	5/8 meter	200	1	\$297.00	\$59,400.00	4	1	\$297.00	\$1,188.00
<b>impact fee</b>		<b>Total</b>				<b>\$943,600.00</b>				<b>\$18,872.00</b>
<b>impact fee</b>		<b>Per Unit</b>				<b>\$4,718.00</b>				<b>\$4,718.00</b>
impact fee	water	5/8 meter	200	1	\$2,187.00	\$437,400.00	4	1	\$2,187.00	\$8,748.00
impact fee	sewer	5/8 meter	200	1	\$2,531.00	\$506,200.00	4	1	\$2,531.00	\$10,124.00



## City of Leander – Fee Set

Fee Category	Fee name	Fee basis	Development Model 1				Development Model 2			
			development, lots, or structures	units of charge	per basis unit fee	total charged	development, lots, or structures	units of charge	per basis unit fee	total charged
<b>Total Fees</b>						<b>\$2,097,697.50</b>				<b>\$55,545.00</b>
<b>Total Fees per unit</b>						<b>\$10,488.49</b>				<b>\$13,886.25</b>
<b>Comprehensive Plan</b>		<b>Total</b>				<b>\$1,195.00</b>				<b>\$1,195.00</b>
<b>Comprehensive Plan</b>		<b>Per Unit</b>				<b>\$5.98</b>				<b>\$298.75</b>
Comprehensive Plan	Comprehensive Plan Amendment	development	1	1	\$575.00	\$575.00	1	1	\$575.00	\$575.00
Comprehensive Plan	Comprehensive Plan owner notification fee	per owner	1	100	\$5.00	\$500.00	1	100	\$5.00	\$500.00
Comprehensive Plan	Comprehensive Plan signage fee	per sign	1	4	\$30.00	\$120.00	1	4	\$30.00	\$120.00
<b>Zoning</b>		<b>Total</b>				<b>\$2,495.00</b>				<b>\$1,325.00</b>
<b>Zoning</b>		<b>Per Unit</b>				<b>\$12.48</b>				<b>\$331.25</b>
Zoning	Zoning change application	development	1	1	\$675.00	\$675.00	1	1	\$675.00	\$675.00
Zoning	Zoning change application	per acre	1	40	\$30.00	\$1,200.00	1	1	\$30.00	\$30.00
Zoning	Zoning change owner notification	per owner	1	100	\$5.00	\$500.00	1	100	\$5.00	\$500.00
Zoning	Zoning change signage fee	per sign (300' max separation)	1	4	\$30.00	\$120.00	1	4	\$30.00	\$120.00
<b>Subdivision</b>		<b>Total</b>				<b>\$89,170.00</b>				<b>\$5,674.00</b>
<b>Subdivision</b>		<b>Per Unit</b>				<b>\$445.85</b>				<b>\$1,418.50</b>
Subdivision	Concept Plan	development per lot or acre whichever greater	1	1	\$700.00	\$700.00	1	1	\$700.00	\$700.00
Subdivision	Concept Plan	per owner	200	1	\$6.00	\$1,200.00	4	1	\$6.00	\$24.00
Subdivision	Concept Plan	per owner	1	100	\$5.00	\$500.00	1	100	\$5.00	\$500.00
Subdivision	Concept Plan notification Sign	per sign (300' max separation)	1	4	\$30.00	\$120.00	1	4	\$30.00	\$120.00
Subdivision	Concept Plan	per resubmittal	0	0	\$1,000.00	\$0.00	0	0	\$1,000.00	\$0.00
Subdivision	Preliminary Plat	development per lot or acre whichever greater	1	1	\$1,450.00	\$1,450.00	1	1	\$1,450.00	\$1,450.00
Subdivision	Preliminary Plat	per owner	200	1	\$50.00	\$10,000.00	4	1	\$50.00	\$200.00
Subdivision	Preliminary Plat	LUE	200	1	\$350.00	\$70,000.00	4	1	\$350.00	\$1,400.00
Subdivision	Preliminary Plat	per resubmittal	0	0	\$1,000.00	\$0.00	0	0	\$1,000.00	\$0.00
Subdivision	Final Plat	development per lot or acre whichever greater	1	1	\$1,200.00	\$1,200.00	1	1	\$1,200.00	\$1,200.00
Subdivision	Final Plat	per owner	200	1	\$20.00	\$4,000.00	4	1	\$20.00	\$80.00
Subdivision	Final Plat	per resubmittal	0	0	\$1,000.00	\$0.00	0	0	\$1,000.00	\$0.00
<b>Dedication Fee in Lieu</b>		<b>Total</b>				<b>\$290,000.00</b>				<b>\$5,800.00</b>
<b>Dedication Fee in Lieu</b>		<b>Per Unit</b>				<b>\$1,450.00</b>				<b>\$1,450.00</b>
Dedication Fee in Lieu	Parkland Dedication	per single family unit	200	1	\$1,050.00	\$210,000.00	4	1	\$1,050.00	\$4,200.00
Dedication fee in Lieu	Parkland Development	per single family unit	200	1	\$400.00	\$80,000.00	4	1	\$400.00	\$1,600.00

<b>Site Plan</b>		<b>Total</b>				<b>\$11,037.50</b>				<b>\$7,475.00</b>
<b>Site Plan</b>		<b>Per Unit</b>				<b>\$55.19</b>				<b>\$1,868.75</b>
Site plan	Construction Infrastructure Inspection	development per \$ of site public infrastructure construction costs	1	1			1	1	\$1,475.00	\$1,475.00
Site plan	Construction Infrastructure Inspection	development per sf of impervious cover	1	6E+06			1	#####	\$0.05	\$6,000.00
Site plan	Development review	development per sf of impervious cover	1	1	\$1,475.00	\$1,475.00	1	1		
Site plan	Development review		1	2E+05	\$0.05	\$9,562.50	1	3,825		
<b>Permit</b>		<b>Total</b>				<b>\$190,000.00</b>				<b>\$3,800.00</b>
<b>Permit</b>		<b>Per Unit</b>				<b>\$950.00</b>				<b>\$950.00</b>
Permit	plan review	per structure first 3000 sf per structure sf greater than 3000	200	1	\$50.00	\$10,000.00	4	1	\$50.00	\$200.00
Permit	plan review	per structure per sf	0	0	\$0.05	\$0.00	0	0	\$0.05	\$0.00
Permit	Building Permit	per structure per sf	200	1500	\$0.15	\$45,000.00	4	1,500	\$0.15	\$900.00
Permit	Mechanical Permit	per structure per sf	200	1500	\$0.15	\$45,000.00	4	1,500	\$0.15	\$900.00
Permit	Plumbing Permit	per structure per sf	200	1500	\$0.15	\$45,000.00	4	1,500	\$0.15	\$900.00
Permit	Electrical Permit	per structure per sf	200	1500	\$0.15	\$45,000.00	4	1,500	\$0.15	\$900.00
<b>Tap fee</b>		<b>Total</b>				<b>\$88,000.00</b>				<b>\$1,760.00</b>
<b>Tap fee</b>		<b>Per Unit</b>				<b>\$440.00</b>				<b>\$440.00</b>
Tap fee	water	5/8 meter	200	1	\$340.00	\$68,000.00	4	1	\$340.00	\$1,360.00
tap fee	wastewater	connection	200	1	\$100.00	\$20,000.00	4	1	\$100.00	\$400.00
<b>impact fee</b>		<b>Total</b>				<b>\$1,425,800.00</b>				<b>\$28,516.00</b>
<b>impact fee</b>		<b>Per Unit</b>				<b>\$7,129.00</b>				<b>\$7,129.00</b>
impact fee	water	5/8 meter	200	1	\$4,309.00	\$861,800.00	4	1	\$4,309.00	\$17,236.00
impact fee	sewer	5/8 meter	200	1	\$2,820.00	\$564,000.00	4	1	\$2,820.00	\$11,280.00



TEXAS A&M UNIVERSITY

# Texas Real Estate Research Center

DIVISION OF ACADEMIC AND STRATEGIC COLLABORATIONS

Texas A&M University  
2115 TAMU  
College Station, TX 77843-2115

<http://recenter.tamu.edu>  
979-845-2031

## EXECUTIVE DIRECTOR

GARY W. MALER

## ADVISORY COMMITTEE

DOUG JENNINGS, CHAIRMAN Fort Worth	DOUG FOSTER, VICE CHAIRMAN Lockhart
TROY ALLEY, JR. DeSoto	BESA MARTIN Boerne
RUSSELL CAIN Port Lavaca	TED NELSON Houston
VICKI FULLERTON The Woodlands	BECKY VAJDAK Temple
PATRICK GEDDES Dallas	BARBARA RUSSELL, EX-OFFICIO Denton



**LinkedIn**  
[linkedin.com/company/recentertx](https://www.linkedin.com/company/recentertx)



**Instagram**  
[instagram.com/recentertx](https://www.instagram.com/recentertx)



**YouTube**  
[YouTube.com/realestatercenter](https://www.youtube.com/realestatercenter)



**Facebook**  
[facebook.com/recentertx](https://www.facebook.com/recentertx)



**Twitter**  
[twitter.com/recentertx](https://www.twitter.com/recentertx)